

Catalog No.	Height	Width	Finish	Product Code
SCE-FS1212	12.00	12.00	SCE-05 White	P2
SCE-FS1818	18.00	18.00	SCE-05 White	P2
SCE-FS2424	24.00	24.00	SCE-05 White	P2
SCE-FS1212-09	12.00	12.00	ANSI-61 Gray	P2
SCE-FS1818-09	18.00	18.00	ANSI-61 Gray	P2
SCE-FS2424-09	24.00	24.00	ANSI-61 Gray	P2

Stainless Steel

SCE-FS1212SS	12.00	12.00	#4 Brushed Finish	P2
SCE-FS1818SS	18.00	18.00	#4 Brushed Finish	P2
SCE-FS2424SS	24.00	24.00	#4 Brushed Finish	P2



Catalog No.	Description	Depth	Width	Product Code
SCE-18SBASE	Pedestal Base	18.00	18.00	P2
SCE-24SBASE	Pedestal Base	24.00	24.00	P2
SCE-44CCOL	Straight Column	4.00	4.00	P2
SCE-44PBCOL	Angled Column	4.00	4.00	P2
SCE-66CCOL	Straight Column	6.00	6.00	P2
SCE-66PBCOL	Angled Column	6.00	6.00	P2

Stainless Steel

SCE-18SBASESS	Pedestal Base, Stainless Steel	18.00	18.00	P2
SCE-24SBASESS	Pedestal Base, Stainless Steel	24.00	24.00	P2
SCE-44CCOLSS	Straight Column, Stainless Steel	4.00	4.00	P2
SCE-44PBCOLSS	Angled Column, Stainless Steel	4.00	4.00	P2
SCE-66CCOLSS	Straight Column, Stainless Steel	6.00	6.00	P2
SCE-66PBCOLSS	Angled Column, Stainless Steel	6.00	6.00	P2

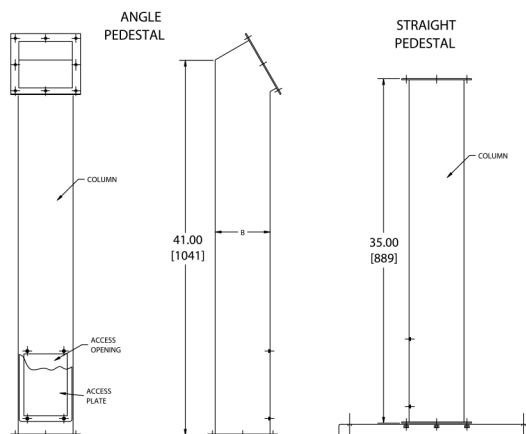
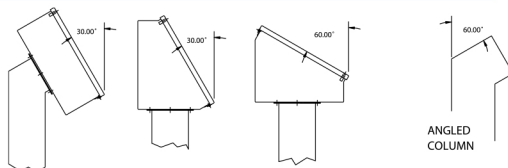

GENERAL ACCESSORIES

Folding Shelf

Folding shelves can be installed on the inside or outside of large enclosures. They are designed to support test equipment and programmers. Locks in the horizontal position. When not in use, shelf can be folded down. Made of heavy gauge steel and powder coated. "SS" parts are stainless steel Type 304 with #4 brush finish. For installation information, consult our Installation Manual at www.saginawcontrol.com.

Provided with UL Recognized sealing washer to maintain Environmental Rating of the enclosure.

Accessory Columns and Bases

Designed to allow enclosures to be floor mounted. Columns can be mounted to either size base. Columns have flanges at each end and a gasketed access plate. Bases are to be bolted to the floor. Gasket and mounting hardware included. For technical information, consult the Installation Manual at www.saginawcontrol.com. Pedestals and bases are ANSI-61 gray powder coated. "SS" parts are stainless steel Type 304 with #4 brush finish.