

**MOUNTING DATA**

For unit or row installation. Surface or stem mounting.<sup>1</sup>

UNIT INSTALLATION — Minimum of two hangers required.

ROW INSTALLATION — One hanger per fixture plus one per row required.

**DIMENSIONS**

A = 1/4 x 1/2 (64 x 13) Oval Hole

C = 7/8 (22) Dia. K.O.

D = 11/16 (17) Dia. K.O.

E = 2 (51) Dia. K.O.

F = 7/16 (111) Dia. K.O.

All dimensions are inches (millimeters).

Specifications subject to change without notice.

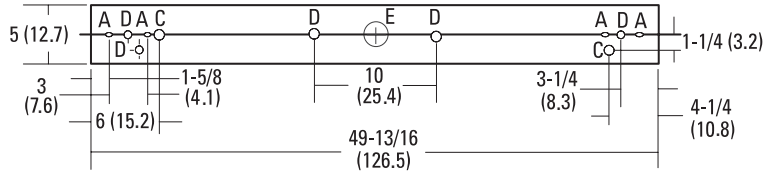
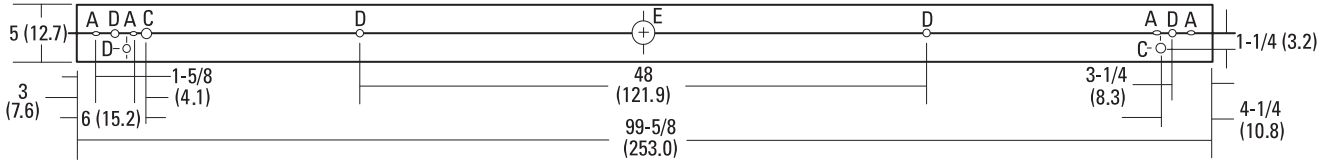
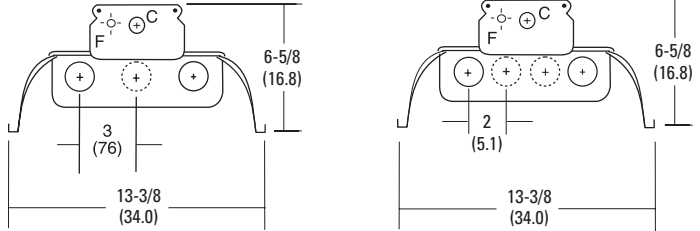
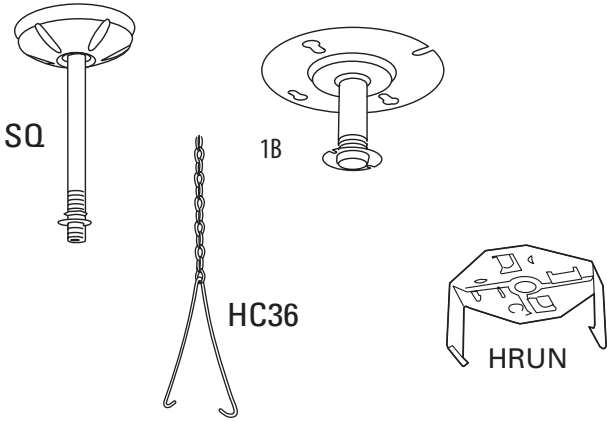

Energy (Calculated in accordance with NEMA standard LE-5)					
LER.FW	ANNUAL ENERGY COST*	LAMP DESCRIPTION	LAMP LUMENS	BALLST FACTOR	WATTS
74	\$3.24	(2) F32T8	2800	.88	60

\*Calculated in accordance with NEMA Standards LE-5.

**PHOTOMETRICS**

Calculated using the zonal cavity method in accordance with IESNA LM41 procedure. Floor reflectances are 20%. Lamp configurations shown are typical. All data based on 25°C.

Full photometric data on these and other configurations available upon request.

AF 2 32

Report ITL 5711

S/MH 1.4

**Coefficient of Utilization**

Ceiling	80%			70%			50%		
	70%	50%	30%	70%	50%	30%	70%	50%	30%
1	94	90	86	90	86	83	79	76	74
2	86	79	73	82	75	70	69	65	61
3	78	69	62	74	66	60	61	56	52
4	72	61	54	68	59	52	54	48	44
5	65	54	46	62	52	44	48	41	37
10	43	31	24	41	30	23	28	22	18

**Zonal Lumens Summary**

Zone	Lumens	%Lamp	%Fixture
0-30	998	17.2	19.0
0-40	1677	28.9	31.9
0-60	3126	53.9	59.6
0-90	4074	70.2	77.6
90-180	1175	20.3	22.4
0-180	5249	90.5	100.0