

EMT

Steel Compression Space Saver



Features

- Eliminates need to purchase insulated throat steel fittings or conduit bushings in 1/2", 3/4" & 1" trade sizes
- Affords additional wiring room in junction boxes (see illustrations)
- Excellent for low voltage applications
- Heavy steel walls
- Concrete tight when taped
- RoHS compliant

Standard Materials

Steel

Standard Finish

Zinc plated

Applicable Third Party Standards

- UL Standard: 514B
- Fed. Spec. W-F-408E
- NEMA: FB-1

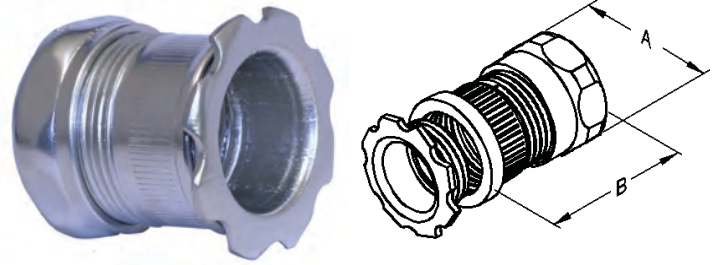

CSSCKON

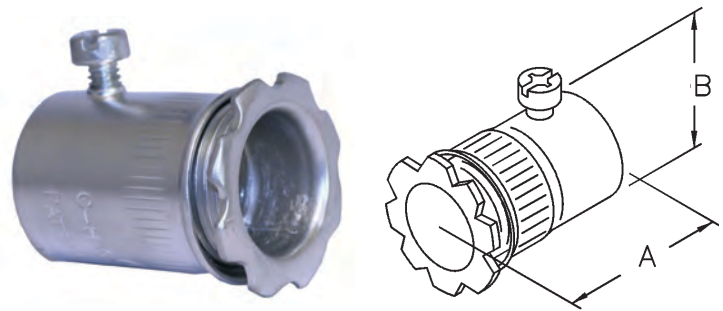

SSCKON

CATALOG NUMBER	TRADE SIZE	KO SIZE	DIM A	DIM B	MASTER PACK	WEIGHT PER C
CSSC-50KON	1/2"	1/2"	1.250	1.125	50	10.7
CSSC-75KON	3/4"	3/4"	1.438	1.375	25	15.6
CSSC-100KON	1"	1"	1.875	1.688	25	30.3

CSSC is concrete tight

CATALOG NUMBER	TRADE SIZE	KO SIZE	DIM A	DIM B	MASTER PACK	WEIGHT PER C
SSC50KON	1/2"	1/2"	0.875	1.188	50	7.8
SSC75KON	3/4"	3/4"	1.063	1.500	25	10.9
SSC100KON	1"	1"	1.313	1.625	25	15.5

SSC is concrete tight when taped

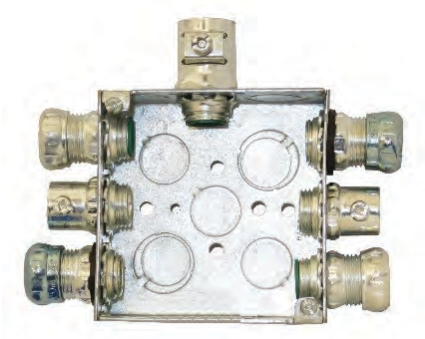

Wiring room using conventional steel connectors

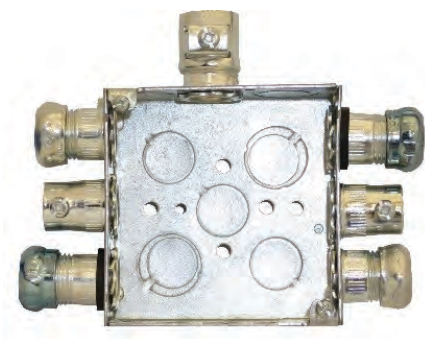

Wiring room using Space Saver Steel connectors