

Product availability : Stock - Normally stocked in distribution facility



Main

Range of product	Harmony XVU
Product or component type	Modular tower light
Accessory / separate part type	Fixing plate
Accessory / separate part category	Mounting and fixing accessory
Component name	XVU
Mounting diameter	2.36 in (60 mm)

Complementary

Mounting support	Wall mounted
Product compatibility	XVUZ02 XVUZ02Q XVUZ03 XVUZ400 XVUZ800 XVUZ05
Material	Aluminium V-0 flame retardant conforming to UL 94
Housing colour	Black
[Us] rated supply voltage	110...240 V AC 24 V AC/DC
Length	0.31 in (8 mm)
Product weight	0.79 lb(US) (0.36 kg)

Environment

Ambient air temperature for storage	-40...158 °F (-40...70 °C)
Ambient air temperature for operation	-13...122 °F (-25...50 °C)
IP degree of protection	IP65
Product certifications	CE CSA UL

Ordering and shipping details

Category	22618 - XVU TOWER LIGHTS
Discount Schedule	XV
GTIN	00785901031192
Nbr. of units in pkg.	1
Package weight(Lbs)	1.0800000000000001
Returnability	Y
Country of origin	ID

Offer Sustainability

Sustainable offer status	Green Premium product
RoHS (date code: YYWW)	Compliant Schneider Electric declaration of conformity
REACH	Reference not containing SVHC above the threshold Reference not containing SVHC above the threshold
Product environmental profile	Available
Product end of life instructions	Available
California proposition 65	WARNING: This product can expose you to chemicals including:
----- Substance 1	Lead and lead compounds, which is known to the State of California to cause cancer and birth defects or other reproductive harm.
----- More information	For more information go to www.p65warnings.ca.gov

Dimensions

Rear View

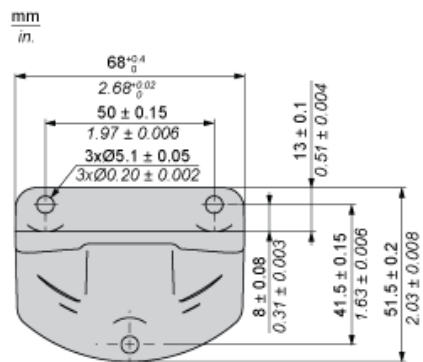

Side View

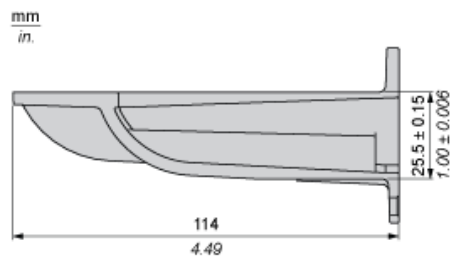

Vertical Support Panel Drillings

