

FIT Series Poke-Thru Device Housing & Base

200-H/BTC

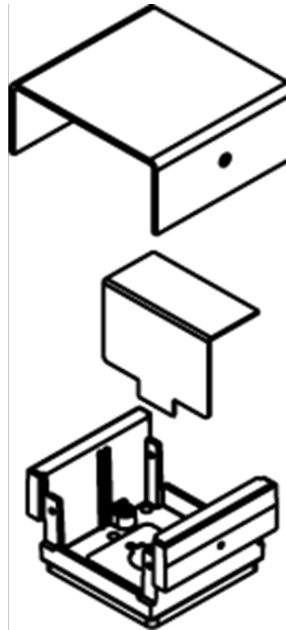

features & benefits

Single width. For 200 Series Service Head. Barrier included (may not be needed on single service applications). Base has a 3/4" trade size knockout for connection fo FIT insert. Also includes scrub water gasket. NOTE: Assembled with scrub water gasket. For use on tile or carpet floors. FIT Series Poke-Thru requires a minimum 2 1/32" [52mm], 2 1/8" [54mm] maximum diameter hole.

specifications

General Info

Product Series: FIT
Type: Multi-Service
Component Type: Device Plates & Accessories

Dimensions

Hole Size: 2"