



Manufacturing to Strict Standards

Parts produced under numbers that begin with AN, MS and NAS were originally designed for aerospace applications, although many are equally suited for industrial applications. Parts produced under numbers that begin with an "S" are UMPCO designed; some are for a specified application. All parts are produced to MIL-I-45208A inspection standards. UMPCO has received many awards throughout the industry for quality and service.

AN-MS-NAS part numbers, which are manufactured under a rigid quality control system, are under the scrutiny of the DEFENSE PROCUREMENT ORGANIZATION (DPRO, formerly DCASD). All are precisely manufactured to the applicable military standard established to ensure the highest quality parts available anywhere. Refer to the applicable part numbers for exact details, or call us at (714) 897-3531.

One - off to Millions



Our modern machining facility specializes in all facets of hardware manufacturing from prototype to production. Our professional staff of engineers can assist in every stage of the manufacturing process from initial drawing through layout, process review, programming, tooling design and ultimately, the finished product.

We expedite prototypes and small quantity orders using hand fed power tools designed and built by UMPCO. These tools make custom runs of small quantities possible from a manufacturer normally geared for volume production.



Our assembly and production are skillfully handled by UMPCO employees who are individually and collectively responsible for the parts they produce. Every employee is his or her own most critical inspector. All parts are inspected and re-checked prior to shipment to ensure that UMPCO produces only the finest clamps, clips, brackets and light stampings.

Commercial Support Clamps



General industrial and automotive applications usually require neoprene cushioned S325 and S370 support clamps. If you require a support clamp with additional width or larger mounting holes, consider our product numbers S219, S332, S463, S464, S465, S466, S467 and S468. If you have an application requiring high temperature cushion materials, see S500, S634 or call our friendly sales associates for personal assistance at (714) 897-3531.



- Single Tube Cushioned Loop Clamps
- Single Tube Plain Loop Clamps
- Cushioned Clamps with Tanglock
- Cushioned "U" Type Support Clamp
- Cushioned Loop Clamps
- Saddle Type
- Center Mount Loop Clamps
- Two Bolt Loop Clamps
- Rectangular Cushioned Loop Clamp



	<p>S228 Cushioned Loop Clamp for 5/16" Mounting Bolt</p> <ul style="list-style-type: none"> • Material: Aluminum, 302/321 CRES, Steel • Cushion: EPDM, Neoprene, Silicone • Hole: .344 x .438 Width .625
	<p>S230 Cushioned Loop Clamp for 1/4" Mounting Bolt</p> <ul style="list-style-type: none"> • Material: Aluminum, 302/316/321 CRES, Steel • Cushion: EPDM, Neoprene, Teflon Skydrol Resistant, Conductive, Silicone. - Wedge Style Available • Hole: .281 x .375. Width: .500
	<p>S250 Cushioned Loop Clamp</p> <ul style="list-style-type: none"> • Material: Aluminum, CRES, 4130 CMS, Steel • Cushion: EPDM, Neoprene, Silicone - Wedge Style Available • Hole: .204. Width: .500
	<p>S325 Cushioned Loop Clamp</p> <ul style="list-style-type: none"> • Material: Aluminum, 302/321 CRES, 201,316 & 430 CRES, Steel • Cushion: EPDM, Neoprene, Teflon, Silicone - Wedge Style Available • Hole: .265. Width: .500
	<p>S332 Cushioned Loop Clamp</p> <ul style="list-style-type: none"> • Material: Aluminum, 302/321 CRES, Steel • Cushion: EPDM, Neoprene, Silicone, Teflon • Hole: .531 x .625 Width .750
	<p>S340 Cushioned Loop Clamp</p> <ul style="list-style-type: none"> • Material: Aluminum, 302/321 CRES, 316 CRES, Steel • Cushion: EPDM, Neoprene, Silicone, Teflon • Hole: .406 x .500 Width .750
	<p>S342 Cushioned Loop Clamp, Commercial</p> <ul style="list-style-type: none"> • Material: Aluminum, Steel, 302/321/316 CRES, Steel • Cushion: Neoprene, EPDM, Silicone, Nitrile, Teflon • Hole: .281 x .375
	<p>S344 Cushioned Loop Clamps for Two Tubes of Equal Diameter</p> <ul style="list-style-type: none"> • Material: Aluminum, 302/321 CRES, Steel • Cushion: EPDM, Neoprene, Silicone • Hole: .406 x .500 Width .750

DASH NO. RANGE	"D" DIA. RANGE	"E" DIMENSION		"G" GAP	"R" RADIUS	"T" GAUGE	
		ALUMINUM	STEEL			ALUM.	STEEL
-2	1/8"	"D"/2 + .395	"D"/2 + .395	.062/.078	.062	.032	.032
-3 THRU -8	3/16" TO 1/2"	"D"/2 + .405	"D"/2 + .405				
-9 THRU -12	9/16" TO 3/4"	"D"/2 + .471	"D"/2 + .468	.109	.050		
-13 THRU -17	13/16" TO 1-1/16"		"D"/2 + .452				
-18 THRU -30	1-1/8" TO 1-7/8"	"D"/2 + .500	"D"/2 + .468	.094/.125	.125	.062	
-31 THRU -96	1-15/16" TO 6"		"D"/2 + .476				.125/.156

MATERIAL & FINISH CODES:

METAL: "NO CODE" 1008/1020 LOW CARBON STEEL PER ASTM A 1008, ASTM A 109, QQ-S-698
 FINISH: ZINC PLATE BRIGHT PER ASTM B 633, Fe/Zn 13, TY. III ①
 "D" 2024-T42 ALUMINUM ALLOY PER AMS-QQ-A-250/5
 "DK" 5052-H32 1/4 HARD ALUMINUM ALLOY PER AMS-QQ-A-250/8 ③
 "DL" 6061-T6 ALUMINUM ALLOY PER AMS-QQ-A-250/11
 FINISH: NONE
 "C" 316 STAINLESS STEEL PER AMS 5524
 "CV" 201 STAINLESS STEEL PER ASTM A 666
 "SS" 304/321 STAINLESS STEEL PER AMS 5513/AMS 5510
 "SV" 430 STAINLESS STEEL PER AMS 5503
 FINISH: NONE

CUSHION: "F" NITRILE BUTADIENE PER AMS 3215
 COLOR: YELLOW, SHAPES: A, WEDGE AVAILABLE
 "G" GENERAL PURPOSE EPDM PER SAE J200 M3 BA 710 C12
 COLOR: BLACK, SHAPES: A & B
 "EL" ETHYLENE PROPYLENE PER SAE J200 M3 BA 710 C12
 COLOR: WHITE, SHAPES: A & B
 "H" GENERAL PURPOSE SILICONE PER AMS 3303
 WITH 100 PSI MIN. TEAR
 COLOR: RED/ORANGE, SHAPES: A & B
 "HL" GENERAL PURPOSE SILICONE PER AMS 3303 & MIL-C-8603
 WITH 100 PSI MIN. TEAR
 COLOR: NATURAL WHITE, SHAPES: A, WEDGE AVAILABLE

EXAMPLE OF PART CALLOUT:

1" DIA., ALUM. CLAMP W/WEDGED TEFLON

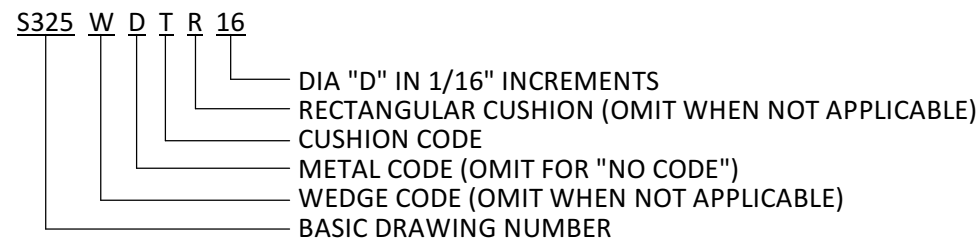

NOTES:

- ① OPTIONAL FINISH: CADMIUM PLATE BRIGHT PER AMS-QQ-P-416, TY. I, CL. 2
- ② FOR SHAPE (B) STYLE CUSHIONS (BOX), PARTS SHALL BE PACKAGE IDENTIFIED IN MULTIPLES OF 10, NOT TO EXCEED 100.
- ③ CAUSTIC ETCH TO CLEAN AS NEEDED.
- 4) CLAMPS FURNISHED IN THE NORMAL OPEN (SPRINGBACK) CONDITION.
- 5) INSPECT PER MIL-C-8603 CLOSURE TEST.



S325

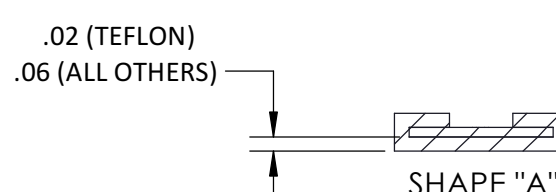
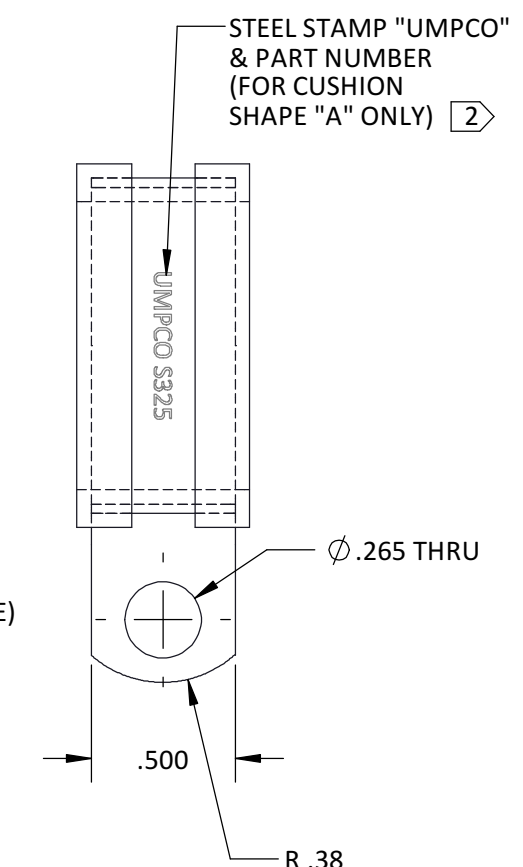
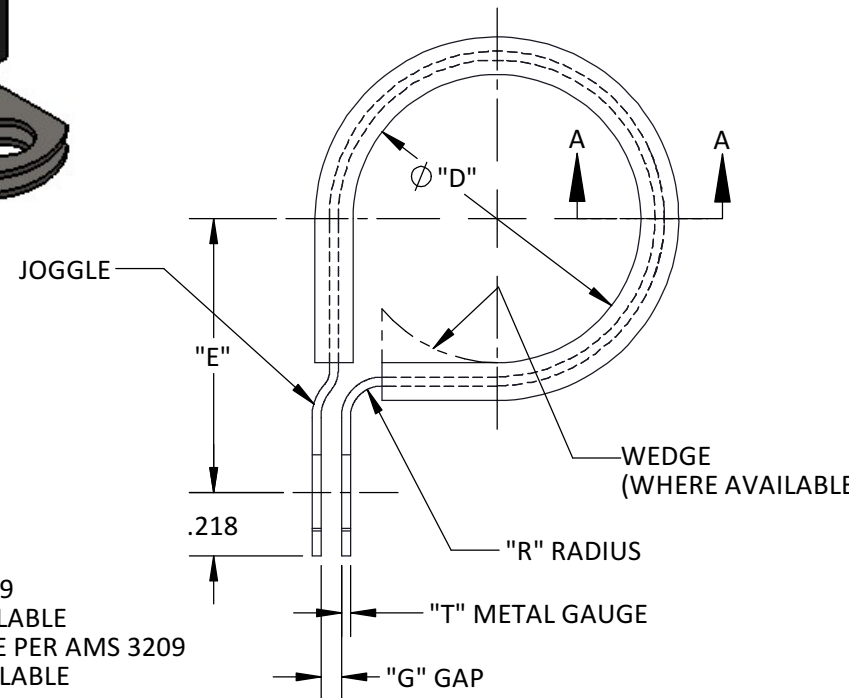

SECTION A-A (CUSHION STYLE)

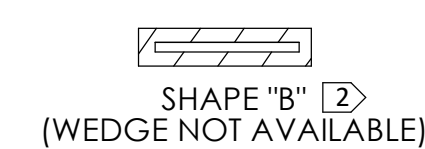

SHEET 1 OF 1

REFERENCES:								
LIMITS ON DIMENSIONS UNLESS OTHERWISE SPECIFIED:	ANGULAR:	X	± 5°			FSCM/CAGE CODE No. 18076		
	DECIMAL:	.XX	± .03			KEL	LJS	KWE
GENERAL MACHINE FINISHES EXCEPT AS NOTED:		.XXX	± .015	7100 LAMPSON AVE. P.O. BOX 5158 GARDEN GROVE, CA. 92846		09/30/55	07/24/06	07/24/06
	INTERPRET GEOMETRIC TOLERANCING PER: ASME-Y14.5M	<small>PROPRIETARY AND CONFIDENTIAL</small> <small>THE INFORMATION CONTAINED IN THIS DRAWING IS THE SOLE PROPERTY OF UMPCO, INC. ANY REPRODUCTION IN PART OR AS A WHOLE WITHOUT THE WRITTEN PERMISSION OF UMPCO, INC IS PROHIBITED.</small>		CLAMP, LOOP, SUPPORT, CUSHIONED, 1/4" MOUNTING HOLE, LIGHT/MEDIUM DUTY		DRAWN	CHECKED	ENGR
REMOVE ALL BURRS AND BREAK SHARP EDGES .010 MAX	ACT. WGHT.	-		PART AND/OR ASSEMBLY DESCRIPTION	SIZE	SCALE: NONE		
	CALC. WGHT.	-			B	S325		
						PRINT NUMBER		



BULLETIN 100
UMP-MT
METAL MATERIALS

CODE	MATERIALS	SUFFIX	SPECIFICATION	TENSILE KSI	YIELD KSI	HARDNESS	ELONGATION	TEMP. RANGE
D	2024-T42 ALUMINUM CLAD	ALU-001	AMS-QQ-A-250/5	57000 KSI	34000 KSI	57 HRB MIN	15%	-65°F to +250°F
DK	5052-H32 1/4 HARD ALUMINUM BARE	ALU-002	AMS-QQ-A-250/8, ASTM B209	34000 KSI	28000 KSI		12%	
DL	6061- T6 ALUMINUM BARE	ALU-003	AMS 4025	42000 KSI	35000 KSI	95 HRB	10%	
	2024-T42 ALUMINUM BARE	ALU-004	AMS-QQ-A-250/4	62000 KSI	38000 KSI		15%	
	2024-T851 ALUMINUM BARE	ALU-005	AMS-QQ-A-250/4	67000 KSI	58000 KSI		5%	
	2024-T4 ALUMINUM CLAD	ALU-006	AMS-QQ-A-250/5	58000 KSI	36000 KSI	57 HRB MIN	15%	
NO-CODE	1008/1020 LOW CARBON STEEL	CRS-001	ASTM A 1008, ASTM A109 QQ-S-698	48000	25000	65 HRB MAX	32%	-65°F to +400°F
	1065/1-85 SPRING STEEL	CRS-002	A-A-51142					
	1074/1095 SPRING STEEL	CRS-003	QQ-S-700, AMS 5120, ASTM A 682, ASTM A 684					
C	302/304 STAINLESS STEEL	STA-001	AMS 5516, AMS 5513, ASTM A 167	75000	36000	92 HRB	40%	-320°F to +1300°F
	304 1/4 HARD STAINLESS STEEL	STA-002	AMS 5910	125000	75000	25 HRC	12%	
	301 FULL HARD STAINLESS STEEL	STA-003	AMS 5519	185000	140000	41 HRC	9%	
	316 STAINLESS STEEL	STA-004	AMS 5524	75000	30000	95 HRB MAX	40%	-320°F to +1600°F
SS	321 STAINLESS STEEL	STA-005	AMS 5510	70000	25000	95 HRB MAX	40%	-320°F to +1500°F
	321 1/8 HARD STAINLESS STEEL	STA-006						
	347 STAINLESS STEEL	STA-007	AMS 5512	100000	30000	92 HRB MAX	40%	
CS	4130 CMS ALLOY	STA-008	MIL-S-18729, AMS 6350	125000	75000	26HRC MIN	8%	
SS	301 1/4 HARD STAINLESS STEEL	STA-009	AMS 5517	125000	75000	25 HRC	25%	
CV	201 STAINLESS STEEL	STA-010	ASTM-A-666	95000	30000	95	40%	
SV	430 STAINLESS STEEL	STA-011	AMS 5503	65000	35000	86	20%	
CV	A286 STAINLESS STEEL	STA-012	AMS 5525	105000		90 HRB MAX	25%	
P	17-7 PH STAINLESS STEEL	177-001	AMS 5528	150000		34-39 HRC	6%	-320°F to +1900°F
	#625 INCONEL	INC-001	AMS 5599	120000	60000		30%	To +2000°F

REVISION: L

SPECIFICATION NO: UMP-MT