

Inductive Rectangular Sensors

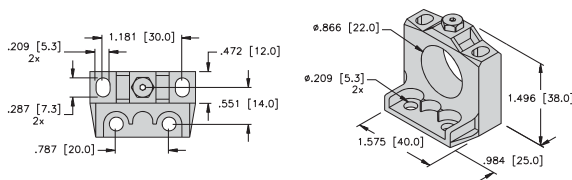

| Housing Style - Rectangular | Part Number | ID Number | Features | Embeddable | Sensing Range (mm) | Output | |
|---|---------------------------------|-----------|---------------------------------|----------------------|--------------------|-----------------|---------------|
| CK40 - Embeddable/Nonembeddable, eurofast® Connector | Bi15U-CK40-AD4X-H1144 | M4280032 | <i>Uprox+</i> | • | 15 | 2-Wire DC | |
| | Ni35U-CK40-AD4X-H1144 | M4280232 | <i>Uprox+</i> | | 35 | | |
| | Bi15-CK40-AD4X-H1141 W/Bs2.1 | M4465090 | | • | 15 | | |
| | Ni20-CK40-AD4X-H1141 W/BS2.1 | M4465290 | | | 20 | | |
| | Bi15U-CK40-AN6X2-H1141 W/BS 2.1 | M1625690 | M1625690 | <i>Uprox</i> | • | 15 | 3-Wire DC NPN |
| | Bi20U-CK40-AN6X2-H1141 W/BS 2.1 | M1627231 | M1627231 | <i>Uprox+</i> | • | 20 | |
| | Bi30U-CK40-AN6X2-H1141 W/BS 4 | M1625820 | M1625820 | <i>Uprox+</i> | • | 30 | |
| | Bi15-CK40-AN6X2-H1141 W/BS 2.1 | M1625190 | M1625190 | | • | 15 | |
| | Ni20-CK40-AN6X2-H1141 W/BS 2.1 | M1625390 | M1625390 | | | 20 | |
| | Ni25U-CK40-AN6X2-H1141 W/BS 2.1 | M1625789 | M1625789 | <i>Uprox</i> | | 25 | |
| | Ni35U-CK40-AN6X2-H1141 W/BS 4 | M1625810 | M1625810 | <i>Uprox</i> | | 35 | |
| | Ni50U-CK40-AN6X2-H1141 W/BS 4 | M1625823 | M1625823 | <i>Uprox+</i> | | 50 | |
| | Bi15U-CK40-AP6X2-H1141 W/BS 2.1 | M1625689 | M1625689 | <i>Uprox</i> | • | 15 | 3-Wire DC PNP |
| | Bi20U-CK40-AP6X2-H1141 W/BS 2.1 | M1627288 | M1627288 | <i>Uprox+</i> | • | 20 | |
| | Bi30U-CK40-AP6X2-H1141 W/BS 4 | M1625829 | M1625829 | <i>Uprox+</i> | • | 30 | |
| | Bi15-CK40-AP6X2-H1141 W/BS 2.1 | M1625090 | M1625090 | | • | 15 | |
| | Ni20-CK40-AP6X2-H1141 W/BS 2.1 | M1625290 | M1625290 | | | 20 | |
| | Ni25U-CK40-AP6X2-H1141 W/BS 2.1 | M1625790 | M1625790 | <i>Uprox</i> | | 25 | |
| | Ni35U-CK40-AP6X2-H1141 W/BS 4 | M1625800 | M1625800 | <i>Uprox</i> | | 35 | |
| | Bi15-CK40-VN4X2-H1141 W/BS 2.1 | M1550190 | M1550190 | <i>Comp. Outputs</i> | • | 15 | 4-Wire DC NPN |
| Ni20-CK40-VN4X2-H1141 W/BS 2.1 | M1550390 | M1550390 | <i>Comp. Outputs</i> | | 20 | | |
| Ni50U-CK40-VN4X2-H1141 W/BS 2.1 | M1625806 | M1625806 | <i>Uprox+</i> /Comp. Outputs | | 50 | | |
| Bi15-CK40-VP4X2-H1141 W/BS 2.1 | M1550091 | M1550091 | <i>Comp. Outputs</i> | • | 15 | 4-Wire DC PNP | |
| Ni20-CK40-VP4X2-H1141 W/BS 2.1 | M1550290 | M1550290 | <i>Comp. Outputs</i> | | 20 | | |
| Ni35U-CK40-VP6X2-H1141 | M1625815 | M1625815 | <i>Uprox</i> | | 35 | | |
| Ni50U-CK40-VP4X2-H1141 W/BS 2.1 | M1538302 | M1538302 | <i>Uprox+</i> Comp. Outputs | | | | |
| Bi15-CK40-Y1X-H1141 | M4065000 | M4065000 | | • | 15 | 2-Wire DC NAMUR | |

Note: 1. BS2.1 is the standard mounting bracket for CK40 unless noted differently.



BS 2.1 Mounting Bracket

For detailed sensor specifications see Section M.
Normally Closed versions available upon request, consult factory.

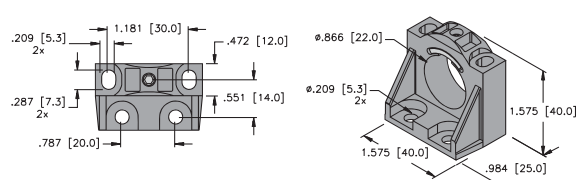

BS 4 Mounting Bracket



| Voltage | Switching Freq. (Hz) | Operating Current (mA) | Operating Temp. (°C) | Protection | Housing | Front Cap/ Face | Power LED | Output LED | Mating Cord, Cable Length /Jacket | Wiring Diagram # | Wiring Diagrams |
|-----------|----------------------|------------------------|----------------------|------------|---------|-----------------|-----------|------------|-----------------------------------|------------------|--|
| 10-65 VDC | 250 | ≤200 | -20 to +70 | IP 68 | PBT | PBT | GN | YE | RK 4.23T-* | 1 | Diagram 1 |
| | 250 | ≤200 | -20 to +70 | IP 68 | PBT | PBT | GN | YE | RK 4.23T-* | 1 | |
| | 150 | ≤100 | -25 to +70 | IP 67 | PBT | PBT | GN | YE | RK 4.2T-* | 2 | |
| | 200 | ≤100 | -25 to +70 | IP 67 | PBT | PBT | GN | YE | RK 4.2T-* | 2 | |
| 10-30 VDC | 250 | ≤200 | -30 to +85 | IP 68 | PBT | PBT | GN | YE | RK 4T-* | 3 | Diagram 2 Diagram 3 Diagram 4 Diagram 5 |
| | 250 | ≤200 | -20 to +70 | IP 68 | PBT | PBT | GN | YE | RK 4T-* | 3 | |
| | 250 | ≤200 | -10 to +60 | IP 68 | PBT | PBT | GN | YE | RK 4T-* | 3 | |
| | 150 | ≤200 | -25 to +70 | IP 67 | PBT | PBT | GN | YE | RK 4T-* | 3 | |
| | 150 | ≤200 | -25 to +70 | IP 67 | PBT | PBT | GN | YE | RK 4T-* | 3 | |
| | 250 | ≤200 | -30 to +85 | IP 68 | PBT | PBT | GN | YE | RK 4T-* | 3 | |
| | 250 | ≤200 | -30 to +85 | IP 67 | PBT | PBT | GN | YE | RK 4T-* | 3 | |
| 10-30 VDC | 250 | ≤200 | -30 to +85 | IP 68 | PBT | PBT | GN | YE | RK 4T-* | 4 | Diagram 6 Diagram 7 |
| | 250 | ≤200 | -20 to +70 | IP 68 | PBT | PBT | GN | YE | RK 4T-* | 4 | |
| | 250 | ≤200 | -10 to +60 | IP 68 | PBT | PBT | GN | YE | RK 4T-* | 4 | |
| | 150 | ≤200 | -25 to +70 | IP 67 | PBT | PBT | GN | YE | RK 4T-* | 4 | |
| | 150 | ≤200 | -25 to +70 | IP 67 | PBT | PBT | GN | YE | RK 4T-* | 4 | |
| | 250 | ≤200 | -30 to +85 | IP 68 | PBT | PBT | GN | YE | RK 4T-* | 4 | |
| | 250 | ≤200 | -30 to +85 | IP 67 | PBT | PBT | GN | YE | RK 4T-* | 4 | |
| 10-65 VDC | 250 | ≤200 | -25 to +70 | IP 67 | PBT | PBT | GN | YE | RK 4.4T-* | 5 | Diagram 6 |
| | 250 | ≤200 | -25 to +70 | IP 67 | PBT | PBT | GN | YE | RK 4.4T-* | 5 | |
| | 250 | ≤200 | -25 to +70 | IP 68 | PBT | PBT | GN | YE | RK 4.4T-* | 5 | |
| 10-65 VDC | 250 | ≤200 | -25 to +70 | IP 67 | PBT | PBT | GN | YE | RK 4.4T-* | 6 | Diagram 6 |
| | 250 | ≤200 | -25 to +70 | IP 67 | PBT | PBT | GN | YE | RK 4.4T-* | 6 | |
| | 250 | ≤200 | -25 to +70 | IP 67 | PBT | PBT | GN | YE | RK 4.4T-* | 6 | |
| | 250 | ≤200 | -25 to +70 | IP 68 | PBT | PBT | GN | YE | RK 4.4T-* | 6 | |
| 5-30 VDC | 150 | Remote | -25 to +70 | IP 67 | PBT | PBT | N/A | YE | RK 4.21T-* | 7 | Diagram 7 |

Rectangular

For material descriptions see page M36.