

### WIRING DIAGRAM

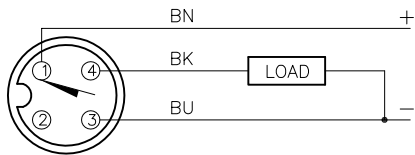

OUTPUT: AP6X2

SHORT-CIRCUIT AND OVERLOAD PROTECTED

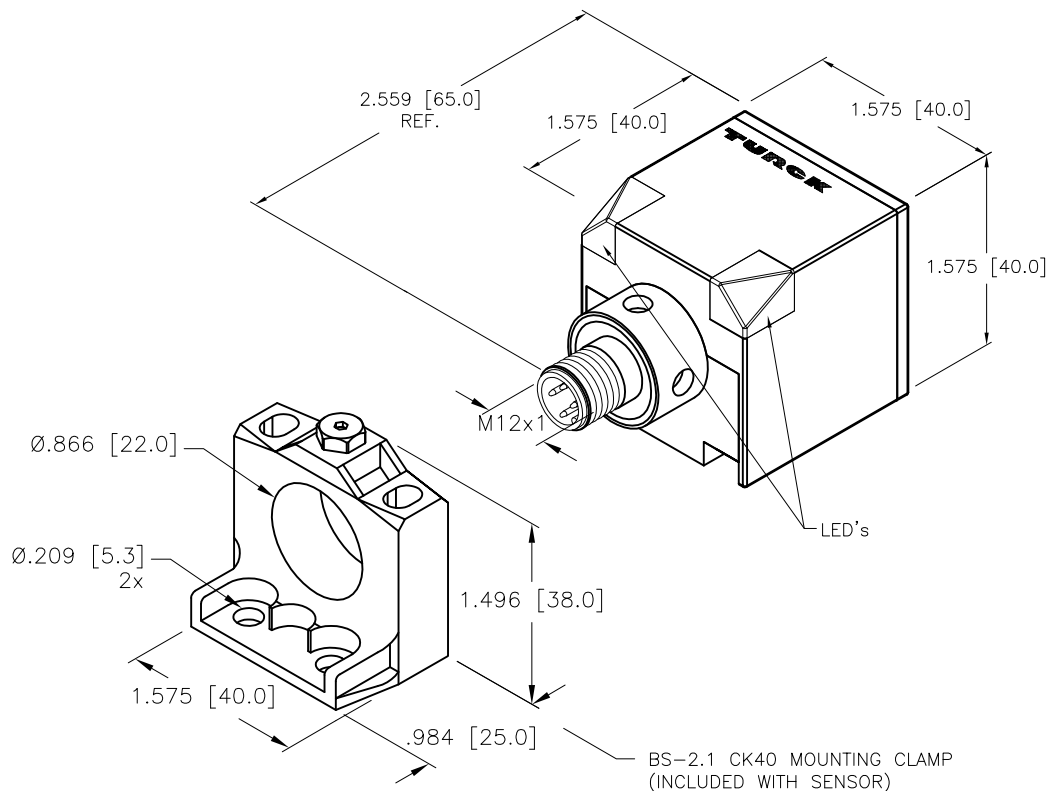

BS-2.1 CK40 MOUNTING CLAMP  
(INCLUDED WITH SENSOR)

### SPECIFICATIONS

RATED OPERATING DISTANCE	15mm = .591"
HYSTERESIS	3-15%
REPEATABILITY	≤ 2% of RATED OPERATING DISTANCE
TEMPERATURE DRIFT	≤ ±10% ≤ ±15%, ≤ 25°C v ≥ +70°C
OPERATING TEMPERATURE	-30°C TO +85°C (-22°F TO +185°F)
OPERATING VOLTAGE	10-30 VDC
RIPPLE	≤ 10%
CONTINUOUS LOAD CURRENT	≤ 200 mA
NO-LOAD CURRENT	≤ 15 mA
RESIDUAL CURRENT	≤ 0.1 mA
MAX. SWITCHING FREQUENCY	≤ 0.25 kHz
RATED INSULATION VOLTAGE	≤ 0.5 kV
OUTPUT FUNCTION	3-WIRE, NORMALLY OPEN, PNP
SHORT-CIRCUIT PROTECTED	YES
MAX. VOLTAGE DROP	≤ 1.8 V
REVERSE POLARITY PROTECTION	INCORPORATED
WIRE-BREAK PROTECTION	INCORPORATED
HOUSING MATERIAL	PLASTIC, PBT-GF20-V0
CONNECTOR	M12x1
VIBRATION	55 Hz, 1 mm AMPLITUDE (IN ALL 3 PLANES)
SHOCK	30 g, 11 ms
PROTECTION	IP68
SUPPLY VOLTAGE INDICATION	LED - 2x GREEN
SWITCHING STATUS INDICATION	LED - YELLOW

SOURCE DRAWING - FOR REFERENCE ONLY

NOTES:

1. SENSING HEAD CAN ROTATE TO 5 DIFFERENT SENSING POSITIONS.
2. UPROX HAS WELD FIELD IMMUNITY, SENSOR IS SUITABLE FOR USE ON RESISTANCE MACHINES.

RELATED DOCUMENTS 1. 2. 3. 4.	3RD ANGLE PROJECTION 	THIS DRAWING IS CONFIDENTIAL AND THE PROPERTY OF TURCK INC. USE OF THIS DOCUMENT WITHOUT WRITTEN PERMISSION IS PROHIBITED.		3000 CAMPUS DRIVE MINNEAPOLIS, MN 55441 1-800-544-7769 (763) 553-7300 (763) 553-0708 fax www.turck.us	
	MATERIAL SEE SPECS	DRFT RJP	DATE 9/24/96	DESCRIPTION BI15U-CK40-AP6X2-H1141 W/BS2.1	
FINISH	ALL DIMENSIONS DISPLAYED ON THIS DRAWING ARE FOR REFERENCE ONLY	APVD	SCALE 1=1.3	IDENTIFICATION NO. 1625689	
CONTACT TURCK FOR MORE INFORMATION		UNIT OF MEASUREMENT <b>INCH [ MILLIMETER ]</b>		REV C	
DO NOT SCALE THIS DRAWING		FILE: 1625689		SHEET 1 OF 1	

C	UPDATE ID NUMBER PER HARMONIZATION PROJECT	CBM	01/02/18	
REV	DESCRIPTION	BY	DATE	ECO NO.