

Conduit bodies and fittings

For use with Schedule 40 and 80 conduit

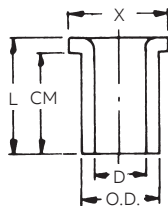

Adapts non-metallic conduit to all electrical enclosures by inserting adapter through knockout and cementing into Carlon couplings.



Box adapters for enclosures

Cat. No.	Size (in.)	Std. Ctn.	Min. D (in.)	OD (in.) Typical	Max. X (in.)	CM (in.) Typical	L (in.) Typical
E996D	1/2	100	.662	0.840	17/64	23/32	27/32
E996E	3/4	100	.824	1.050	121/64	25/32	29/32
E996F	1	100	1.049	1.315	15/8	61/64	13/32
E996G	1 1/4	50	1.380	1.660	131/32	11/16	1 1/4
E996H	1 1/2	50	1.610	1.900	213/64	13/16	1 3/8
E996J	2	25	2.067	2.375	229/32	1 1/4	1 7/16
E996K	2 1/2	15	2.469	2.875	37/16	1 7/8	1 15/16
E996L	3	20	3.068	3.500	4 1/8	2	2 1/16
E996N	4	10	4.026	4.500	5 1/8	2 1/2	2 1/4



Threaded adapters

Cat. No.	Size (in.)	Std. Ctn.
E9842D ¹	1/2	25
E9842E ²	3/4	25

¹ Fits 3/4" sockets

² Fits 1" sockets



Reducer plugs

Cat. No.	Size (in.)	Std. Ctn.	Std. Wt. (lbs.)
▶ E971C	3/4 x 1/2	100	2
▶ E971D	1 x 3/4	100	3



LISTED
E23018
Except where noted by ▶



Plugs (Polyethylene)

Cat. No.	Size (in.)	Std. Ctn.	Std. Wt. (lbs.)
▶ P258H	1 1/2	50	2
▶ P258K	2 1/2	25	1.5



LISTED
E23018
Except where noted by ▶



Plugs with pull tabs (Polyethylene)

Cat. No.	Size (in.)	Std. Ctn.	Std. Wt. (lbs.)
▶ P258JT	2	60	3
▶ P258LT	3	30	3
▶ P258NT	4	48	8
▶ P258PT	5	30	6
▶ P258RT	6	30	9



LISTED
E23018
Except where noted by ▶