

Conduit Bodies and Fittings (for use with Schedule 40 and 80 Conduit)

Feature unthreaded hubs and textured lids with foam-in-place gaskets.



LR31146



LISTED
E11461

Except where noted by ▶

NEMA 4, 4X

Temperature range:
-50° C to 120° C

Conduit Bodies Type LB

Note: Covers are not sold as separate item.

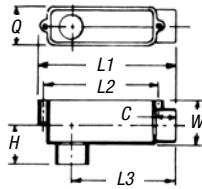

DIMENSIONS (IN.)

CAT. NO.	SIZE (IN.)	STD. CTN.	TYPICAL C	MAX. L1	TYPICAL L2	MAX. L3	MAX. H	MAX. Q	MAX. W	VOL. CU. IN.
E986D	1/2	25	1 1/16	4 5/16	3 3/32	3 1/16	1 1/16	1 11/32	1 1/2	4.0
E986E	3/4	15	2 9/32	6 3/32	5 9/32	4 25/32	1 25/32	1 3/4	2 1/32	12.0
E986F	1	10	2 9/32	6 3/32	5 9/32	4 25/32	1 25/32	1 3/4	2 1/32	12.0
E986G	1 1/4	10	1 3/32	7 31/32	6 13/32	6	2 1/16	2 1/2	2 3/4	32.0
E986H	1 1/2	10	1 3/32	7 31/32	6 13/32	6	2 1/16	2 1/2	2 3/4	32.0
E986J	2	10	1 3/32	9 31/32	8 13/32	7 1/4	2 1/16	3 3/32	3 15/32	63.0
▶ E986K	2 1/2	4	1 5/8	14 7/8	13 1/4	11 31/32	3 3/4	4 11/32	4 9/8	210
▶ E986L	3	4	1 5/8	14 7/8	13 1/4	11 31/32	3 3/4	4 11/32	4 9/8	210
▶ E986M	3 1/2	4	1 25/32	17 23/32	15 1/8	14 17/64	4 1/16	5 11/32	5 13/32	390
▶ E986N	4	4	1 25/32	17 23/32	15 1/8	14 17/64	4 1/16	5 11/32	5 13/32	390

Type LR

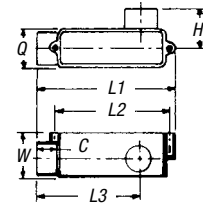

DIMENSIONS (IN.)

CAT. NO.	SIZE (IN.)	STD. CTN.	TYPICAL C	MAX. L1	TYPICAL L2	MAX. L3	MAX. H	MAX. Q	MAX. W	VOL. CU. IN.
E985D-CAR	1/2	10	1 1/16	4 5/16	3 3/32	3 1/16	1 1/16	1 11/32	1 1/2	4.0
E985E-CAR	3/4	10	2 9/32	6 3/32	5 9/32	4 25/32	1 25/32	1 3/4	2 1/32	12.0
E985F	1	10	2 9/32	6 3/32	5 9/32	4 25/32	1 25/32	1 3/4	2 1/32	12.0
E985G	1 1/4	10	1 3/32	7 31/32	6 13/32	6	2 1/16	2 1/2	2 3/4	32.0
E985H-CAR	1 1/2	5	1 3/32	7 31/32	6 13/32	6	2 1/16	2 1/2	2 3/4	32.0
E985J	2	10	1 3/32	9 31/32	8 13/32	7 1/4	2 1/16	3 3/32	3 15/32	63.0

Type E

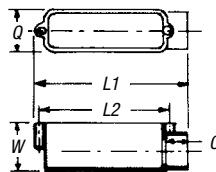

DIMENSIONS (IN.)

CAT. NO.	SIZE (IN.)	STD. CTN.	TYPICAL C	MAX. L1	TYPICAL L2	MAX. Q	MAX. W	VOL. CU. IN.
988D	1/2	25	1 1/16	4 5/16	3 1/2	1 11/32	1 1/2	4.0
E988E	3/4	20	2 9/32	6 11/32	5 9/32	1 3/4	2 1/32	12.0
E988F	1	10	2 9/32	6 11/32	5 9/32	1 3/4	2 1/32	12.0
E988G	1 1/4	10	1 3/32	8	6 13/32	2 1/2	2 3/4	32.0
E988H	1 1/2	10	1 3/32	8	6 13/32	2 1/2	2 3/4	32.0
E988J	2	5	1 3/32	9 5/32	8 13/32	3 3/32	3 15/32	63.0

Type T

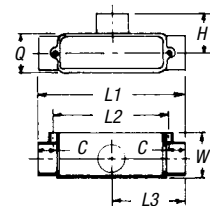

DIMENSIONS (IN.)

CAT. NO.	SIZE (IN.)	STD. CTN.	TYPICAL C	MAX. L1	TYPICAL L2	MAX. L3	MAX. H	MAX. Q	MAX. W	VOL. CU. IN.
E983D-CAR	1/2	10	1 1/16	4 11/16	3 3/32	2 11/32	1 1/16	1 11/32	1 1/2	4.0
E983E	3/4	15	2 9/32	6 7/8	5 3/32	4 1/16	1 25/32	1 3/4	2 1/32	12.0
E983F	1	20	2 9/32	6 7/8	5 3/32	3 7/16	1 25/32	1 3/4	2 1/32	12.0
E983G	1 1/4	10	1 3/32	8 13/32	6 13/32	4 3/16	2 1/16	2 1/2	2 3/4	32.0
E983H	1 1/2	10	1 3/32	8 13/32	6 13/32	4 3/16	2 1/16	2 1/2	2 3/4	32.0
E983J	2	10	1 3/32	10 5/16	8 13/32	5 5/32	2 1/16	3 3/32	3 15/16	63.0

Type C

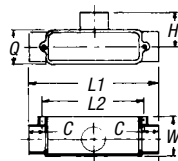

DIMENSIONS (IN.)

CAT. NO.	SIZE (IN.)	STD. CTN.	TYPICAL C	MAX. L1	TYPICAL L2	MAX. Q	MAX. W	VOL. CU. IN.
E987D	1/2	25	1 1/16	4 11/16	3 1/2	1 11/32	1 1/2	4.0
E987E-CAR	3/4	10	2 9/32	6 7/8	5 9/64	1 3/4	2 1/32	12.0
E987F-CAR	1	10	2 9/32	6 7/8	5 9/32	1 3/4	2 1/32	12.0
E987G	1 1/4	10	1 3/32	8 13/32	6 13/32	2 1/2	2 3/4	32.0
E987H	1 1/2	10	1 3/32	8 13/32	6 13/32	2 1/2	2 3/4	32.0
E987J	2	15	1 3/32	10 5/16	8 13/32	3 3/32	3 15/32	63.0

Type LL

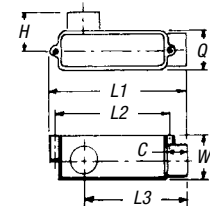

DIMENSIONS (IN.)

CAT. NO.	SIZE (IN.)	STD. CTN.	TYPICAL C	MAX. L1	TYPICAL L2	MAX. L3	MAX. H	MAX. Q	MAX. W	VOL. CU. IN.
E984D-CAR	1/2	10	1 1/16	4 5/16	3 3/32	3 1/16	1 1/16	1 11/32	1 1/2	4.0
E984E	3/4	20	2 9/32	6 3/32	5 9/32	4 25/32	1 25/32	1 3/4	2 1/32	12.0
E984F-CAR	1	10	2 9/32	6 3/32	5 9/32	4 25/32	1 25/32	1 3/4	2 1/32	12.0
E984G-CAR	1 1/4	5	1 3/32	7 31/32	6 13/32	6	2 1/16	2 1/2	2 3/4	32.0
E984H	1 1/2	10	1 3/32	7 31/32	6 13/32	6	2 1/16	2 1/2	2 3/4	32.0
E984J	2	10	1 3/32	9 31/32	8 13/32	7 1/4	2 1/16	3 3/32	3 15/32	63.0