

Conduit Bodies and Fittings (for use with Schedule 40 and 80 Conduit)

Adapters

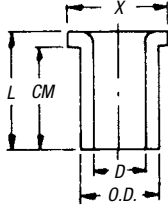

Adapts non-metallic conduit to all electrical enclosures by inserting adapter through knockout and cementing into Carlon couplings.



Box Adapters for Enclosures

CAT. NO.	SIZE (IN.)	STD. CTN.	MIN D (IN.)	OD (IN.) TYPICAL	MAX X (IN.)	CM (IN.) TYPICAL	L (IN.) TYPICAL
E996D	1/2	100	.662	.840	1 1/4	2 3/32	2 3/32
E996E	3/4	100	.824	1.050	1 3/4	2 3/32	2 3/32
E996F	1	100	1.049	1.315	1 3/4	6 1/4	1 3/32
E996G	1 1/4	50	1.380	1.660	1 3/4	1 1/16	1 1/4
E996H	1 1/2	50	1.610	1.900	2 1/4	1 1/16	1 3/8
E996J	2	25	2.067	2.375	2 3/4	1 1/4	1 1/16
E996K	2 1/2	15	2.469	2.875	3 1/4	1 1/8	1 15/16
E996L	3	20	3.068	3.500	4 1/2	2	2 1/16
E996N	4	10	4.026	4.500	5 1/2	2 1/2	2 1/4

Threaded Adapters

CAT. NO.	SIZE (IN.)	STD. CTN.
E9842D ¹	1/2	25
E9842E ²	3/4	25

¹ Fits 3/4" sockets
² Fits 1" sockets



Plugs

SP LR31146
UL LISTED E23018
Except where noted by ▶

Reducer Plugs

CAT. NO.	SIZE (IN.)	STD. CTN.	STD. WT. (LBS.)
▶ E971C	3/4 x 1/2	100	2
▶ E971D	1 x 3/4	100	3



Plugs (Polyethylene)

CAT. NO.	SIZE (IN.)	STD. CTN.	STD. WT. (LBS.)
▶ P258H	1 1/2	50	2
▶ P258K	2 1/2	25	1.5



Plugs with Pull Tabs (Polyethylene)

CAT. NO.	SIZE (IN.)	STD. CTN.	STD. WT. (LBS.)
▶ P258JT	2	60	3
▶ P258LT	3	30	3
▶ P258NT	4	48	8
▶ P258PT	5	30	6
▶ P258RT	6	30	9



Reducers



For connecting different sizes of conduit.
Bell x Spigot.

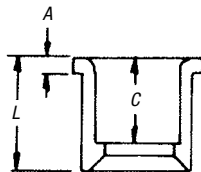

Reducer Bushings

CAT. NO.	SIZE (IN.)	STD. CTN.	L (IN.) TYPICAL	A (IN.) TYPICAL	C (IN.) TYPICAL
E950ED	3/4 x 1/2	100	1 1/32	1 1/64	1 1/32
E950FD-CAR	1 x 1/2	25	1 11/32	3/16	5/64
E950FE	1 x 3/4	100	1 11/32	3/16	1/64
E950GE-CAR	1 1/4 x 3/4	10	1 5/32	3/16	1/64
E950GF	1 1/4 x 1	50	1 5/32	3/16	1/64
E950HF-CAR	1 1/2 x 1	10	1 9/32	3/16	1/64
E950HG-CAR	1 1/2 x 1 1/4	10	1 9/32	3/16	1 1/64
E950JG-CAR	2 x 1 1/4	10	1 3/4	7/32	1 17/64
E950JH-CAR	2 x 1 1/2	10	1 3/4	7/32	1 25/64
E950KJ-CAR	2 1/2 x 2	10	2 5/32	3/8	1 27/64
E950LJ-CAR	3 x 2	10	2 1/2	1/4	1 1/8
▶ E950LK	3 x 2 1/2	25	1 5/16	1/4	1 11/16
E950NL	4 x 3	25	2 3/4	3/16	1 15/16

Fabricated Reducers

CAT. NO.	SIZE (IN.)	STD. CTN.	STD. WT. (LBS.)
Male x Male			
▶ E952JH	1 1/2 x 2	48	20
▶ E952KJ	2 1/2 x 2	48	26
▶ E952LJ	3 x 2	36	21
▶ E952LK	3 x 2 1/2	36	32
▶ E952NL	4 x 3	15	21
▶ E952NM	4 x 3 1/2	15	25
▶ E952PN	5 x 4	12	27
▶ E952RP	6 x 5	10	31
Male x Female			
▶ E952NJF	4 x 2	15	16
▶ E952RNF	6 x 4	10	28

P&C Flex® Conduit and Fittings

P&C Flex® Conduit

CAT. NO.	SIZE (IN.)	I.D. (IN.)	O.D. (IN.)	PULL TAPE	REEL/ COIL	STD. CTN. (FT.)	STD. WT. (LBS.)
11807-350*	¾	.83	1.040	Empty	Coil	350	39.9
1808-250C	1	1.000	1.315	Empty	Coil	250	36.3
11808-5200	1	1.000	1.315	Empty	Reel	5200	1019.0
11809-900	1¼	1.340	1.660	Empty	Reel	900	243.0
11809-4500	1¼	1.340	1.660	Empty	Reel	4500	972.0
11810-250	1½	1.570	1.900	Empty	Reel	250	75.8
11810-4500	1½	1.570	1.900	Empty	Reel	4500	1080.0
11810T-2300	1½	1.570	1.900	1250 lb.	Reel	2300	720.0
11810T-250	1½	1.570	1.900	1250 lb.	Reel	250	78.0
11811-1100	2	2.045	2.375	Empty	Reel	1100	521.4
11811-250	2	2.045	2.375	Empty	Reel	250	87.0
11811-2500	2	2.045	2.375	Empty	Reel	2500	815.0
11811-500	2	2.045	2.375	Empty	Reel	500	201.6
11811-700	2	2.045	2.375	Empty	Reel	700	269.0
11811T-250	2	2.045	2.375	1250 lb.	Reel	250	89.0
11812-250	2½	2.469	2.875	Empty	Reel	250	121.0
11812AG-001	2½	2.469	2.875	Empty	Reel	1300	516.1
11813-1200	3	3.068	3.500	Empty	Reel	1200	850.8
11813-250	3	3.068	3.500	Empty	Reel	250	192.0
11813-500	3	3.068	3.500	Empty	Reel	500	523.0
11813-750	3	3.068	3.500	Empty	Reel	750	554.3
11815-250	4	4.026	4.500	Empty	Reel	250	324.0
11815-800	4	4.026	4.500	Empty	Reel	800	778.4

*Pull tape not available for ¾" conduit.

P&C Flex® Fittings

Couplings

CAT. NO.	SIZE (IN.)	STD. CTN.	STD. WT. (LBS.)
E940E	¾	100	4.6
E940F	1	50	3.5
E940G	1¼	30	3.2
E940H	1½	25	3.4
E940J	2	30	5.3
E940K	2½	20	7.5
E940L	3	25	14.7
E940N	4	15	12.5



Female Adapters

CAT. NO.	SIZE (IN.)	STD. CTN.	STD. WT. (LBS.)
E942E	¾	100	4.3
E942F	1	50	3.7
E942G	1¼	30	3.3
E942H	1½	25	3.3
E942J	2	30	5.4
E942K	2½	20	6.6
E942L	3	25	11.8
E942N	4	15	10.8



Terminal Adapters

CAT. NO.	SIZE (IN.)	STD. CTN.	STD. WT. (LBS.)
E943E	¾	125	4.2
E943F	1	50	3.0
E943G	1¼	25	4.1
E943H	1½	25	2.7
E943J	2	5	6.9
E943K	2½	20	6.3
E943L	3	45	16.6
E943N	4	15	11.7



Bell Ends (Schedule 40)

CAT. NO.	SIZE (IN.)	STD. CTN.	STD. WT. (LBS.)
E997F	1	50	2.6
E997G	1¼	35	2.5
E997H	1½	30	2.5
E997J	2	10	4.8
E997K	2½	10	2.0
E997L	3	10	10.0
E997N	4	30	16.0



Plugs

CAT. NO.	SIZE (IN.)	STD. CTN.	STD. WT. (LBS.)
P258H	1½	50	1.7
P258JT	2	60	3.1
P258K	2½	25	1.5
P258LT	3	30	3.4
P258NT	4	48	8.3

