

Metallic Liquidtight Cord and Cable Connectors

Liquidtight Strain-Relief Connectors — 45°

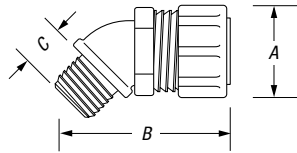
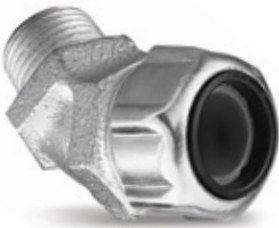

For wire mesh grips, refer to page E-142.

CAT. NO.	CABLE-SIZE MIN.-MAX. (IN.)	HUB SIZE	DIMENSIONS (IN.)			THROAT DIA.
			A	B	C	
2200	.125-.250	1/2"	1 1/8	1 1/32	9/16	3/16
2201	.250-.375	1/2"	1 1/8	1 1/32	9/16	3/16
2202	.375-.500	1/2"	1 1/8	1 1/32	9/16	3/16
2203	.450-.560	1/2"	1 1/8	1 1/32	9/16	3/16
2204*	.500-.625	1/2"	1 3/8	1 13/32	9/16	3/16
2205*	.625-.750	1/2"	1 3/8	1 13/32	9/16	3/16
2206	.125-.250	3/4"	1 3/8	1 13/32	5/8	25/32
2207	.250-.375	3/4"	1 3/8	1 13/32	5/8	25/32
2208	.375-.500	3/4"	1 3/8	1 13/32	5/8	25/32
2209	.500-.625	3/4"	1 3/8	1 13/32	5/8	25/32
2210	.625-.750	3/4"	1 3/8	1 13/32	5/8	25/32
2211*	.750-.880	3/4"	1 11/16	1 1/2	1 1/2	3/4
2213	.375-.500	1"	1 3/8	1 1/2	25/32	15/16
2214	.500-.625	1"	1 3/8	1 1/2	25/32	15/16
2215	.625-.750	1"	1 3/8	1 1/2	25/32	15/16
2216	.750-.875	1"	1 11/16	1 13/32	25/32	15/16
2217*	.875-.985	1"	1 11/16	1 13/32	25/32	15/16
2218*	.880-1.065	1"	2 1/16	1 31/32	25/32	15/16
2219*	1.065-1.205	1"	2 1/16	1 31/32	25/32	15/16
2220*	.880-1.065	1 1/4"	2 1/16	1 29/32	1 3/16	15/16
2221*	1.065-1.205	1 1/4"	2 1/16	1 29/32	1 3/16	15/16
2222*	1.187-1.375	1 1/4"	2 1/16	2 1/4	1 3/16	1 21/64
2223*	1.375-1.485	1 1/4"	2 1/16	2 1/4	1 3/16	1 21/64

Liquidtight Strain-Relief Connectors — 90°

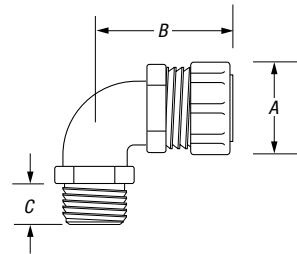

CAT. NO.	CABLE-SIZE MIN.-MAX. (IN.)	HUB SIZE	DIMENSIONS (IN.)			THROAT DIA.
			A	B	C	
2268	.250-.375	1/2"	1 1/8	1 23/32	5/8	19/32
2269	.375-.500	1/2"	1 1/8	1 23/32	5/8	19/32
2270	.450-.560	1/2"	1 1/8	1 23/32	5/8	19/32
2250*	.500-.625	1/2"	1 3/8	1 11/16	9/16	39/64
2251*	.625-.750	1/2"	1 3/8	1 11/16	9/16	39/64
2252	.125-.250	3/4"	1 3/8	1 3/4	1/2	25/32
2271	.250-.375	3/4"	1 3/8	1 5/8	1/2	25/32
2272	.375-.500	3/4"	1 3/8	1 5/8	1/2	25/32
2273	.500-.625	3/4"	1 3/8	1 5/8	1/2	25/32
2274*	.620-.750	3/4"	1 3/8	1 5/8	1/2	25/32
2253*	.750-.880	3/4"	1 11/16	1 31/32	9/16	25/32
2254	.375-.500	1"	1 3/8	2	25/32	1
2255	.500-.625	1"	1 3/8	2	25/32	1
2256*	.625-.750	1"	1 3/8	2	25/32	1
2275	.750-.875	1"	1 11/16	2	5/8	1
2276	.875-.985	1"	1 11/16	2	5/8	1
2257*	.880-1.065	1"	2 1/16	2 21/32	25/32	1 3/16
2258*	1.065-1.205	1"	2 1/16	2 21/32	25/32	1 3/16
2277	.880-1.065	1 1/4"	2 1/16	2 7/8	1 1/16	1 3/16
2278	1.065-1.205	1 1/4"	2 1/16	2 7/8	1 1/16	1 3/16
2279*	1.187-1.375	1 1/4"	2 1/16	2 13/16	1 3/16	1 11/32
2280*	1.375-1.485	1 1/4"	2 1/16	2 13/16	1 3/16	1 11/32
2281	.812-1.000	1 1/2"	2 5/16	2 7/8	1 3/16	1 13/32
2282	1.000-1.187	1 1/2"	2 5/16	2 7/8	1 3/16	1 13/32
2283*	1.187-1.375	1 1/2"	2 5/16	2 7/8	1 3/16	1 13/32
2284	1.125-1.375	2"	2 25/32	3 1/4	2 7/32	1 31/32
2285	1.375-1.625	2"	2 25/32	3 1/4	2 7/32	1 31/32
2286	1.625-1.875	2"	2 25/32	3 1/4	2 7/32	1 31/32

UL Listed as liquidtight strain relief and outlet bushing.
CSA certified watertight.

UL File No. E 13938

CSA File No. 589 & 4484

* UL not applicable.

* Remove sufficient outer covering of cable to permit conductors to pass through connector body.

Complies with JIC standards.

Temperature rating 105° C.

Suitable for hazardous locations use where general-purpose equipment is specifically permitted per NEC®.