

DIAL INDICATORS

655 DIAL INDICATORS

AGD GROUP 3 RANGES UP TO 1" AND 25MM

These indicators have a shockless, hardened steel gear train and jewel bearings. They are furnished with a lug-on-center back. Antimagnetic and special non-shock mechanisms are options available for all models. For more information on these and other attachments, accessories and contact points, refer to the end of the AGD Dial Indicator listings. For dial styles, see previous pages.

If lift lever is desired, indicator must be ordered with case stem cap.

655 Dial Indicators						
Graduation	Range One Rev.	Total	Dial Reading	Stem Dia.	Cat. No.	EDP
0.002mm	0.2mm	0.5mm	0-10-0	.375" (9.5mm)	655-161J 655-161J-8	53533 64659
0.002mm	0.2mm	0.5mm	0-20	.375" (9.5mm)	655-261J 655-261J-8	53603 64660
0.01mm	1.0mm	2.5mm	0-50-0	.375" (9.5mm)	655-181J 655-181J-8	53535 64661
0.01mm	1.0mm	2.5mm	0-100	.375" (9.5mm)	655-281J 655-281J-8	53605 64868
0.01mm	1.0mm	25mm	0-100	.375" (9.5mm)	655-881J 655-881J-8	56229 64869

655 Dial Indicators					
Graduation	Range One Rev.	Total	Dial Reading	Cat. No.	EDP
.0001"	.008"	.020"	0-4-0	655-118J	53507
.0001"	.010"	.025"	0-5-0	655-111J	53505
			0-10	655-211J	53537
.0001"	.010"	.200"	0-5-0	655-511J	53615
			0-10	655-611J	53617
.00025"	.010"	.025"	0-5-0	655-124J	53509
			0-10	655-224J	53539
.00025"	.020"	.050"	0-10-0	655-128J	53511
			0-20	655-228J	53541
.00025"	.030"	.075"	0-15-0	655-129J	53513
			0-30	655-229J	53543
.0005"	.020"	.050"	0-10-0	655-134J	53517
			0-20	655-234J	53587
.0005"	.030"	.075"	0-15-0	655-136J	53519
			0-30	655-236J	53589
.0005"	.040"	.100"	0-20-0	655-138J	53521
			0-40	655-238J	53591
.0005"	.050"	.125"	0-25-0	655-131J	53515
			0-50	655-231J	53585
.001"	.020"	.050"	0-10-0	655-142J	53525
			0-20	655-242J	53595
.001"	.030"	.075"	0-15-0	655-143J	53527
			0-30	655-243J	53597
.001"	.040"	.100"	0-20-0	655-144J	53529
			0-40	655-244J	53599
.001"	.050"	.125"	0-25-0	655-145J	53531
			0-50	655-245J	53601
.001"	.100"	.250"	0-50-0	655-141J	53523
			0-100	655-241J	53593
.001"	.100"	.500"	0-50-0	655-341/5J	53607
			0-100	655-441/5J	53611
.001"	.100"	1.000"	0-50-0	655-341J	53609
			0-100	655-441J	53613

INDICATORS AND GAGES



655-161J-8



655-111J

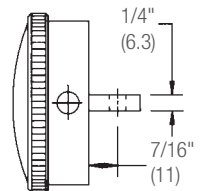
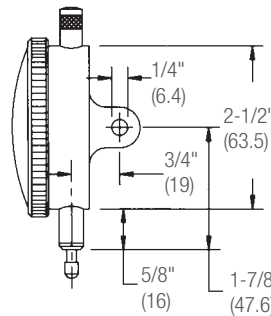
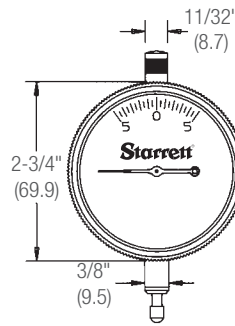

655-131J
with top lift



655-341J
with stem cap

