

3/8" DRIVE IMPACT SOCKETS - 8 POINT

- ▶ Proto® 8 Point Impact Sockets are ideal for use on stubborn or damaged fasteners, and also on fasteners made from soft materials.
- ▶ TorquePlus™ features apply.
- ▶ Drive end chamfer and four detents help provide quick positive engagement with drive tool on any of the socket drive walls.
- ▶ Tight tolerances for snug fit on fastener.
- ▶ Large clearance holes, concentric opening and nut end chamfer make it easy to position socket on fasteners.
- ▶ Made from high strength steel to help minimize wall thickness and provide access to fasteners in recesses and where nuts and bolts protrude.
- ▶ Impact sockets are used wherever powered drive tools are used to install or remove fasteners.
- ▶ Impact sockets are designed to withstand higher torque and force associated with impact tools in repetitive application.
- ▶ Socket size stamped on tool for easy identification.
- ▶ Side locking hole.



Product #	Size (in) (A)	Nut End Outside Dia. (in) (B)	Drive End Outside Dia. (in) (C)	Nut Depth (in) (D)	Bolt Clearance Depth (in) (E)	Overall Length (in) (L)	Weight (lbs)
J7208S	1/4	31/64	11/16	1/4	1/2	1	0.07
J7210S	5/16	5/8	11/16	9/32	1/2	1	0.06
J7212S	3/8	11/16	11/16	5/16	1/2	1	0.06
J7214S	7/16	13/16	13/16	21/64	1/2	1	0.10
J7216S	1/2	59/64	15/16	3/8	9/16	1-1/16	0.13
J7218S	9/16	1-3/32	1-3/16	9/16	5/8	1-1/8	0.17



ASME B107.2

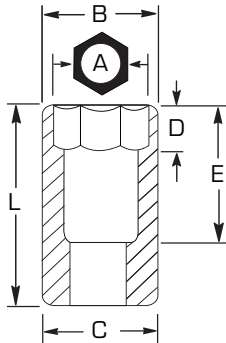

3/8" DRIVE IMPACT HEX BIT SOCKETS

Product #	Size (in)	Bit Length (in)	Overall Length (in)	Weight (lbs)
J72901/8	1/8	1-5/8	2-23/32	0.07
J72905/32	5/32	1-5/8	2-23/32	0.08
J72903/16	3/16	1-5/8	2-23/32	0.08
J72907/32	7/32	1-5/8	2-23/32	0.09
J72901/4	1/4	1-5/8	2-23/32	0.10
J72905/16	5/16	1-5/8	2-23/32	0.13
J72903/8	3/8	1-5/8	2-23/32	0.14



3/8" DRIVE METRIC IMPACT HEX BIT SOCKETS

- ▶ Size stamped on tool for easy identification.
- ▶ Side locking hole.

Product #	Size (mm)	Bit Length (in)	Overall Length (in)	Weight (lbs)
J7290-4M	4	1-5/8	2-23/32	0.07
J7290-5M	5	1-5/8	2-23/32	0.08
J7290-6M	6	1-5/8	2-23/32	0.09
J7290-8M	8	1-5/8	2-23/32	0.12
J7290-10M	10	1-5/8	2-23/32	0.14



METRIC

