

IMPACT SOCKETS

1/4" DRIVE HIGH STRENGTH MAGNETIC POWER SOCKETS - 6 POINT

- ▶ ProtoGrip™ Magnetic Sockets use high strength magnets made from a rare earth magnet alloy/nylon blend.
- ▶ ProtoGrip™ Magnetic Sockets require no bushings to hold the magnet in place. Allows room for more magnet material, helping increase total magnetic strength.
- ▶ Designed to easily pick up heavy fasteners and hold them tightly during use.
- ▶ Strong magnetic hold helps increase efficiency when installing fasteners in awkward or hard-to-reach locations.
- ▶ Size stamped on tool for easy identification.



INCH	6	Nut End Outside Diameter (in) (B)	Drive End Outside Diameter (in) (C)	Nut Depth (in) (D)	Overall Length (in) (L)	Weight (lbs)
3/16	J6906PF	5/16	1/2	5/32	7/8	0.03
1/4	J6908PF	25/64	1/2	11/64	7/8	0.03
5/16	J6910PF	1/2	1/2	13/64	15/16	0.04
11/32	J6911PF	33/64	33/64	7/32	15/16	0.04
3/8	J6912PF	9/16	9/16	15/64	15/16	0.05
7/16	J6914PF	21/32	21/32	1/4	1	0.07
1/2	J6916PF	11/16	11/16	1/4	1	0.08

ASME B107.110-2012 

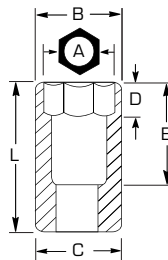

1/4" DRIVE IMPACT UNIVERSAL JOINT

- ▶ Tight tolerances for snug fit on fastener.
- ▶ Used wherever powered drive tools are used to install or remove fasteners.
- ▶ Designed to withstand the high torque and force associated with impact tools in repetitive application.
- ▶ Features two through holes and a groove to accept a Proto® Retaining Ring or pin and O-ring to help secure the socket to the drive tool anvil.
- ▶ Position at appropriate angle to turn fasteners where obstructions prevent a straight application.
- ▶ Ball and spring design which allows for a 30° working angle.
- ▶ Smooth 360° rotation.



INCH	Product #	Drive End Outside Diameter (in)	Overall Length (in)	Weight (lbs)
1/4	J66170P	5/8	1-3/8	0.27



1/4" DRIVE IMPACT SOCKETS & UNIVERSAL JOINT