



# Pipe Fittings

| MATERIALS OF CONSTRUCTION |                     |
|---------------------------|---------------------|
| FITTINGS:                 | CA345, CA360, CA377 |

| NOMENCLATURE       |                  |
|--------------------|------------------|
| EXAMPLE: 2214P-2-2 | ATTRIBUTE:       |
| 2                  | EXTRUSION        |
| 1 (NOT SHOWN)      | FORGING          |
| 214                | 45° STREET ELBOW |
| P                  | PIPE             |
| 2                  | 1/8" PIPE THREAD |
| 2                  | 1/8" PIPE THREAD |

| APPLICABLE TUBE |                            |
|-----------------|----------------------------|
| TUBE MATERIAL:  | COPPER, BRASS, IRON PIPE   |
| THREAD SIZE:    | 1/8, 1/4, 3/8, 1/2, 3/4, 1 |

| SPECIFICATIONS      |                 |
|---------------------|-----------------|
| PRESSURE RANGE:     | UP TO 1,000 PSI |
| TEMPERATURE RANGES: | -65° TO +250°F  |



All pipe fittings meet functional requirements of SAE J530 and SAE J531. Threads are made to Dryseal standards.

## Pipe thread assembly guide (turns method) for Dryseal threads with pre-applied Vibra Seal

J

### Straight Fittings

1. Tighten external thread into the internal thread.
1. Tighten an additional 2 revolutions with a wrench up to 1/2 in. male pipe thread. Above 1/2 in., 1 1/2 to 2 1/2 revolutions.

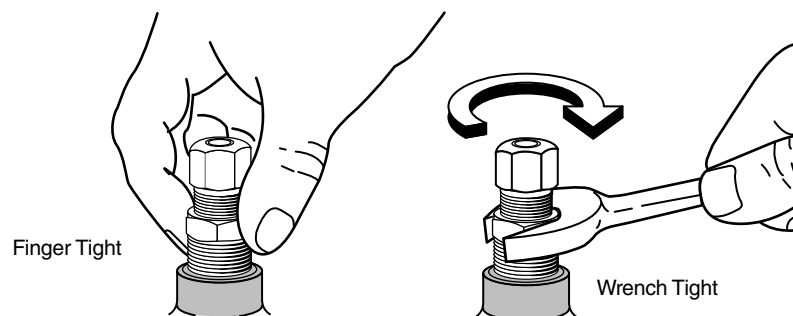

### Elbow or Tee Fittings

2. Tighten external thread into the internal thread.
3. Tighten an additional 1 to 1 1/2 revolutions with a wrench.
4. Tighten fitting, Clockwise, to Align with Tubing (never counter clockwise).

Note: To minimize the possibility of a leaking threaded joint after assembling male to female pipe threads, neither end should be backed out (loosened) once the assembly has been made.

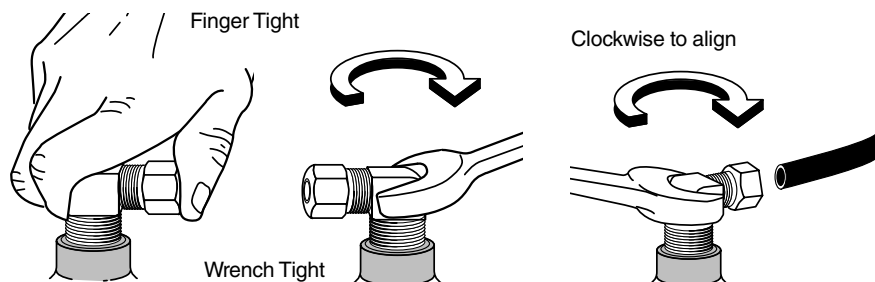

**Slotted-Head Plug 220P**

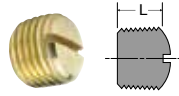

| PART NO. | PIPE THREAD | L   |
|----------|-------------|-----|
| 220P-2   | 1/8         | .31 |
| 220P-4   | 1/4         | .42 |
| 220P-6   | 3/8         | .43 |

**Adapter 222P**

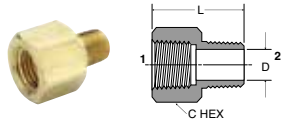

| PART NO.   | 1 PIPE THREAD | 2 PIPE THREAD | C HEX  | L    | FLOW DIA. D |
|------------|---------------|---------------|--------|------|-------------|
| 222P-2-2   | 1/8           | 1/8           | 9/16   | .88  | .220        |
| 222P-4-2   | 1/4           | 1/8           | 3/4    | 1.06 | .220        |
| 222P-4-4   | 1/4           | 1/4           | 3/4    | 1.25 | .314        |
| 222P-6-2   | 3/8           | 1/8           | 7/8    | 1.10 | .220        |
| 222P-6-4   | 3/8           | 1/4           | 7/8    | 1.25 | .314        |
| 222P-6-6   | 3/8           | 3/8           | 7/8    | 1.25 | .440        |
| 222P-8-4   | 1/2           | 1/4           | 1      | 1.47 | .314        |
| 222P-8-6   | 1/2           | 3/8           | 1-1/16 | 1.47 | .440        |
| 222P-8-8   | 1/2           | 1/2           | 1-1/16 | 1.66 | .564        |
| 222P-12-6  | 3/4           | 3/8           | 1-3/8  | 1.50 | .440        |
| 222P-12-8  | 3/4           | 1/2           | 1-3/8  | 1.69 | .564        |
| 222P-12-12 | 3/4           | 3/4           | 1-3/8  | 1.69 | .752        |

**90° Street Elbow 1202P-2202P**

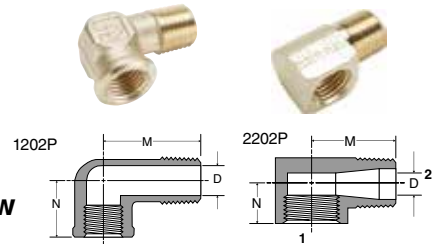

| PART NO.    | 1 PIPE THREAD | 2 PIPE THREAD | M    | N    | FLOW DIA. D |
|-------------|---------------|---------------|------|------|-------------|
| 1202P-2-2   | 1/8           | 1/8           | .81  | .56  | .22         |
| 2202P-2-2   | 1/8           | 1/8           | .62  | .48  | .22         |
| 2202PA-2-2* | 1/8           | 1/8           | .66  | .48  | .22         |
| 2202P-4-2   | 1/4           | 1/8           | .72  | .45  | .23         |
| 1202P-4-4   | 1/4           | 1/4           | 1.08 | .69  | .31         |
| 2202P-4-4   | 1/4           | 1/4           | .91  | .45  | .34         |
| 2202PA-4-4* | 1/4           | 1/4           | .91  | .72  | .31         |
| 2202P-4-6   | 1/4           | 3/8           | .97  | .78  | .43         |
| 1202P-6-4   | 3/8           | 1/4           | 1.25 | .78  | .31         |
| 1202P-6-6   | 3/8           | 3/8           | 1.25 | .78  | .42         |
| 2202P-6-6   | 3/8           | 3/8           | .98  | .54  | .41         |
| 2202PA-6-6* | 3/8           | 3/8           | .97  | .78  | .43         |
| 1202P-6-8   | 3/8           | 1/2           | 1.53 | 1.01 | .56         |
| 1202P-8-6   | 1/2           | 3/8           | 1.25 | .97  | .42         |
| 2202P-8-8   | 1/2           | 1/2           | 1.25 | 1.03 | .56         |
| 2202P-12-8  | 3/4           | 1/2           | 1.39 | 1.10 | .56         |
| 2202P-12-12 | 3/4           | 3/4           | 1.39 | 1.10 | .75         |

\*Meets SAE Dimensions

**90° Union Elbow 1200P-2200P**

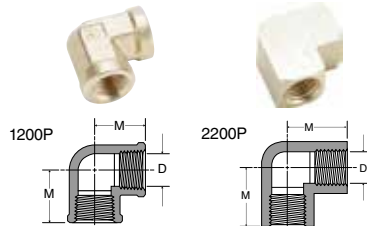

| PART NO.  | PIPE THREAD | M    | FLOW DIA. D |
|-----------|-------------|------|-------------|
| 1200P-2-2 | 1/8         | .56  | .329        |
| 2200P-2-2 | 1/8         | .55  | .339        |
| 1200P-4-4 | 1/4         | .81  | .441        |
| 2200P-4-4 | 1/4         | .78  | .441        |
| 1200P-6-6 | 3/8         | .84  | .571        |
| 2200P-6-6 | 3/8         | .84  | .571        |
| 2200P-8-8 | 1/2         | 1.07 | .703        |

**Union Tee 1203P-2203P**

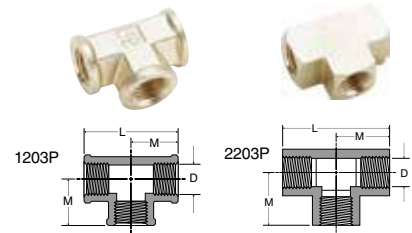

| PART NO. | PIPE THREAD | L    | M    | FLOW DIA. D |
|----------|-------------|------|------|-------------|
| 1203P-2  | 1/8         | 1.12 | .56  | .339        |
| 2203P-2  | 1/8         | 1.06 | .53  | .339        |
| 1203P-4  | 1/4         | 1.38 | .69  | .441        |
| 2203P-4  | 1/4         | 1.52 | .76  | .441        |
| 2203P-6  | 3/8         | 1.68 | .84  | .571        |
| 1203P-8  | 1/2         | 2.14 | 1.07 | .703        |
| 2203P-8  | 1/2         | 2.14 | 1.07 | .703        |
| 2203P-12 | 3/4         | 2.28 | 1.14 | .906        |