

Advantages

Ready-to-use compact one-piece fitting for use with most therm special tools are needed for assembly; just insert the tubing until it bottoms. Radial claws on the stainless steel grab ring grip the tubing securely to provide retention. Brass Male pipe threads come standard with a white acrylic sealant pre-applied ("W" prefix) swivels are featured on all male pipe threaded shapes for installation in tight places and for precise positioning. Prestolok Plus should not be used for live swivel applications. The outside diameter of the tubing to be used with the fitting is marked on the release button.

Materials

Prestolok Plus Bodies: CA377, CA360, CA345
 O-Ring: Nitrile (other compounds available on request)
 Release Button: Polyacetal
 Grab Ring: Stainless Steel

Recommended Tubing

Prestolok nickel plated and composite fittings are designed to be used with the following Parker Hannifin Parflex Division tubing.

Tubing Series	Tubing Material
E	Linear Low Density Polyethylene
PP	Polypropylene
N	Plasticized Polyamide (Nylon)
NR	Unplasticized Polyamide (Rigid Nylon)
U	Polyurethane 90 Durometer Shore A
HU	Polyurethane 95 Durometer Shore A

Other materials: Polyurethane 85 Durometer Shore A – Applications and service conditions vary and therefore the use of a tube support may be required for any 85A PU tubing.

The following commercially available O.D. – I.D. 85A tubing sizes require the use of a tube support regardless of application.

5/32" – 3/32"	3/16" – 1/8"	1/4" - .170"	1/4" – 3/16"
5/16" – 1/4"	3/8" – 5/16"	1/2" – 3/8"	

Working Pressure and Temperature Ranges

Prestolok Plus	Zero to 200°F at up to 300 PSI depending on tubing being used.
----------------	--

Vacuum applications are dependent upon temperature and type of tubing used.

Assembly Instructions

1. Cut thermoplastic tubing squarely, using Parker Tube Cutter PTC-001. Be certain the port or mating part is clean and free of debris.
2. Insert tubing into fitting until it bottoms. A slight twisting motion will ease the insertion. Pull on tubing to verify it is properly retained in the fitting.
3. To disassemble, simply push the release button against the body and remove tubing.

Nomenclature

Part numbers are constructed from symbols that identify the style and size of the fitting. The first series of numbers and letters identify the style and type fitting. The second series of numbers describe the size.

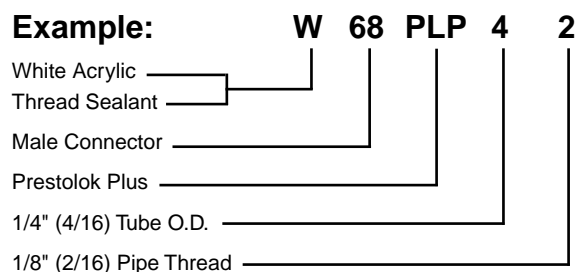

Sizes

Tube sizes are determined by the number of sixteenths of an inch in the tube O.D.

Specials

Fitting configurations and/or sizes other than those shown in the catalog can be furnished. It is suggested that a print or sketch be submitted with the inquiry.

62PLP Union (Nickle Plated)

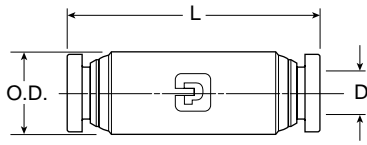

Part No.	Tube Size	O.D.	L	Flow Dia. D
62PLP-2	1/8	0.375	1.40	0.094
62PLP-3	3/16	0.437	1.41	0.156
62PLP-5/32	5/32	0.375	1.41	0.125
62PLP-4	1/4	0.500	1.43	0.188
62PLP-5	5/16	0.562	1.65	0.250
62PLP-6	3/8	0.625	1.66	0.312
62PLP-8	1/2	0.750	1.82	0.375

62PLPBH Bulkhead Union

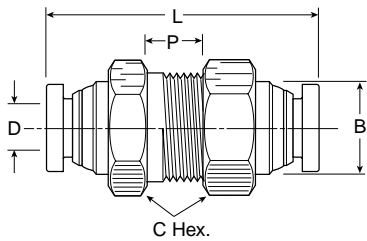

Part No.	Tube Size	B	C Hex.	P Max.	L	D
62PLPBH-2	1/8	7/16	9/16	0.39	1.40	0.094
62PLPBH-5/32	5/32	7/16	9/16	0.39	1.41	0.125
62PLPBH-4	1/4	9/16	11/16	0.29	1.43	0.188
62PLPBH-5	5/16	5/8	3/4	0.60	1.65	0.250
62PLPBH-6	3/8	3/4	7/8	0.54	1.66	0.312
62PLPBH-8	1/2	7/8	1	0.66	2.04	0.375

66PLP Female Connector (Nickle Plated)

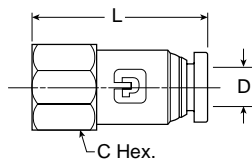

Part No.	Tube Size	B Thread (NPTF)	L	Flow Dia. D
66PLP-2-2	1/8	1/8	1.17	0.094
66PLP-3-2	3/16	1/8	1.13	0.156
66PLP-5/32-2	5/32	1/8	1.17	0.125
66PLP-5/32-4	5/32	1/4	1.38	0.125
66PLP-4-2	1/4	1/8	1.17	0.188
66PLP-4-4	1/4	1/4	1.38	0.188
66PLP-5-2	5/16	1/8	1.25	0.250
66PLP-5-4	5/16	1/4	1.45	0.250
66PLP-6-4	3/8	1/4	1.46	0.312
66PLP-6-6	3/8	3/8	1.51	0.312

66PLPBH Female Bulkhead (Nickle Plated)

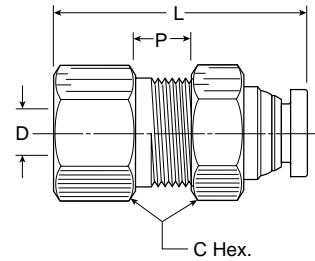

Part No.	Tube Size	Pipe Thread (NPTF)	C Hex.	P Max.	L	Flow Dia. D	Bulkhead Hole Dia. (mm)
66PLPBH-5/32-4	5/32	1/4	11/16	0.19	1.39	0.125	1/2
66PLPBH-4-4	1/4	1/4	11/16	0.24	1.35	0.188	9-16
66PLPBH-6-6	3/8	3/8	1	0.22	1.47	0.312	7/8
66PLPBH-8-6	1/2	3/8	1-1/4	0.35	1.56	0.344	1

W68PLP Male Connector (Nickle Plated)

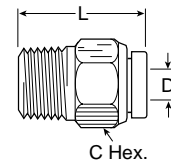
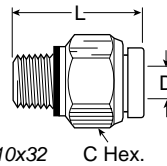

68PLP-10x32

Part No.	Tube Size	Pipe Thread	C Hex.	L	Flow Dia. D
68PLP-2-0	1/8	10x32	3/8	0.92	0.094
W68PLP-2-1	1/8	1/16	3/8	0.79	0.094
W68PLP-2-2	1/8	1/8	7/16	0.79	0.094
W68PLP-2-4	1/8	1/4	9/16	1.02	0.094
W68PLP-3-2	3/16	1/8	7/16	0.85	0.141
W68PLP-3-4	3/16	1/4	9/16	1.01	0.156
W68PLP-5/32-2	5/32	1/8	7/16	0.80	0.125
W68PLP-5/32-4	5/32	1/4	9/16	1.03	0.125
68PLP-4-0	1/4	10x32	1/2	0.96	0.094
W68PLP-4-1	1/4	1/16	1/2	1.07	0.141
W68PLP-4-2	1/4	1/8	1/2	0.89	0.188
W68PLP-4-4	1/4	1/4	9/16	1.00	0.188
W68PLP-4-6	1/4	3/8	3/4	1.04	0.188
W68PLP-5-2	5-16	1/8	9/16	1.18	0.234
W68PLP-5-4	5-16	1/4	9/16	1.04	0.250
W68PLP-5-6	5/16	3/8	11/16	1.04	0.250
W68PLP-6-2	3/8	1/8	5/8	1.21	0.234
W68PLP-6-4	3/8	1/4	5/8	1.08	0.312
W68PLP-6-6	3/8	3/8	11/16	1.02	0.312
W68PLP-6-8	3/8	1/2	7/8	1.289	0.312
W68PLP-8-4	1/2	1/4	13/16	1.44	0.344
W68PLP-8-6	1/2	3/8	13/16	1.24	0.344
W68PLP-8-8	1/2	1/2	7/8	1.35	0.375
68PLP-5/32-4LT*	5/32	1/4-28	7/16	0.88	0.093

*SAE-LT Threads

