

UL Listed Raintight EMT Steel Compression Connectors & Couplings

Type 7000NSR Raintight Connectors

Use:
To ground and secure EMT raceway to boxes and enclosures in wet locations.

- Features:**
- UL Listed Raintight
 - No disassembly required
 - Male hub threads NPS
 - Available with and without insulated throat
 - Concretetight

- Material/Finish:**
- Steel Body & Nut Zinc Electroplated
 - EPDM Rubber KO Sealing Ring

Third Party Certification:
 UL Listed: E-14895
 Listed Raintight

Applicable Third Party Standards:
 UL Standard: 514B

Trade Size (Inches)	Catalog Number	Insulated Throat Catalog Number	Dimensions in Inches			Weight per 100 pcs kgs (lbs)
			Body Length	Maximum Diameter	Thread Length	
1/2	7050NSR	7050NSRT	1.44	1.10	0.34	4.5 (10)
3/4	7075NSR	7075NSRT	1.50	1.36	0.34	6.8 (15)
1	7100NSR	7100NSRT	1.75	1.63	0.39	10.0 (22)
1-1/4	7125NSR	7125NSRT	2.00	2.07	0.40	16.3 (36)
1-1/2	7150NSR	7150NSRT	2.00	2.31	0.40	18.1 (40)
2	7200NSR	7200NSRT	2.32	2.79	0.41	24.5 (54)
2-1/2	7250NSR	7250NSRT	3.62	3.63	0.65	68.0 (150)
3	7300NSR	7300NSRT	3.75	4.29	0.65	83.9 (185)
3-1/2	7350NSR	7350NSRT	3.85	4.80	0.72	97.5 (215)
4	7400NSR	7400NSRT	3.90	5.27	0.72	108.0 (238)

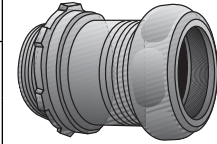

Type 7050NSR – Type 7400NSR

Type 6000NSR Raintight Couplings

Use:
To ground and secure EMT raceway sections together in wet locations.

- Features:**
- UL Listed Raintight
 - No disassembly required
 - Concretetight

- Material/Finish:**
- Steel Body & Nut Zinc Electroplated

Third Party Certification:
 UL Listed: E-14895
 Listed Raintight

Applicable Third Party Standards:
 UL Standard: 514B

Trade Size (Inches)	Catalog Number	Dimensions in Inches		Weight per 100 pcs kgs (lbs)
		Body Length	Maximum Diameter	
1/2	6050NSR	1.80	1.10	5.4 (12)
3/4	6075NSR	1.93	1.36	8.2 (18)
1	6100NSR	2.15	1.63	11.8 (26)
1-1/4	6125NSR	2.43	2.07	19.1 (42)
1-1/2	6150NSR	2.50	2.31	20.9 (46)
2	6200NSR	2.95	2.79	27.2 (60)
2-1/2	6250NSR	4.10	3.63	70.8 (156)
3	6300NSR	4.77	4.29	98.9 (218)
3-1/2	6350NSR	5.15	4.80	117.0 (258)
4	6400NSR	5.55	5.27	130.6 (288)

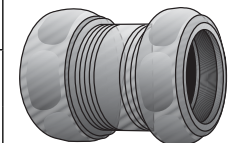

Type 6050NSR – Type 6400NSR