

Watertight Service Entrance & UF Cable Connectors

Type SE

Tapered threaded male hub – NPT

Use:

For securing and sealing service entrance and UF cable entering an enclosure or conduit hub.

Features:

- Tapered male threads (NPT).
- Suitable for use in wet locations.
- Locknuts, Sealing Locknuts and Sealing Ring Assemblies available for use in sheet metal knockouts.

Locknuts - see page DB6.

Sealing Locknuts - see page DB8.

Sealing Ring Assemblies - see page GA4.

Material/Finish:

Body: Malleable Iron, Zinc Electroplated

Grommet: PVC

Compression Washer: Steel-Zinc

Electroplated

Third Party Certification:



UL Listed: E-11858

Applicable Third Party Standards:

UL Standard: 514B

Fed. Spec: W-F-406E

Dimensional Data:

See page NA3 for connector dimensions and cable data.

Connector Selection:** SEU ratings are based upon average dimensions given by various manufacturers of cable. Individual manufacturers vary. Actual dimensions must be checked and proper fittings selected based upon "cable grommet range" column.

Note:

For complete line of Watertight SR Connectors for round cable see Cord Grip Connectors Sections HA, HB.

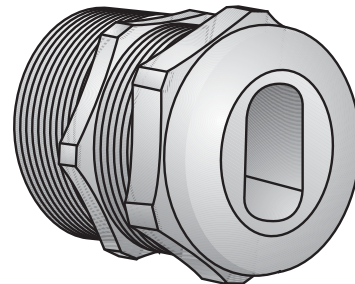

Type SE

Watertight Service Entrance & UF Cable Connectors

Type SE Catalog Numbers & Dimensional Data:

Catalog Number	Hub Size (inches)	**Wire Sizes Oval (Flat) Cables			Type UF Cable	Cable Oval Grommet Range		Dimensions in Inches		
		Type SEU 3 Conductor Braided	Neoprene Jacket	PVC Jacket		Min.	Max.	Body Length	Thread Length	Max. Dia.
SE-501*	1/2 1/2				2#14WG and WO/G	.150 x .325	.250 x .425	1 1/8	1 7/32	1 1/16
					2#12WG and WO/G	.150 x .325	.250 x .425	1 1/8	1 7/32	1 1/16
SE-752*	3/4 3/4 3/4				3#14WG and WO/G	.165 x .575	.290 x .710	1 5/32	7/16	1 3/8
					3#12WG and WO/G	.165 x .575	.290 x .710	1 5/32	7/16	1 3/8
					3#10WG and WO/G	.165 x .575	.290 x .710	1 5/32	7/16	1 3/8
SE-751	3/4	3#10	3#10	3#8		.275 x .475	.400 x .610	1 5/32	7/16	1 3/8
SE-753	3/4 3/4	3#10	3#10	3#8		.335 x .575	.460 x .710	1 5/32	7/16	1 3/8
			3#8	3#6		.335 x .575	.460 x .710	1 5/32	7/16	1 3/8
SE-1001*	1 1 1				3#14WG and WO/G	.140 x .560	.290 x .710	1 1/4	1 7/32	1 5/8
					3#12WG and WO/G	.140 x .560	.290 x .710	1 1/4	1 7/32	1 5/8
					3#10WO/G	.140 x .560	.290 x .710	1 1/4	1 7/32	1 5/8
SE-1002	1 1	3#8	3#8	3#6		.370 x .660	.520 x .810	1 1/4	1 7/32	1 5/8
		3#6	3#6	3#4		.370 x .660	.520 x .810	1 1/4	1 7/32	1 5/8
SE-1003	1 1	3#6	3#6	3#4		.430 x .760	.580 x .910	1 1/4	1 7/32	1 5/8
		3#4	3#4	3#2		.430 x .760	.580 x .910	1 1/4	1 7/32	1 5/8
SE-1004	1 1 1 1	3#4	3#4	3#2		.40 x .860	.640 x 1.01	1 1/4	1 7/32	1 5/8
		3#3	3#3	3#1		.490 x .860	.640 x 1.01	1 1/4	1 7/32	1 5/8
		2#2				.490 x .860	.640 x 1.01	1 1/4	1 7/32	1 5/8
		1#4				.490 x .860	.640 x 1.01	1 1/4	1 7/32	1 5/8
SE-1251	1 1/4 1 1/4 1 1/4	3#4	3#4	3#2		.440 x .810	.640 x 1.01	1 3/8	5/8	1 5/16
		3#3	3#3	3#1		.440 x .810	.640 x 1.01	1 3/8	5/8	1 5/16
		3#2				.440 x .810	.640 x 1.01	1 3/8	5/8	1 5/16
SE-1253	1 1/4 1 1/4 1 1/4	3#3	3#4	3#1		.500 x .910	.700 x 1.11	1 3/8	5/8	1 5/16
		3#2	3#3	3#1/0		.500 x .910	.700 x 1.11	1 3/8	5/8	1 5/16
			3#2			.500 x .910	.700 x 1.11	1 3/8	5/8	1 5/16
SE-1252	1 1/4 1 1/4	3#2	3#2	3#1/0		.550 x 1.01	.750 x 1.21	1 3/8	5/8	1 5/16
		3#1	3#1	3#2/0		.550 x 1.01	.750 x 1.21	1 3/8	5/8	1 5/16
SE-1504	1 1/2 1 1/2	3#2	3#2	3#1/0		.550 x 1.01	.750 x 1.21	1 7/32	5/8	2 1/32
		3#1	3#1	3#2/0		.550 x 1.01	.750 x 1.21	1 7/32	5/8	2 1/32
SE-1505	1 1/2 1 1/2	3#1	3#1	3#2/0		.610 x 1.11	.810 x 1.31	1 7/32	5/8	2 1/32
		3#1/0		3#3/0		.610 x 1.11	.810 x 1.31	1 7/32	5/8	2 1/32
SE-1506	1 1/2 1 1/2	3#1/0	3#1	3#3/0		.660 x 1.21	.860 x 1.41	1 7/32	5/8	2 1/32
		3#2/0	3#1/0	3#4/0		.660 x 1.21	.860 x 1.41	1 7/32	5/8	2 1/32
SE-2006	2 2	3#1/0	3#1	3#3/0		.660 x 1.21	.860 x 1.41	2 1/16	5/8	3
		3#2/0	3#1/0	3#4/0		.660 x 1.21	.860 x 1.41	2 1/16	5/8	3
SE-2007	2 2	3#2/0	3#1/0	3#4/0		.730 x 1.31	.930 x 1.51	2 1/16	5/8	3
		3#3/0	3#2/0			.730 x 1.31	.930 x 1.51	2 1/16	5/8	3
SE-2008	2 2	3#3/0	3#2/0			.820 x 1.41	1.02 x 1.61	2 1/16	5/8	3
		3#4/0	3#3/0			.820 x 1.41	1.02 x 1.61	2 1/16	5/8	3
SE-2009	2	3#4/0	3#3/0			.860 x 1.51	1.06 x 1.71	2 1/16	5/8	3
SE-20010	2		3#4/0			.900 x 1.61	1.10 x 1.81	2 1/16	5/8	3

*Can be used with UF Cable.