

Liquidtight Fittings

Type 4Q - Straight

Use:

To secure, ground and seal Liquidtight Flexible Metal Conduit, Type LFMC, to boxes and enclosures.

Features:

- Tapered threaded male hub NPT
- Compact, slim diameter with small turning radius
- Furnished with locknut and KO sealing ring.
- Liquidtight/Raintight/Oiltight/Concretetight
- UL Listed NEMA Type 4 when installed into a NPT threaded entry or UL Listed conduit hub (sizes 1½" and larger require thread sealant).
- Suitable for grounding through 1¼" Trade Size per NEC Section 250.118(7)
- For Trade Sizes 1¼" and larger, an internal or external equipment bonding conductor is required. See 4Q-L Series with external ground lug in Catalog Section GB.
- Suitable for use in the following Hazardous Locations:
 - Class I, Div. 2 per NEC 501.4(B)
 - Class I, Zone 2 per NEC 505.15(C)(2)
 - Class II, Div. 1 per NEC 502.4(A)(1)(e)
 - Class II, Div. 2 per NEC 502.4(B)(2)
 - Class III, Div. 1 per NEC 503.3(A)(2)
 - Class III, Div. 2 per NEC 503.3(B)
- Intrinsically Safe per NEC 504.20
- Bonding Wedge Locknuts are recommended in Hazardous Locations. See 101 Series on Page DB8.
- Suitable for wet locations
- Long ferrule prevents pullout and tight bend conduit "pop-out"
- Reusable ferrule
- Inspection windows in ferrule to ensure full engagement
- See Page GC4 for our patented Ferrule Wrench which makes ferrule installation easy.

Material/Finish:

Malleable Iron Body and Nut, Zinc Electroplated. Steel Ferrule, Zinc Electroplated.

Optional Finish:

Available Hot Dip/Mechanically Galvanized, See 4Q-TG Series in Catalog Section GC.

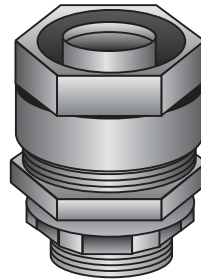

Type 4Q-38 — Type 4Q-200

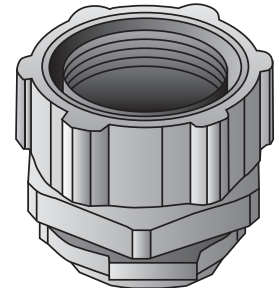

Type 4Q-250 — Type 4Q-600

Trade Size (inches)	Catalog Number	Insulated Throat Catalog Number	Dimensions in Inches		
			A	B	C
⅜ (½ KO)	4Q-38	4Q-38T	1	½	1⅝
½	4Q-50	4Q-50T	1	½	1¼
¾	4Q-75	4Q-75T	1⅝	½	1½
1	4Q-100	4Q-100T	1¼	⅝	1¾
1¼	4Q-125	4Q-125T	1⅝	⅝	2½
1½	4Q-150	4Q-150T	1⅝	⅝	2¾
2	4Q-200	4Q-200T	1½	⅝	3¼
2½	4Q-250	4Q-250T	2	1	4⅝
3	4Q-300	4Q-300T	2	1⅝	4⅞
3½	4Q-350	4Q-350T	2¼	1¼	4⅞
4	4Q-400	4Q-400T	2¼	1¼	6⅝
5	4Q-500*	4Q-500T*	2⅝	1⅝	7⅝
6	4Q-600*	4Q-600T*	2½	1⅝	8⅝

*UL Listing not applicable
*CSA Certification not applicable

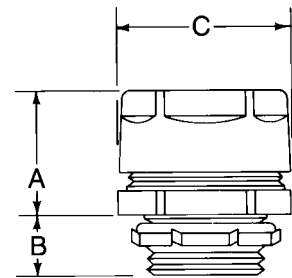

Third Party Certification:

 UL Listed: 11853

 CSA Certified: 009795

Applicable Third Party Standards:

UL Standard: 514B
CSA Standard: C22.2 No. 18
NEMA: FB-1
Federal Spec: W-F-406E