

# 90° Bushed & 90° Corner Pull-in Conduit Elbows

Threaded For Rigid Conduit & IMC

## Type 9

### Features:

- Available with insulated throat
- Threaded for rigid conduit, Female NPT Male NPS
- Telephone elbow, floor outlet fittings

### Material/Finish:

Malleable Iron/Zinc Electroplated

### Optional Finish:

For additional corrosion protection, specify Mechanically Galvanized.  
Contact your local representative for pricing and availability.

### Third Party Certification:

 UL Listed: E-11853 and 11857

 CSA Certified: 009795

### Applicable Third Party Standards:

UL Standard: 514B

CSA Standard: C22.2 No. 18

Fed. Spec: W-F-408E

ANSI/NEMA: FB-1

Trade Size (inches)	Catalog Number	Insulated Throat Catalog Number	Dimensions in Inches		
			A	B	C
1/2	9-50	9-50T	1 1/8	1 7/8	1 1/16
3/4	9-75	9-75T	2 15/16	2 3/16	3/4
1	9-100	9-100T	2 1/2	2 1/2	1 3/16
1 1/4	9-125	9-125T	3	3	7/8

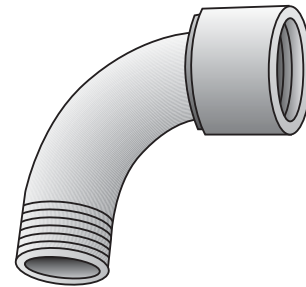

Type 9

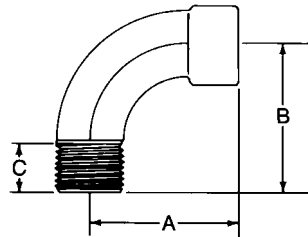

## Type CE

### Material/Finish:

Malleable Iron/Zinc Electroplated

### Third Party Certification:

 UL Listed: E-11853

### Applicable Third Party Standards:

UL Standard: 514B

NEMA: FB-1

Trade Size (inches)	Catalog Number	Dimensions in Inches	
		A	B
1/2	CE-050	2 1/2	2
3/4	CE-075	2 3/4	2 1/8
1	CE-0100	3 1/4	2 3/8

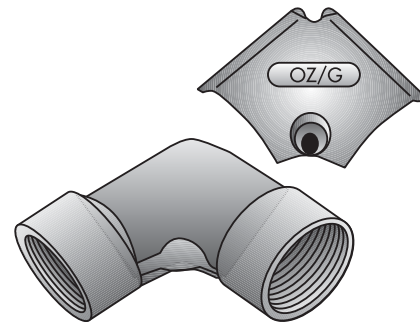

Type CE

