

# Ground-Tite® 4Q Liquidtight Combination Couplings

**NEC/CEC — Suitable for use in the following Hazardous Locations:**  
 Class I, Division 2 per NEC 501.10(B)(4)  
 Class I, Zone 2 per NEC 505.15(C)(2)  
 Class II, Division 1 per NEC 502.10(A)(2)(2)  
 Class II, Division 2 per NEC 502.10(B)(2)

**NEC/CEC — Suitable for use in the following Hazardous Locations:**  
 Class III, Division 1 per NEC 503.10(A)(3)(2)  
 Class III, Division 2 per NEC 503.10(B)  
 Intrinsically Safe per NEC 504.20

## Applications

- Secures, grounds and seals liquidtight flexible metal conduit and terminates bonding conductor run externally alongside liquidtight conduit to threaded rigid conduit and IMC.

## Features

- Positive grounding type.
- Liquidtight flexible metal conduit to threaded rigid conduit and IMC.
- Female hub— NPT.
- Grounding lug is cast as an integral part of malleable iron gland nut. Provides high ground fault withstand capability.
- Compact, slim diameter with small turning radius.
- Furnished with locknut and KO sealing ring.
- Liquidtight/Raintight/Oiltight/Concretetight.
- UL Listed NEMA Type 4 when installed in a NPT threaded entry or UL Listed conduit hub (sizes 1-1/4" and larger require thread sealant).
- Long ferrule prevents pull-out and tight bend conduit "pop-out".
- Inspection windows in ferrule to ensure full engagement.

## Standard Materials

- Malleable iron body and nut
- Steel ferrule

## Standard Finishes

- Zinc electroplated

## Options

- Hot dip or mechanical galvanize, add suffix **-G** to catalog number. Contact your local representative for pricing and availability.

## NEC/CEC Certifications and Compliances

- UL Listed: E-24264
- CSA Certified: 9795

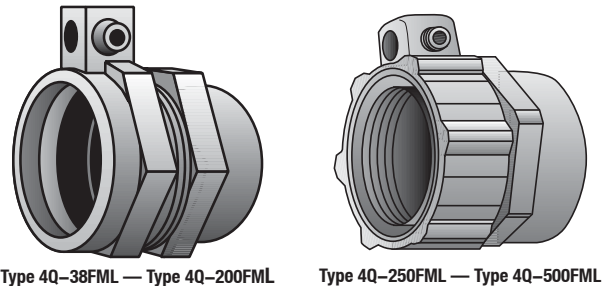

## Illustrated Dimensions

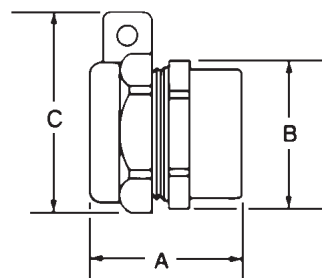

Trade Size (Inches)	Dimensions in Millimeters (Inches)			Turning Radius Gland Nut	Wire Size		Catalog Number
	A	B	C		Min.	Max.	
3/8 (1/2 KO)	39.62 (1.56)	30.23 (1.19)	42.93 (1.69)	28.70 (1.13)	14	4	4Q-38FML
1/2	35.05 (1.38)	33.27 (1.31)	47.75 (1.88)	30.23 (1.19)	14	4	4Q-50FML
3/4	36.58 (1.44)	39.62 (1.56)	54.10 (2.13)	33.27 (1.31)	14	4	4Q-75FML
1	41.40 (1.63)	45.97 (1.81)	60.45 (2.38)	36.58 (1.44)	14	4	4Q-100FML
1-1/4	50.80 (2.00)	58.67 (2.31)	73.15 (2.88)	44.45 (1.75)	6	1/0	4Q-125FML
1-1/2	52.32 (2.06)	65.02 (2.56)	82.55 (3.25)	47.75 (1.88)	6	1/0	4Q-150FML
2	55.63 (2.19)	81.03 (3.19)	95.25 (3.75)	55.63 (2.19)	6	1/0	4Q-200FML
2-1/2	81.03 (3.19)	98.55 (3.88)	117.60 (4.63)	69.85 (2.75)	1	4/0	4Q-250FML
3	85.85 (3.38)	117.60 (4.63)	134.87 (5.31)	77.72 (3.06)	1	4/0	4Q-300FML
3-1/2	98.55 (3.88)	134.87 (5.31)	149.35 (5.88)	85.85 (3.38)	1	4/0	4Q-350FML
4	93.73 (3.69)	146.05 (5.75)	165.10 (6.50)	92.20 (3.63)	1	4/0	4Q-400FML
5	98.55 (3.88)	162.05 (6.38)	190.50 (7.50)	106.43 (4.19)	1	4/0	4Q-500FML ①

① UL Listing not applicable.