

**MIDWEST ELECTRIC PRODUCTS, INC**

# **AIR CONDITIONING DISCONNECTS**

## **Metallic & Non-Metallic**



**QUALITY WEATHERPROOF  
ELECTRICAL EQUIPMENT**





# A/C DISCONNECTS



P065P1

## APPLICATION INFORMATION

Article 440 of the National Electrical Code applies to electric motor-driven air conditioning and refrigerating equipment, and to the branch circuits and controllers for such equipment. It provides for the special considerations necessary for circuits supplying hermetic refrigerant motor-compressors and for any air conditioning and/or refrigerating equipment that is supplied from an individual branch circuit that supplies a hermetic refrigerant motor-compressor.

## FEATURES AND BENEFITS

### Flexibility

- 30-100 amperes
- 240 volts A.C.
- 1 Phase and 3 Phase fusible and non-fusible
- Horsepower rated
- 10,000 A.I.C.
-  LISTED

### Rugged Durability

- Noryl<sup>®</sup> thermoplastic enclosure utilized in non-metallic models is corrosion resistant and extremely durable, giving long maintenance free service
- Metallic models are made of heavy (G90) zinc coated galvanized steel with electro-deposition finish to resist corrosion and fading

### User Safety

- Door has padlock provisions to prevent unauthorized access

### Installation Ease

- Removable cover on all metallic models
- Three piece construction that opens up mounting and wiring areas, reduces installation time
- Terminals approved for 60°C and 75°C wire, accepts solid 14-8 copper, 12-8 aluminum or stranded 14-3 copper, 12-3 aluminum
- Numerous knockouts reduce installation time
- Straight-in, straight-out wiring saves time and money

### Air Conditioner Disconnect Selection Guide

Existing Branch Circuit Protection	Sight Disconnect Selection
Fusible*	Non-Fusible or Fusible
Circuit Breaker	Fusible
HACR**	Non-Fusible or Fusible

\*See Air Conditioner nameplate for correct selection.

\*\*HACR = Heating, Air Conditioning, Refrigeration Type Circuit Breaker

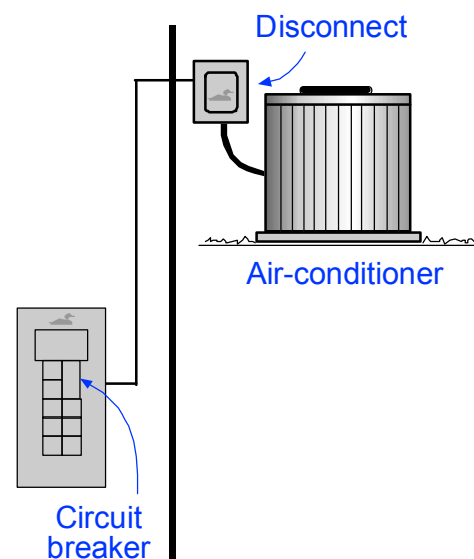



# Featured Models\*\*

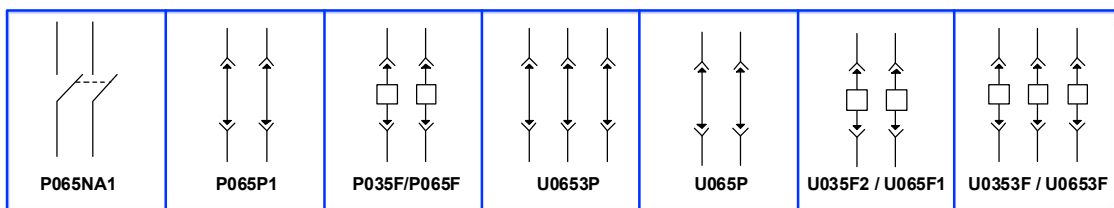

= Accepts Class H Fuses (Fuses Not Included)

## Non Metallic – Non-Fusible Disconnects

Non-fusible disconnect pullers are removable or reinstallable in the OFF position for user safety during equipment maintenance.

UL	MODEL NUMBER	CIRCUIT PROTECTION	AMP	VOLTS	HORSE POWER RATING	WIRE RANGE*	CABINET SIZE*	UNIT WT.	STD. PKG.
Y	<b>P065P1</b>	NF65	60	240	10	D	5 X 7	2	6
Y	<b>P065NA1</b>	SWITCH ONLY	60	240	10	D	5 X 7	2	6
Y	<b>P065P</b>	NF65	60	240	10	D	6 X 8	2	6

## Non Metallic – Fusible Disconnects

Fusible disconnects are available in 30 and 60 Ampere models. Pullers are removable or reinstallable in the OFF position for user safety during equipment maintenance. The P065F UL listing includes the ability to field replace the 60 Ampere puller with a 30 Ampere puller (FR352) for installation flexibility. Listed for use as service entrance.

UL	MODEL NUMBER	CIRCUIT PROTECTION	AMP	VOLTS	HORSE POWER RATING	WIRE RANGE*	CABINET SIZE*	UNIT WT.	STD. PKG.
Y	<b>P035F</b>	FR39	30	240	3	D	6 X 8	2	6
Y	<b>P065F</b>	FR69	60	240	10	D	6 X 8	2	6

## Metallic – Non-Fusible Disconnects - Single & Three Phase

Non-fusible disconnect pullers are removable or reinstallable in the OFF position for user safety during equipment maintenance.

UL	MODEL NUMBER	PHASE	CIRCUIT PROTECTION	AMP	VOLTS	HORSE POWER RATING	WIRE RANGE*	CABINET SIZE*	UNIT WT.	STD. PKG.
Y	<b>U065P</b>	1	NF65	60	240	10	D	5 X 7	3	6
Y	<b>U0653P</b>	3	NF653	60	240	7.5-15	D	6 X 14	10	1
Y	<b>U065PD</b>	1	NF653	60	240	10	D	6 X 14	10	1

## Metallic – Fusible Disconnects - Single & Three Phase

Fusible disconnects are available in 30 and 60 Ampere models. Pullers are removable or reinstallable in the OFF position for user safety during equipment maintenance. Listed for use as service entrance.

UL	MODEL NUMBER	PHASE	CIRCUIT PROTECTION	AMP	VOLTS	HORSE POWER RATING	WIRE RANGE*	CABINET SIZE*	UNIT WT.	STD. PKG.
Y	<b>U035F2</b>	1	FR35R	30	240	3	D	5 X 9	4	6
Y	<b>U065F1</b>	1	FR65	60	240	10	D	5 X 9	4	6
Y	<b>U0353F</b>	3	FH393	30	240	3-7.5	D	6 X 14	10	1
Y	<b>U0653F</b>	3	FH693	60	240	7.5-15	D	6 X 14	10	1

\* See back page for details

Data Subject To Change Without Notice

\*\* Additional Basic And Custom Models Available, Consult Manufacturing Representative For Further Details



# Featured Models\*\*

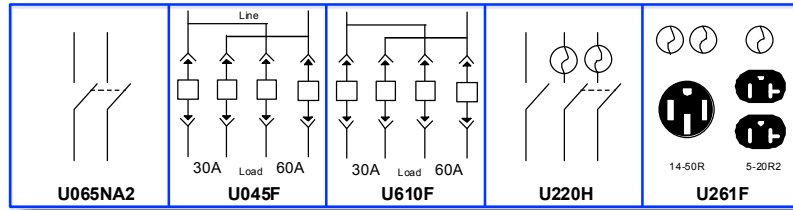

⊙ = Edison Plug Fuse Base (Fuses Not Included)  
 □ = Accepts Class H Fuses (Fuses Not Included)

## Non-Automatic Disconnect Switch

UL	MODEL NUMBER	PHASE	CIRCUIT PROTECTION	AMP	VOLTS	HORSE POWER RATING	WIRE RANGE*	CABINET SIZE*	UNIT WT.	STD. PKG.
Y	U065NA1	1	Switch Only	60	240	10	D	5 X 7	4	6
Y	U065NA2	1	Switch Only	60	240	10	D	7 X 10	4	6

## Heat Pump – Fusible Disconnects

Multiple disconnect devices are offered for heat pump applications that require individual disconnects for the heating and cooling cycles. All pullers are removable or reinstallable in the OFF position for user safety during equipment maintenance. Their UL listing includes the ability to field replace the 60 Ampere puller in the left fuse block with a 30 Ampere puller (FH35-2) for installation flexibility but prohibits the interchangeability of pullers between fuse blocks to insure the proper fuse/puller combination is always reinstalled into the proper fuse block.

UL	MODEL NUMBER	CIRCUIT PROTECTION	AMP	VOLTS	HORSE POWER RATING	WIRE RANGE*	CABINET SIZE*	UNIT WT.	STD. PKG.
Y	U045F	FR35XFR67	90	120/240	10	Y	9 X 17	14	1
Y	U610F	FR69	100	120/240	10	Y	9 X 17	14	1

## Evaporative Cooler – Fusible Disconnects

Evaporative cooler applications not only require fusing but switching or receptacle functions depending on equipment type and local codes. Two models are offered to meet these varied evaporative cooler applications.

UL	MODEL NUMBER	RECEPTACLES	CIRCUIT PROTECTION	AMP	VOLTS	HORSE POWER RATING	WIRE RANGE	CABINET SIZE	NEUTRAL BAR	UNIT WT.	STD. PKG.
N	U220H	DPST SWITCH SPST SWITCH	(2) FH1	20	120/240	—	AR	5 X 7	—	4.5	4
Y	U261F	14-20R 5-20R2	(3) FH1	40	120/240	—	E	6 X 9	—	6.5	4



\* See back page for details

Data Subject To Change Without Notice

\*\* Additional Basic And Custom Models Available, Consult Manufacturing Representative For Further Details

# Technical Information

MODEL NUMBER	REPLACEMENT PARTS			ENCLOSURE STYLE	CABINET DIMENSIONS				KO DETAIL
	COMPLETE BLOCK & PULLER	FUSE BLOCK ONLY	PULLER ONLY		HEIGHT A	WIDTH B	DEPTH C	DEPTH D	
P035F	FR39	—	FR352	FIG. C	8"	5-3/4"	3-1/8"	—	FIG. 1
P065F	FR69	—	FH682	FIG. C	8"	5-3/4"	3-1/8"	—	FIG. 1
P065P	—	NF65	NF652	FIG. F	8"	6"	5-3/4"	2-3/4"	FIG. 2
P065P1	—	NF65	NF652	FIG. F	7-1/4"	5"	2-1/8"	2-3/4"	FIG. 2
U035F2	—	FR35R	FR352R	FIG. A	7-1/4"	5"	2-1/8"	2-3/4"	FIG. 2
U0353F	FBP353	—	—	FIG. B	14-3/8"	7-1/4"	5-3/16"	—	FIG. 3
U045F	FR35XFR67	—	FR352 FH682	FIG. B	17-3/8"	9-3/4"	5-3/16"	—	FIG. 4
U0653F	FBP653	—	—	FIG. B	14-3/8"	7-1/4"	5-3/16"	—	FIG. 3
U0653P	NFBP653	—	—	FIG. B	14-3/8"	7-1/4"	5-3/16"	—	FIG. 3
U065F1	FR65	—	FH682	FIG. A	9"	5"	2-1/8"	2-3/4"	FIG. 2
U065NA1	NF65NA1	—	—	FIG. F	7-1/4"	5"	2-1/8"	2-3/4"	FIG. 2
U065NA2	NF65NA1	—	—	FIG. E	10"	7-1/2"	4"	—	FIG. 5
U065P	—	NF65	NF652	FIG. A	7-1/4"	5"	2-1/8"	2-3/4"	FIG. 2
U220H	—	FH1	—	FIG. B	7-1/8"	5-3/4"	5-3/16"	—	FIG. 5
U261F	—	FH1	—	FIG. B	9-1/8"	7-1/4"	5-3/16"	—	FIG. 3
U610F	FR67X2	—	FH682	FIG. B	17-3/8"	9-3/4"	5-3/16"	—	FIG. 4

## Wire Range Tables

**TABLE D**

	Copper		Aluminum	
Connector	Solid	Strand	Solid	Strand
Line	14-8	14-3	12-8	12-3
Load	14-8	14-3	12-8	12-3
Neutral	----	----	----	----
Equip. Grnd.	12-8	12-2	12-8	12-2

**TABLE Y**

	Copper		Aluminum	
Connector	Solid	Strand	Solid	Strand
Line	14-8	14-1/0	12-8	12-1/0
Load	14-8	14-2	12-10	12-2
Neutral	14-8	14-1/0	12-8	12-1/0

**TABLE E**

	Copper		Aluminum	
Connector	Solid	Strand	Solid	Strand
Line	14-10	14-10	----	----
Load	14-10	14-10	----	----
Neutral	14-10	14-10	----	----
Equip. Grnd.	12-8	12-2	----	----

**TABLE AR**

	Copper		Aluminum	
Connector	Solid	Strand	Solid	Strand
Line	14-10	14-10	----	----
Load	14-10	14-10	----	----
Neutral	----	----	----	----
Equip. Grnd.	12-8	12-2	----	----

# Technical Information

## Dimensions

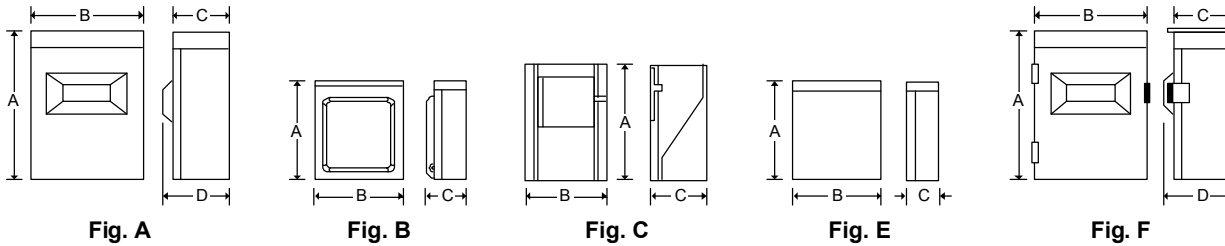

## Knockouts

- B= 1", 1-1/4", 1-1/2"
- D= 3/4", 1", 1-1/4"
- G= 1/2", 3/4", 1"
- L= 1/2", 3/4"
- M= 1/2", 3/4", 1", 1-1/4"
- N= 1/2", 3/4", 1", 1-1/4", 1-1/2"
- W= 3/4", 1"
- Y= 1", 1-1/4"

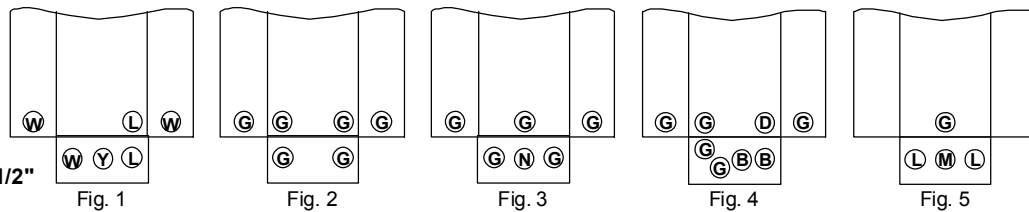

## Also Available:

### A/C Combination Disconnects

Midwest Electric Products offers a wide variety of combination A/C Disconnects with GFCI or non-GFCI receptacles.



Refer to the General Catalog or brochure MEPF-AC04.

### Exterior Mounting Bracket

**STC1** - Exterior Mounting Bracket for Single-Phase AC & AC/GFI Disconnects in aluminum, vinyl siding, and stucco applications. Order quantity in multiples of six.

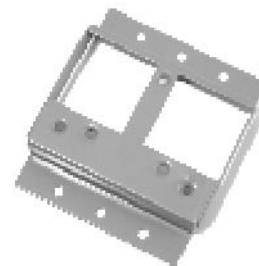

# Midwest Powers the Great Outdoors

©2004, Midwest Electric Products, Inc  
 PO Box 910, Mankato, MN 56001  
 (507)345-2505, (507)345-2530 FAX

[www.midwestelectric.com](http://www.midwestelectric.com)  
[customerservice@midwestelectric.com](mailto:customerservice@midwestelectric.com)

