



## Wet Location 360° Motion Sensor

### ELECTRICAL:

- **Input Voltage:** 120/277/347 VAC
- **Operational Frequencies:** 50/60Hz
- **Wire Designation:** Line-Black, Load-Red, Neutral-White
- **Load Rating:**

800VA @ 120VAC	} Ballast/Driver
1200VA @ 277VAC	
1500VA @ 347VAC	
- **Mounted:** 1/4 HP Motor Load @ 120V

### ENVIRONMENTAL:

- **Operating Temperature Range:** -40°F to 158°F (-40° C to 70°C)
- **For use in wet location environments (IP65)**
- **Operating Humidity:** 20% to 90% non-condensing
- **IP65 Rated**

### CONSTRUCTION:

- **High-impact Housing**
- **Injection Molded Plastic**

### OPTICAL:

- **Two interchangeable lenses** (HB Applications, LB Applications)
- **Lenses sealed and gasketed**
- **Lens choices for mounting between 20 and 40 feet**

### SPECIFICATIONS:

- **Overall height:** 4.48" (11.37 cm)
- **Width:** 4.09" (10.38 cm)
- **Depth:** 1.94" (4.92 cm)
- **Color:** White
- **Listings:** UL and cUL, Photoelectric Switch, CEC Title 24 Compliant

### CONTROLS:

- **Timer Setting:** 30 seconds - 20 minutes

### RANGE AND COVERAGE:

- **LB** - 10' to 24' mounting height, 24' in diameter coverage at 20' height.
- **HB** - 20' to 40' mounting height, 68' in diameter coverage at 40' height.

### COVERAGE:

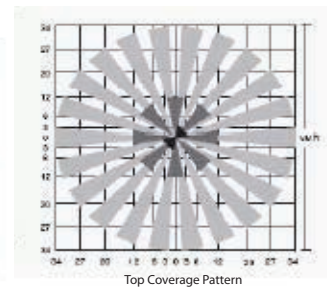
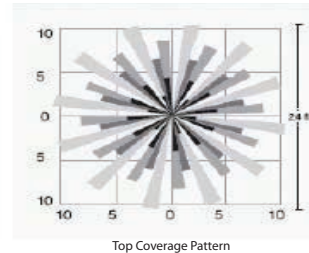
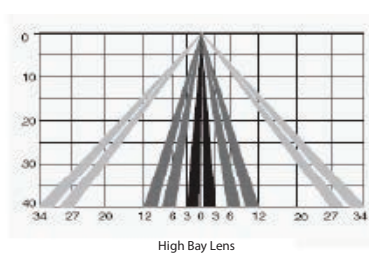
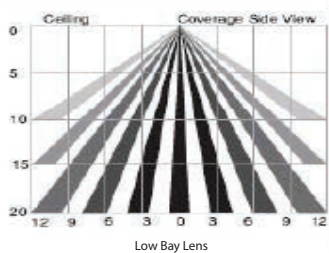

Project Information	
Job Name	
Catalog Number	MS360WL
Approved by	



### DIMENSIONS

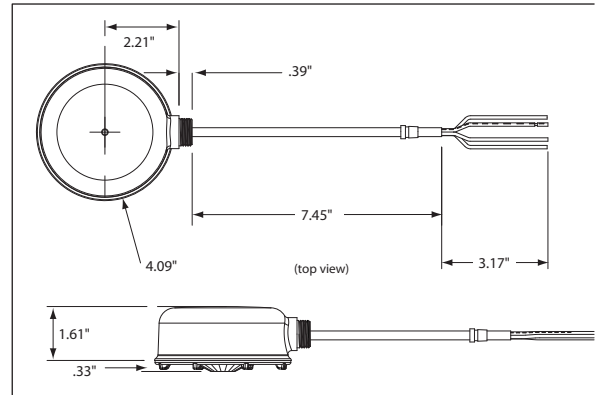

### ORDERING INFORMATION

Catalog #	Description	Std. Pkg.
MS360WL	Wet Location 360° Motion Sensor (Standard with LB Lens)	1
MS360WL-HB	Wet Location 360° Motion Sensor w/ HB Lens	1

## ATLAS LIGHTING PRODUCTS, INC.

PO BOX 2348 | BURLINGTON, NC 27216  
 800-849-8485 | FAX: 336-227-0110 | www.atlaslightingproducts.com

**SPECIFICATIONS:**

- Overall height: 4.48" (11.37 cm)
- Width: 4.09" (10.38 cm)
- Depth: 1.94" (4.92 cm)

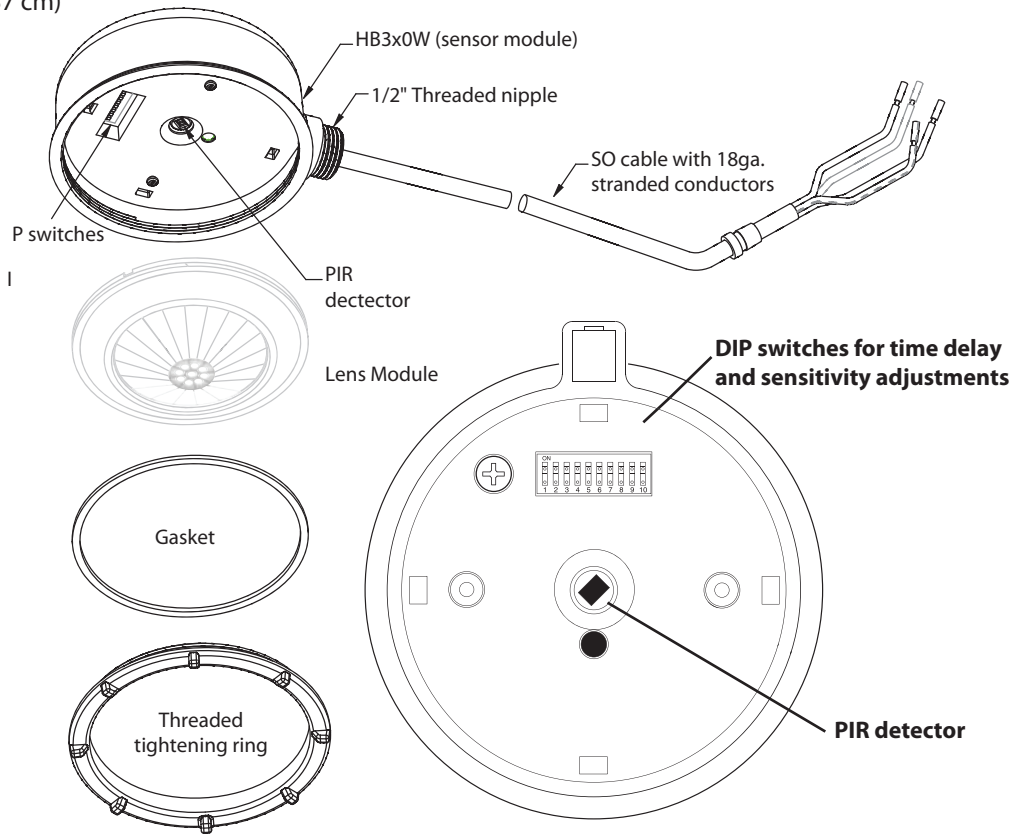

**MOUNTING DETAIL**

