



44 MAGNUM™ CARBIDE

HEAVY-DUTY SPLINE AND SDS-MAX HAMMER ACCESSORIES

4-CUTTER ROTARY HAMMER BITS FOR SDS-max AND SPLINE

20% longer life, faster penetration, improved ergonomics, and improved drilling efficiency! Provides lower "cost per drilled hole."



FLUTE DESIGN:

- Optimizes hammer energy transfer for less strenuous drilling
- Optimizes dust removal when working vertically
- Minimizes friction prolonging bit life

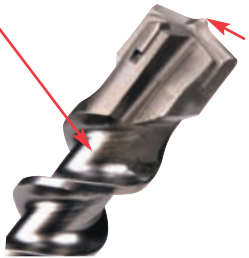

CENTERING POINT:

- Allows more accurate starting of holes

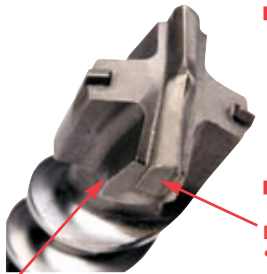

4-CUTTER HEAD DESIGN:

- Provides precise, round holes
- Reduces vibration

BRAZING FORMULA:

- Optimizes drilling performance for up to 20% longer life

SHORTER DUST ENTRANCE GROOVE ANGLES AND ANGLE:

- Gets dust to flutes for faster evacuation



SPLINE SHANK

Use in Spline Drive rotary hammers. These bits are for use in any kind of concrete.



2 CUTTER



4 CUTTER

DESCRIPTION
DIA. X U.L. X O.L.
(INCHES)

3/8 X 5 X 10	48-20-4037	-
1/2 X 5 X 10	48-20-4050	-
1/2 X 11 X 16	48-20-4051	-
1/2 X 17 X 22	48-20-4052	-
1/2 X 22 X 27	48-20-4053	-
1/2 X 31 X 36	48-20-4054	-
9/16 X 5 X 10	48-20-4056	-
9/16 X 18 X 23	48-20-4057	-
5/8 X 5 X 10	48-20-4062	48-20-4300
5/8 X 11 X 16	48-20-4063	48-20-4305
5/8 X 17 X 22	48-20-4064	48-20-4310
5/8 X 24 X 29	-	48-20-4315
5/8 X 31 X 36	-	48-20-4320
11/16 X 11 X 16	48-20-4068	48-20-4325
3/4 X 5 X 10	48-20-4075	48-20-4330
3/4 X 11 X 16	48-20-4076	48-20-4335
3/4 X 17 X 22	48-20-4078	48-20-4340
3/4 X 24 X 29	-	48-20-4345
3/4 X 31 X 36	-	48-20-4350
13/16 X 11 X 16	48-20-4081	-
7/8 X 11 X 16	48-20-4087	48-20-4360
7/8 X 17 X 22	48-20-4088	48-20-4365
1 X 11 X 16	48-20-4100	48-20-4370
1 X 17 X 22	48-20-4101	48-20-4375
1 X 31 X 36	-	48-20-4380
1-1/8 X 11 X 16	48-20-4112	48-20-4385
1-1/8 X 17 X 22	48-20-4113	48-20-4390
1-1/4 X 11 X 16	48-20-4125	48-20-4395
1-1/4 X 17 X 22	48-20-4126	48-20-4400
1-1/4 X 31 X 36	-	48-20-4405
1-3/8 X 11 X 16	48-20-4137	-
1-3/8 X 17 X 22	48-20-4138	48-20-4410
1-1/2 X 11 X 16	48-20-4150	-
1-1/2 X 17 X 22	48-20-4151	48-20-4415
1-3/4 X 18 X 23	-	48-20-4418
2 X 18 X 23	-	48-20-4419



SDS-max SHANK

Use in SDS-max Drive rotary hammers. These bits are for use in any kind of concrete.



2 CUTTER



4 CUTTER

DESCRIPTION
DIA. X U.L. X O.L.
(INCHES)

1/2 x 7-1/2 x 13	48-20-3902	-
1/2 x 15-1/2 x 21	48-20-3904	-
9/16 x 7-1/2 x 13	48-20-3910	-
9/16 x 15-1/2 x 21	48-20-3912	-
5/8 x 7-1/2 x 13	-	48-20-3916
5/8 x 15-1/2 x 21	-	48-20-3918
5/8 x 30-1/2 x 36	-	48-20-3922
11/16 x 15-1/2 x 21	-	48-20-3926
3/4 x 8 x 13	-	48-20-3930
3/4 x 17 x 21	-	48-20-3932
3/4 x 31 x 36	-	48-20-3936
13/16 x 17 x 21	-	48-20-3938
7/8 x 8 x 13	-	48-20-3944
7/8 x 17 x 21	-	48-20-3946
1 x 8 x 13	-	48-20-3952
1 x 17 x 21	-	48-20-3954
1 x 31 x 36	-	48-20-3956
1-1/16 x 18 x 23	-	48-20-3958
1-1/8 x 12 x 17	-	48-20-3964
1-1/8 x 17 x 21	-	48-20-3966
1-3/16 x 18 x 23	-	48-20-3968
1-1/4 x 10 x 15	-	48-20-3970
1-1/4 x 18 x 23	-	48-20-3972
1-1/4 x 31 x 36	-	48-20-3974
1-3/8 x 18 x 23	-	48-20-3980
1-7/16 x 18 x 23	-	48-20-3984
1-1/2 x 18 x 23	-	48-20-3988
1-9/16 x 18 x 23	-	48-20-3990
1-5/8 x 18 x 23	-	48-20-3991
1-3/4 x 18 x 23	-	48-20-3992
2 x 18 x 23	-	48-20-3993

HEAVY-DUTY CARBIDE-TIPPED CORE BITS

	DIAMETER	DRILLING DEPTH	CORE BODY W/ GUIDE PLATE & CENTERING PIN	SPLINE ADAPTER SHANKS 12" LONG	SPLINE ADAPTER SHANKS 18" LONG	SDS-max ADAPTER SHANKS 12" LONG	SDS-max ADAPTER SHANKS 18" LONG	EXTENSION 7-1/2" LONG	REPLACEMENT GUIDE PLATE	REPLACEMENT CENTERING PIN
THICK WALL CARBIDE-TIPPED CORE BITS	1-1/2"	4-1/16"	48-20-5125	48-03-3564	48-03-3565	48-03-3572	48-03-3573	48-95-6085	48-20-5168	48-20-5199
	1-3/4"	4-1/16"	48-20-5130	48-03-3564	48-03-3565	48-03-3572	48-03-3573	48-95-6085	48-20-5169	48-20-5199
	2"	4-1/16"	48-20-5135	48-03-3564	48-03-3565	48-03-3572	48-03-3573	48-95-6085	48-20-5170	48-20-5199
	2-1/2"	4-1/16"	48-20-5140	48-03-3564	48-03-3565	48-03-3572	48-03-3573	48-95-6085	48-20-5171	48-20-5199
	3"	4-1/16"	48-20-5145	48-03-3564	48-03-3565	48-03-3572	48-03-3573	48-95-6085	48-20-5172	48-20-5199
	3-1/2"	4-1/16"	48-20-5150	48-03-3564	48-03-3565	48-03-3572	48-03-3573	48-95-6085	48-20-5173	48-20-5199
	4"	4-1/16"	48-20-5155	48-03-3564	48-03-3565	48-03-3572	48-03-3573	48-95-6085	48-20-5174	48-20-5199
5"	4-1/16"	48-20-5160	48-03-3564	48-03-3565	48-03-3572	48-03-3573	48-95-6085	48-20-5175	48-20-5199	
6"	4-1/16"	48-20-5165	48-03-3564	48-03-3565	48-03-3572	48-03-3573	48-95-6085	48-20-5176	48-20-5199	
THIN WALL CARBIDE TIPPED CORE BITS	5"	2-13/16"	48-20-5060	48-03-3540	-	48-03-3574	-	48-95-6075	48-20-6162	48-20-6155
	6"	2-13/16"	48-20-5065	48-03-3540	-	48-03-3574	-	48-95-6075	48-20-6163	48-20-6155