



ER Collet Chucks

- Completely interchangeable with all ISO Compliant ER Collets
- Produced according to AT3 specifications
- Collet seat taper T.I.R. < .0002"
- Made of alloy forged steel for a long durable service life
- Through spindle coolant capability
- Hardened to RC 52-56 and ground to ensure maximum accuracy
- For Individual ER Collets see pages 198-199
- Draw Bar Threads:

BT 30	M12 x 1.75
BT 40	M16 x 2
BT 50	M24 x 3

Regular Length

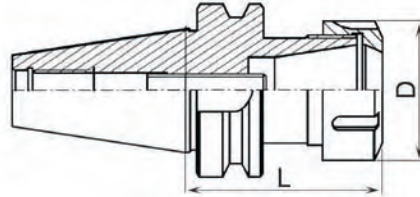

ER 11 and ER 16 are provided with hex nut

Type 7626

Taper Size	Part Number	Balanced 15000 RPM G6.3 PartNumber	Collet Type	Clamping Range	L	D	Nut Part Number	Wrench Part Number		
									inches	
BT 30	7-178-311	—	ER 11	.019 to .275	2.00	0.75	7-188-811	7-188-911		
	7-178-312	—			4.00	0.75				
	7-178-320	—	ER 20	.039 to .511	2.50	1.38			7-188-821	7-188-916
	7-178-325	—	ER 25	.039 to .629	2.00	1.65			7-188-825	7-188-925
	7-178-332	—	ER 32	.078 to .787	3.00	1.97			7-188-832	7-188-932
BT 40	—	7-178-014	ER 16	1/32 to 25/64	3.55	1.10	7-178-816	7-178-916		
	7-178-425	7-178-025	ER 25	.047 to .625	2.36	1.65	7-188-825	7-188-925		
	7-178-432	7-178-032	ER 32	1/8 to 3/4	2.75	2.00	7-188-832	7-188-932		
	7-178-434	7-178-042			4.00					
	7-178-436	—			6.00					
	7-178-442	—	ER 40	1/8 to 1	2.75	2.50	7-188-840	7-180-930		
	7-178-444	—			4.00					
	7-178-446	—			6.00					
	7-178-449	—			2.75				2.50	
BT 50	7-178-532	7-178-132	ER 32	1/8 to 3/4	2.75	2.00	17 Piece Set	17 Piece Set		
	7-178-542	7-178-142	ER 40	1/8 to 1	3.15	2.50	7-188-832	7-188-932		
	7-178-549	—					7-188-840	7-180-930		

ER 20 - ER 40



17 Piece ER Collet Chuck Set



Extension Type

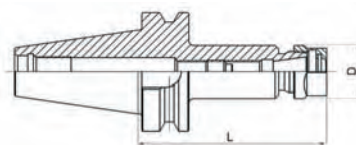

Type 7626-5

Taper Size	Part Number	Collet Type	Clamping Range	L	D	Nut Part Number	Wrench Part Number
BT 30	7-178-316	ER 16	.019 to .406	2.36	1.26	7-178-816	7-178-916
	7-178-317			4.00			
BT 40	7-178-414	ER 16	.031 to .391	3.94	1.10		
	7-178-416			5.91			
BT 50	7-178-514	ER 16	.031 to .391	3.94			
	7-178-516			5.91			

ER 11 - ER 16

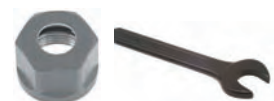



ER Collet Chucks and Collet Chuck Sets

- All collet chucks come with a nut
- Wrenches sold separately

Each set includes:

- Collet Chuck
- Collets
- 1 Wrench
- 1 Nut
- Wooden case



English

Collet Type	Chuck Part Number	Set Part Number	Shank Size	Overall Length	Collet Sizes	Nut Part Number	Wrench Part Number
ER 11	7-171-1105	7-171-1115	1/2	6.2	1/32, 1/16, 3/32, 1/8, 3/16, 7/32, 1/4	7-171-951	7-171-961
	7-171-1106	7-171-1116	5/8				
ER 16	7-171-1606	7-171-1616	5/8	6.0	1/8, 3/16, 7/32, 1/4, 5/16, 11/32, 3/8	7-171-966	7-171-976
	7-171-1607	7-171-1617	3/4	6.5			
ER 20	7-171-2007	7-171-2017	3/4	5.5	1/8, 3/16, 7/32, 1/4, 5/16, 11/32, 3/8, 13/32, 7/16, 1/2	7-188-821	7-171-982
	7-171-2009	7-171-2019	1				
ER 25	7-171-2303	7-171-2313	3/4	6.5	1/8, 3/16, 7/32, 1/4, 5/16, 11/32, 3/8, 13/32, 7/16, 1/2, 17/32, 9/16	7-188-825	7-188-925
	7-171-2305	7-171-2315	1				
ER 32	7-171-3008	7-171-3108	R8	6-1/4	1/8, 3/16, 1/4, 5/16, 3/8, 7/16, 1/2, 9/16, 5/8, 11/16, 3/4	7-188-832	7-188-932
	7-171-303	7-171-313	NMTB 30	5-1/16			
	7-171-304	7-171-314	NMTB 40	6-1/16			
	7-171-3003	7-171-3103	MT-3				
	7-171-3001	7-171-3101	1	3-3/4			
ER 40	7-171-4008	7-171-4108	R8	6-1/2	1/8, 3/16, 1/4, 5/16, 3/8, 7/16, 1/2, 9/16, 5/8, 11/16, 3/4, 13/16, 7/8, 15/16, 1	7-188-840	7-180-930
	7-171-404	7-171-414	NMTB 40	6-1/16			
	7-171-405	7-171-415	NMTB 50	7-3/4			
	7-171-4001	7-171-4101	1	4-1/2			
	7-171-4002	7-171-4102	1-1/4	4-3/4			

Spare Parts

ER 11 and ER 16



ER 20



ER 25 - ER 40





Collets



ER Collet Chucks with Cylindrical Shanks



ER11 and ER16

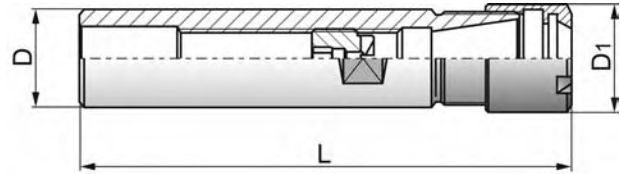

Type 7812

Collet Type	Shank Size D	Part Number	L	D1	Nut Part Number		Wrench Part Number	
ER 11	1/2"	7-171-1105	6.2	.630	7-171-951		7-171-961	
	5/8"	7-171-1106						
ER 16	5/8"	7-171-1606	6.0	.875	7-171-966		7-171-976	
	3/4"	7-171-1607	6.5					
ER 20	3/4"	7-171-2007	5.5	1.338	7-188-821		7-171-982	
	1"	7-171-2009						
ER 25	3/4"	7-171-2303	6.5	1.650	7-188-825		7-188-925	
	1"	7-171-2305						
ER 32	1"	7-171-3001	3.75	1.97	7-188-832		7-188-932	
ER 40	1"	7-171-4001	4.50	2.48	7-188-840		7-180-930	
	1-1/4"	7-171-4002	4.75					

ER Collet Chucks with R8 Shanks



ER 16 Hex Nut
ER 20 - 40 Round Nut

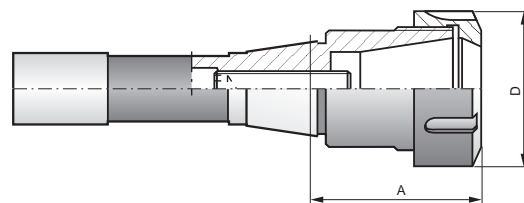

Type 7814

Collet Type	Shank Size	Part Number	A	D	Nut Part Number	Wrench Part Number
ER 16	R8	7-171-1608	1.49	1.26	7-178-816	7-178-916
ER 20		7-171-2008	1.77	1.38	7-188-820	7-188-920
ER 25		7-171-2508	1.97	1.65	7-188-825	7-188-925
ER 32		7-171-3008	2.28	1.97	7-188-832	7-188-932
ER 40		7-171-4008	2.36	2.48	7-188-840	7-180-930

Draw Bar Thread
7/16"-20