

# Safety Plates & Switch Box Supports

## Type SP

### Safety Plates

#### Use:

Installed over areas in wooden structures where cables are run in order to protect cable insulation from being damaged by protruding screws or nails, as defined in the NEC, Article 300-4.

#### Material/Finish:

Steel

#### Note:

SP-100 standard package is 500 pieces.  
SP-150 standard package is 1,000 pieces.

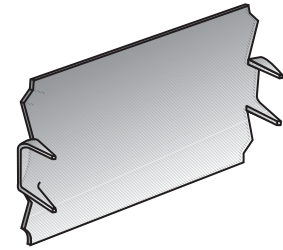
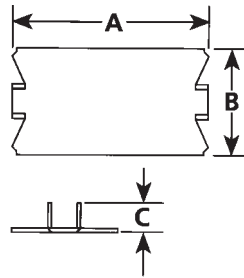

Type SP-100

| Trade Size<br>(inches) | Catalog<br>Number | Dimensions in Inches |      |      | Standard<br>Package |
|------------------------|-------------------|----------------------|------|------|---------------------|
|                        |                   | A                    | B    | C    |                     |
| 1/8x1 1/2x2 1/2        | SP-100            | 2.50                 | 1.53 | 0.45 | 500                 |
| 1/8x1 1/2x2 1/2        | SP-150            | 2.50                 | 1.53 | 0.45 | 1,000               |

## Type HI

### Switch Box Supports

#### Use:

To support attachment of boxes in drywall, paneling, etc., where there are no means of attaching the box to a structure member or the like. Two are required per box. Sold in pairs.

#### Material/Finish:

Galvanized Steel

| Catalog<br>Number | Dimensions in Inches |      |
|-------------------|----------------------|------|
|                   | A                    | B    |
| HI-102            | 5.11                 | 2.25 |

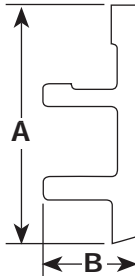

Type HI-102

## Type KO

### Knock- Out Seals

#### Use:

To close unused opening or knockout in sheet metal box, enclosure or cabinet.

#### Material/Finish:

Steel/Zinc Plated

| Trade Size<br>(inches) | Catalog<br>Number | Dimensions in Inches |      |
|------------------------|-------------------|----------------------|------|
|                        |                   | A                    | B    |
| 1/2                    | KO-50             | 1.08                 | 0.40 |
| 3/4                    | KO-75             | 1.25                 | 0.33 |
| 1                      | KO-100            | 1.48                 | 0.33 |
| 1 1/4                  | KO-125            | 1.81                 | 0.33 |
| 1 1/2                  | KO-150            | 2.21                 | 0.37 |
| 2                      | KO-200            | 2.68                 | 0.38 |

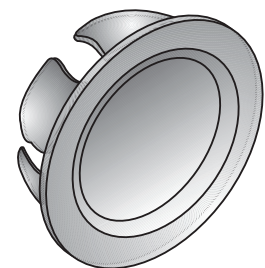
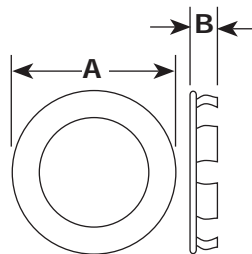

Type KO-50