

# Wire & Cable Materials

www.BradyID.com

3" Core Wire & Cable Materials:

## Brady B-472 Topcoated Polyimide Wirewrap Material

Color: Various Finish: Matte

A thin polyimide material which features an advanced adhesive and topcoat design. This material is self-extinguishing, chemical resistant and able to withstand extreme environments including high temperatures. Provides a strong print performance yet remains flexible, conformable and repositionable for wire wrapping.

Performance Attributes:   

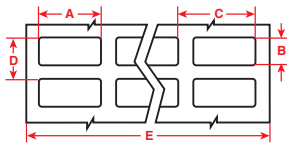

Figure 1

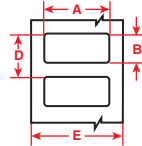

Figure 2

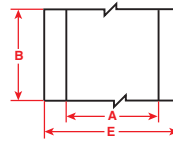

Figure 3

| Diagram | Catalog #        | Material  | Color  | Label Width A<br>Inch (mm) | Label Height B<br>Inch (mm) | Vert. Repeat D<br>Inch (mm) | Web Width E<br>Inch (mm) | Write On Area Height F<br>Inch (mm) | Labels Per Row | Labels Per Pkg | Rec. Ribbon |
|---------|------------------|-----------|--------|----------------------------|-----------------------------|-----------------------------|--------------------------|-------------------------------------|----------------|----------------|-------------|
| Fig. 1  | THT-14-472-10    | Polyimide | White  | 0.650 (16.51)              | 0.200 (5.08)                | 0.300 (7.62)                | -                        | 2.950 (74.93)                       | 4              | 10,000         | R4300       |
| Fig. 1  | THT-1-472-10     | Polyimide | White  | 0.750 (19.05)              | 0.250 (6.35)                | 0.800 (20.32)               | -                        | 3.350 (85.09)                       | 4              | 10,000         | R4300       |
| Fig. 1  | THT-2-472-10     | Polyimide | White  | 0.900 (22.86)              | 0.250 (6.35)                | 1.125 (28.6)                | -                        | 3.350 (85.09)                       | 3              | 10,000         | R4300       |
| Fig. 1  | THT-5-472-10     | Polyimide | White  | 1.000 (25.40)              | 0.500 (12.70)               | 1.075 (27.31)               | -                        | 3.350 (85.09)                       | 3              | 10,000         | R4300       |
| Fig. 3  | THT-259-472      | Polyimide | White  | 1.000 (25.40)              | 300 ft. (91.4 m)            | -                           | -                        | 1.200 (30.48)                       | 1              | 1 roll cont.   | R4306       |
| Fig. 2  | THT-29-472-10    | Polyimide | White  | 1.250 (31.75)              | 0.375 (9.50)                | 1.300 (33.02)               | -                        | 2.750 (69.85)                       | 2              | 10,000         | R4300       |
| Fig. 3  | THT-105-472      | Polyimide | White  | 1.500 (38.10)              | 300 ft. (91.4 m)            | -                           | -                        | 1.700 (43.18)                       | 1              | 1 roll cont.   | R4302       |
| Fig. 3  | THT-106-472      | Polyimide | White  | 2.000 (50.80)              | 300 ft. (91.4 m)            | -                           | -                        | 2.200 (55.88)                       | 1              | 1 roll cont.   | R4300       |
| Fig. 3  | THT-21-472       | Polyimide | White  | 3.000 (76.2)               | 300 ft. (91.4 m)            | -                           | -                        | 3.200 (81.28)                       | 1              | 1 roll cont.   | R4300       |
| Fig. 3  | THT-19-472-1     | Polyimide | White  | 3.000 (76.20)              | 2.000 (50.80)               | -                           | -                        | 3.200 (81.28)                       | 1              | 1,000          | R4300       |
| Fig. 1  | THT-14-472-10-YL | Polyimide | Yellow | 0.650 (16.51)              | 0.200 (5.08)                | 0.300 (7.62)                | -                        | 2.950 (74.93)                       | 4              | 10,000         | R4300       |
| Fig. 1  | THT-1-472-10-YL  | Polyimide | Yellow | 0.750 (19.05)              | 0.250 (6.35)                | 0.800 (20.32)               | -                        | 3.350 (85.09)                       | 4              | 10,000         | R4300       |
| Fig. 1  | THT-2-472-10-YL  | Polyimide | Yellow | 0.900 (22.86)              | 0.250 (6.35)                | 1.125 (28.6)                | -                        | 3.350 (85.09)                       | 3              | 10,000         | R4300       |
| Fig. 1  | THT-5-472-10-YL  | Polyimide | Yellow | 1.000 (25.40)              | 0.500 (12.70)               | 1.075 (27.31)               | -                        | 3.350 (85.09)                       | 3              | 10,000         | R4300       |
| Fig. 3  | THT-259-472-YL   | Polyimide | Yellow | 1.000 (25.40)              | 300 ft. (91.4 m)            | -                           | -                        | 1.200 (30.48)                       | 1              | 1 roll cont.   | R4306       |
| Fig. 2  | THT-29-472-10-YL | Polyimide | Yellow | 1.250 (31.75)              | 0.375 (9.50)                | 1.300 (33.02)               | -                        | 2.750 (69.85)                       | 2              | 10,000         | R4300       |
| Fig. 3  | THT-105-472-YL   | Polyimide | Yellow | 1.500 (38.10)              | 300 ft. (91.4 m)            | -                           | -                        | 1.700 (43.18)                       | 1              | 1 roll cont.   | R4302       |
| Fig. 3  | THT-106-472-YL   | Polyimide | Yellow | 2.000 (50.80)              | 300 ft. (91.4 m)            | -                           | -                        | 2.200 (55.88)                       | 1              | 1 roll cont.   | R4300       |
| Fig. 3  | THT-21-472-YL    | Polyimide | Yellow | 3.000 (76.2)               | 300 ft. (91.4 m)            | -                           | -                        | 3.200 (81.28)                       | 1              | 1 roll cont.   | R4300       |
| Fig. 3  | THT-19-472-1-YL  | Polyimide | Yellow | 3.000 (76.20)              | 2.000 (50.80)               | -                           | -                        | 3.200 (81.28)                       | 1              | 1,000          | R4300       |
| Fig. 1  | THT-1-472-10-BL  | Polyimide | Blue   | 0.750 (19.05)              | 0.250 (6.35)                | 0.800 (20.32)               | -                        | 3.350 (85.09)                       | 4              | 10,000         | R4300       |
| Fig. 1  | THT-2-472-10-BL  | Polyimide | Blue   | 0.900 (22.86)              | 0.250 (6.35)                | 1.125 (28.6)                | -                        | 3.350 (85.09)                       | 3              | 10,000         | R4300       |
| Fig. 1  | THT-5-472-10-BL  | Polyimide | Blue   | 1.000 (25.40)              | 0.500 (12.70)               | 1.075 (27.31)               | -                        | 3.350 (85.09)                       | 3              | 10,000         | R4300       |
| Fig. 3  | THT-259-472-BL   | Polyimide | Blue   | 1.000 (25.40)              | 300 ft. (91.4 m)            | -                           | -                        | 1.200 (30.48)                       | 1              | 1 roll cont.   | R4306       |
| Fig. 2  | THT-29-472-10-BL | Polyimide | Blue   | 1.250 (31.75)              | 0.375 (9.50)                | 1.300 (33.02)               | -                        | 2.750 (69.85)                       | 2              | 10,000         | R4300       |
| Fig. 3  | THT-105-472-BL   | Polyimide | Blue   | 1.500 (38.10)              | 300 ft. (91.4 m)            | -                           | -                        | 1.700 (43.18)                       | 1              | 1 roll cont.   | R4302       |
| Fig. 3  | THT-106-472-BL   | Polyimide | Blue   | 2.000 (50.80)              | 300 ft. (91.4 m)            | -                           | -                        | 2.200 (55.88)                       | 1              | 1 roll cont.   | R4300       |
| Fig. 3  | THT-21-472-BL    | Polyimide | Blue   | 3.000 (76.2)               | 300 ft. (91.4 m)            | -                           | -                        | 3.200 (81.28)                       | 1              | 1 roll cont.   | R4300       |
| Fig. 1  | THT-1-472-10-GY  | Polyimide | Gray   | 0.750 (19.05)              | 0.250 (6.35)                | 0.800 (20.32)               | -                        | 3.350 (85.09)                       | 4              | 10,000         | R4300       |
| Fig. 1  | THT-2-472-10-GY  | Polyimide | Gray   | 0.900 (22.86)              | 0.250 (6.35)                | 1.125 (28.6)                | -                        | 3.350 (85.09)                       | 3              | 10,000         | R4300       |
| Fig. 1  | THT-5-472-10-GY  | Polyimide | Gray   | 1.000 (25.40)              | 0.500 (12.70)               | 1.075 (27.31)               | -                        | 3.350 (85.09)                       | 3              | 10,000         | R4300       |
| Fig. 3  | THT-259-472-GY   | Polyimide | Gray   | 1.000 (25.40)              | 300 ft. (91.4 m)            | -                           | -                        | 1.200 (30.48)                       | 1              | 1 roll cont.   | R4306       |
| Fig. 2  | THT-29-472-10-GY | Polyimide | Gray   | 1.250 (31.75)              | 0.375 (9.50)                | 1.300 (33.02)               | -                        | 2.750 (69.85)                       | 2              | 10,000         | R4300       |
| Fig. 3  | THT-105-472-GY   | Polyimide | Gray   | 1.500 (38.10)              | 300 ft. (91.4 m)            | -                           | -                        | 1.700 (43.18)                       | 1              | 1 roll cont.   | R4302       |
| Fig. 3  | THT-106-472-GY   | Polyimide | Gray   | 2.000 (50.80)              | 300 ft. (91.4 m)            | -                           | -                        | 2.200 (55.88)                       | 1              | 1 roll cont.   | R4300       |
| Fig. 3  | THT-21-472-GY    | Polyimide | Gray   | 3.000 (76.2)               | 300 ft. (91.4 m)            | -                           | -                        | 3.200 (81.28)                       | 1              | 1 roll cont.   | R4300       |
| Fig. 1  | THT-1-472-10-GN  | Polyimide | Green  | 0.750 (19.05)              | 0.250 (6.35)                | 0.800 (20.32)               | -                        | 3.350 (85.09)                       | 4              | 10,000         | R4300       |
| Fig. 1  | THT-2-472-10-GN  | Polyimide | Green  | 0.900 (22.86)              | 0.250 (6.35)                | 1.125 (28.6)                | -                        | 3.350 (85.09)                       | 3              | 10,000         | R4300       |
| Fig. 1  | THT-5-472-10-GN  | Polyimide | Green  | 1.000 (25.40)              | 0.500 (12.70)               | 1.075 (27.31)               | -                        | 3.350 (85.09)                       | 3              | 10,000         | R4300       |
| Fig. 3  | THT-259-472-GN   | Polyimide | Green  | 1.000 (25.40)              | 300 ft. (91.4 m)            | -                           | -                        | 1.200 (30.48)                       | 1              | 1 roll cont.   | R4306       |
| Fig. 2  | THT-29-472-10-GN | Polyimide | Green  | 1.250 (31.75)              | 0.375 (9.50)                | 1.300 (33.02)               | -                        | 2.750 (69.85)                       | 2              | 10,000         | R4300       |
| Fig. 3  | THT-105-472-GN   | Polyimide | Green  | 1.500 (38.10)              | 300 ft. (91.4 m)            | -                           | -                        | 1.700 (43.18)                       | 1              | 1 roll cont.   | R4302       |
| Fig. 3  | THT-106-472-GN   | Polyimide | Green  | 2.000 (50.80)              | 300 ft. (91.4 m)            | -                           | -                        | 2.200 (55.88)                       | 1              | 1 roll cont.   | R4300       |
| Fig. 3  | THT-21-472-GN    | Polyimide | Green  | 3.000 (76.2)               | 300 ft. (91.4 m)            | -                           | -                        | 3.200 (81.28)                       | 1              | 1 roll cont.   | R4300       |

View the Material Brands & Attributes Guide on page 4.  
Benchtop Printer Ribbons on page 184.  
Full Material Properties on page 187.