

DIAL INDICATOR

NEW SIZES!



2307-1

- Lug back
- Supplied with tolerance index and bezel clamp
- Optional accessory: backs (page 60), contact points (page 59-60)
- Supplied in fitted storage case

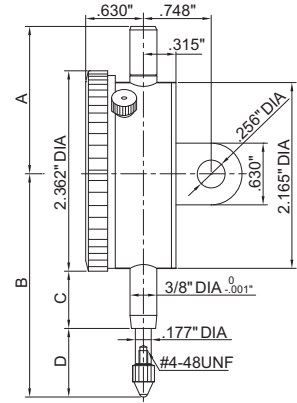

Order No.	EDP No.	Range	Graduation	Accuracy		Range /Rev	Dial Reading
				First 2.5 Rev	Overall		
2307-025	282705	.25"	.001"	.002"	.002"	.1"	0-100
2307-05	816156	.5"	.001"	.002"	.003"	.1"	0-100
2307-1	816158	1"	.001"	.002"	.008"	.1"	0-100
2307-2	816160	2"	.001"	.002"	.008"	.1"	0-100
2307-0255	282707	.25"	.0005"	.001"	.002"	.05"	0-50
2307-055	282708	.5"	.0005"	.001"	.003"	.05"	0-50
2307-105	282709	1"	.0005"	.001"	.004"	.05"	0-50
2307-205	282710	2"	.0005"	.001"	.005"	.05"	0-50

Range	A	B	C	D
.25"	1.811"	2.953"	.787"	.984"
.5"	1.811"	2.953"	.787"	.984"
1"	1.811"	3.346"	.787"	1.378"
2"	4.370"	5.472"	1.969"	2.323"

COMPACT TYPE DIAL INDICATOR

NEW ITEM!



2304-01

- Lug back
- Supplied with tolerance index and bezel clamp
- Optional accessory: backs (page 60), contact points (page 59-60)
- Supplied in fitted storage case

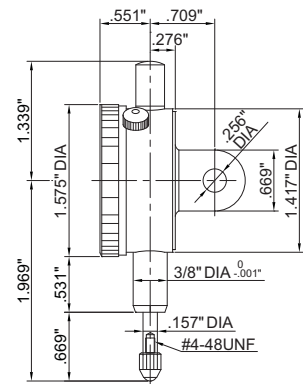

Order No.	EDP No.	Range	Graduation	Accuracy		Range /Rev	Dial Reading
				First 2.5 Rev	Overall		
2304-01	282699	.1"	.001"	.002"	.002"	.1"	0-100
2304-02	282700	.2"	.001"	.002"	.002"	.1"	0-100
2304-025	282701	.25"	.001"	.002"	.002"	.1"	0-100
2304-015	282702	.1"	.0005"	.001"	.001"	.05"	0-50
2304-0205	282703	.2"	.0005"	.001"	.001"	.05"	0-50
2304-0255	282704	.25"	.0005"	.001"	.002"	.05"	0-50