



GUF-2



GUF-8



GUM-2



GUML-2



UNF2



UNY4



UNY2



GUML-2M

Female to Female

Male to Female

90° Elbow Union

- GUF/GUM/UNF/UNY 1/2", 3/4", & 1" Class I, Div. 1 & 2, Groups A,B,C,D Class I, Zone I, IIC, IIB, IIA Class I, Zone 1, Groups IIC, IIB, IIA Class II, Div. 1 & 2, Groups E,F,G Class III
- GUF/GUM/UNF/UNY 1-1/4" through 4" Class I, Div. 1 & 2, Groups C,D Class I, Zone I, IIB, IIA Class I, Zone 1, Groups IIB, IIA Class II, Div. 1 & 2, Groups E,F,G Class III

UL Listed File No. E 10514

SF Certified File No. LR11716

FEATURES-SPECIFICATIONS

Applications

- GUF/GUM or UNF/UNY unions are used to connect two pieces of conduit or attach conduit to junction boxes, fittings, or devices
- Permits removal of equipment without turning or removal of conduit

Features

- Threaded for rigid conduit or IMC
- Tapered threads (NPT)
- Strong and durable construction

Material/Finish

Copper-free Aluminum (less than 4/10 of 1%)

- Natural Finish
- 1/2" - 2" screw machine
- 2-1/2" - 4" cast

Iron — 1-1/4" - 4"

Steel — 1/2", 3/4", 1"

- Zinc electro-plate

Third-Party Standards

- UL Standards 886 and 1203
- CSA Standard C22.2 No. 30

For ATEX and IEC Ex certified Unions, see following page.

| FEMALE TO FEMALE          |          |             |               |                          |                          |              |               |            |            |
|---------------------------|----------|-------------|---------------|--------------------------|--------------------------|--------------|---------------|------------|------------|
| CAT. NO.<br>KILLARK ALUM. | HUB SIZE | DIMENSIONS  |               | CAT. NO.<br>DURALOY IRON | HUB SIZE                 | DIMENSIONS   |               |            |            |
|                           |          | A DIAMETER  | B LENGTH      |                          |                          | A DIAMETER   | B LENGTH      |            |            |
| GUF-1                     | 1/2"     | 1-7/16"(37) | 1-7/8"(48)    | UNF1                     | 1/2"                     | 1-1/2"(37)   | 1-55/64"(47)  |            |            |
| GUF-2                     | 3/4"     | 1-5/8"(41)  | 1-15/16"(49)  | UNF2                     | 3/4"                     | 1-3/4"(45)   | 1-59/64"(49)  |            |            |
| GUF-3                     | 1"       | 2"(51)      | 2-29/64"(62)  | UNF3                     | 1"                       | 2"(51)       | 2-7/16"(62)   |            |            |
| GUF-4                     | 1-1/4"   | 2-3/8"(60)  | 2-1/2"(63)    | UNF4                     | 1-1/4"                   | 2-27/32"(72) | 2-1/4"(57)    |            |            |
| GUF-5                     | 1-1/2"   | 2-5/8"(67)  | 2-1/2"(63)    | UNF5                     | 1-1/2"                   | 3-3/32"(79)  | 2-7/16"(62)   |            |            |
| GUF-6                     | 2"       | 3-1/4"(82)  | 2-5/8"(67)    | UNF6                     | 2"                       | 3-3/4"(95)   | 2-5/8"(67)    |            |            |
| GUF-7                     | 2-1/2"   | 4-1/2"(114) | 3"(76)        | UNF7                     | 2-1/2"                   | 4-1/2"(114)  | 3"(76)        |            |            |
| GUF-8                     | 3"       | 5-3/8"(136) | 3-1/16"(78)   | UNF8                     | 3"                       | 5-3/8"(136)  | 3-1/16"(78)   |            |            |
| GUF-9                     | 3-1/2"   | 6-1/4"(159) | 3-9/16"(90)   | UNF9                     | 3-1/2"                   | 6-1/4"(159)  | 3-9/16"(90)   |            |            |
| GUF-0                     | 4"       | 6-1/4"(159) | 3-9/16"(90)   | UNF0                     | 4"                       | 6-1/4"(159)  | 3-9/16"(90)   |            |            |
| MALE TO FEMALE            |          |             |               |                          |                          |              |               |            |            |
| CAT. NO.<br>KILLARK ALUM. | HUB SIZE | DIMENSIONS  |               | CAT. NO.<br>DURALOY IRON | HUB SIZE                 | DIMENSIONS   |               |            |            |
|                           |          | A DIAMETER  | B LENGTH      |                          |                          | A DIAMETER   | B LENGTH      |            |            |
| GUM-1                     | 1/2"     | 1-7/16"(37) | 2-1/2"(64)    | UNY1                     | 1/2"                     | 1-1/2"(37)   | 2-9/16"(65)   |            |            |
| GUM-2                     | 3/4"     | 1-5/8"(41)  | 2-9/16"(65)   | UNY2                     | 3/4"                     | 1-3/4"(45)   | 2-5/8"(67)    |            |            |
| GUM-3                     | 1"       | 2"(51)      | 3-3/64"(77)   | UNY3                     | 1"                       | 2-1/32"(52)  | 3-5/64"(78)   |            |            |
| GUM-4                     | 1-1/4"   | 2-3/8"(60)  | 3-1/4"(83)    | UNY4                     | 1-1/4"                   | 2-15/16"(75) | 3-1/4"(83)    |            |            |
| GUM-5                     | 1/2"     | 2-5/8"(67)  | 3-1/4"(83)    | UNY5                     | 1-1/2"                   | 3-3/16"(81)  | 3-1/2"(89)    |            |            |
| GUM-6                     | 2"       | 3-1/4"(82)  | 3-5/8"(92)    | UNY6                     | 2"                       | 3-3/4"(95)   | 4"(102)       |            |            |
| GUM-7                     | 2-1/2"   | 4-1/2"(114) | 4-15/16"(125) | UNY7                     | 2-1/2"                   | 4-1/2"(114)  | 4-15/16"(125) |            |            |
| GUM-8                     | 3"       | 5-3/8"(136) | 5-7/32"(133)  | UNY8                     | 3"                       | 5-3/8"(133)  | 5-7/32"(133)  |            |            |
| GUM-9                     | 3-1/2"   | 6-1/4"(159) | 5-13/16"(148) | UNY9                     | 3-1/2"                   | 6-1/4"(159)  | 5-13/16"(148) |            |            |
| GUM-0                     | 4"       | 6-1/4"(159) | 5-13/16"(148) | UNY0                     | 4"                       | 6-1/4"(159)  | 5-13/16"(148) |            |            |
| 90° ANGLE UNION           |          |             |               |                          |                          |              |               |            |            |
| CAT. NO.<br>KILLARK ALUM. | HUB SIZE | DIMENSIONS  |               |                          | CAT. NO.<br>DURALOY IRON | HUB SIZE     | DIMENSIONS    |            |            |
|                           |          | A DIA.      | B LENGTH      | C                        |                          |              | A DIA.        | B LENGTH   | C          |
| GUML-1                    | 1/2"     | 2-1/2"(64)  | 1-7/16"(37)   | 1-3/4"(44)               | GUML-1M                  | 1/2"         | 2-1/4"(32)    | 1-1/2"(38) | 1-5/8"(42) |
| GUML-2                    | 3/4"     | 2"(51)      | 1-5/8"(42)    | 1-5/8"(42)               | GUML-2M                  | 3/4"         | 2-1/4"(32)    | 1-3/4"(44) | 2"(51)     |

UL & CSA suitable for Class I, Groups A, B, C, D.

Dimensions

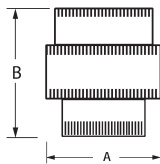

GUF

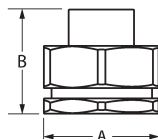

UNF

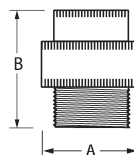

GUM

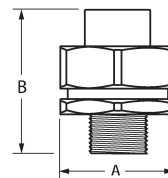

UNY

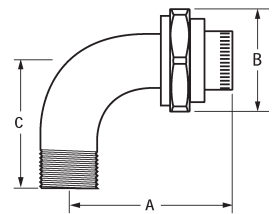

GUML