

Adjustable Hinges

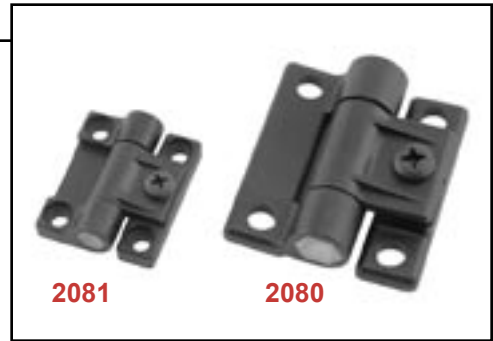

- 10 and 15 Series compatible
- Body made of black acetal with clear polycarbonate hinge pins
- Durable yet economical, allows you to adjust pivot tension
- Hinges mount plastic panels and lightweight doors to T-slotted profiles



Note: These hinges are not suitable for hinging T-slotted profiles together.

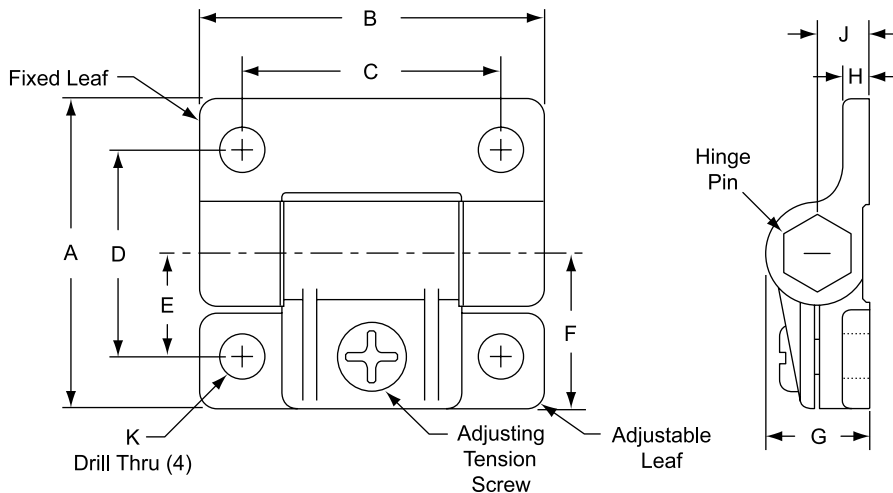

Part No.	A	B	C	D	E	F	G	H	J	K	Lbs.
2081 ☒	1.440	1.690	1.250	1.000	.500	.720	.500	.230	.270	.197	.030
2080	2.250	2.500	1.880	1.500	.750	1.125	.770	.200	.410	.328	.100

☒ = 10 Series Compatible Part

Recommended Bolt Assembly: (Mount to Profile)

Part No.	Qty	Description
3457 ☒	2	10-32 x 3/8" SHCS & Economy T-Nut
3365	2	5/16-18 x 5/8" BHSCS & Economy T-Nut

Recommended Bolt Assembly: (Mount 1/4" Panel)

Part No.	Qty	Description
3459 ☒	2	10-32 x 3/8" SHCS & Hex Nut
3442	2	5/16-18 x 3/4" BHSCS & Hex Nut

Adjustable Hinge Strength Guidelines

		2080	2081
Ultimate Tensil		896 Lbs.	375 Lbs.
Ultimate Tensil		670 Lbs.	286 Lbs.
Ultimate Shear		417 Lbs.	182 Lbs.