

McKissick® Snatch Blocks

HOOK FITTING, SINGLE SHEAVE, 2-12t



416



L-170



L-160



C-720

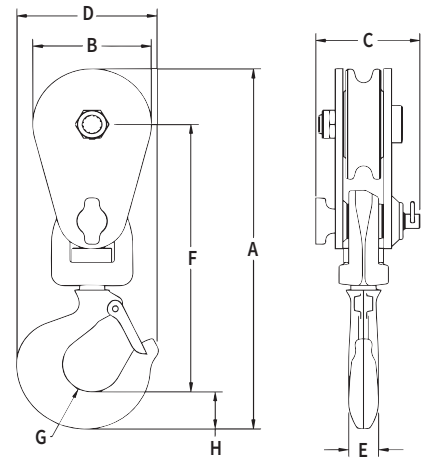

- Opening feature permits easy insertion of rope without reeving, or while the block is suspended.
 - Bolt for opening feature is retained, to ensure no lost bolts.
 - Forged steel swivel tees, yokes and hooks.
 - Furnished with a latch installed.
 - Can be furnished with bronze bushings or roller bearings.
 - Center pin equipped with pressure lube fitting.
 - All sizes feature sheave grooves suited for a range of wire line diameters.
 - Meets or exceeds all requirements of ASME B30.26 including identification ductility, design factor, proof load and temperature requirements.
- Importantly, these blocks meet other critical performance requirements including fatigue life and material traceability, not addressed by ASME B30.26.
- "All Alloy" snatch blocks feature a significant reduction in weight compared to snatch blocks made of non-alloy materials.
 - "Lebus General Purpose" snatch blocks (with shackle or hook) feature an easy-to-open bolt design. The retaining bolt is released by rotating the fitting assembly, no tools required.
 - Crosby's Engineered Solutions Group is ready to discuss your requirements and help select or develop the ideal block for your

Working Load Limit (t)*	Wire Rope Size (mm)	Sheave Diameter (mm)	Bearing Code	Weight Each (kg)	Catalog No.	Description	Stock No.	Dimensions (mm)							
								A	B	C	D	E	F	G	H
2 tonnes															
2	8 - 10	76	BB	2.3	418	Light Champion	108038	247	76	67	91	19	184	19	25
4 tonnes															
4	10 - 13	114	BB	5.4	418	Light Champion	108065	359	108	79	133	25	257	24	47
5 tonnes															
5	10 - 13 ‡	102	BB	5.0	L-170	Lebus, General Purpose	599800	371	116	75	133	25	267	24	47
5	10 - 13 ‡	102	RB	5.0	L-170	Lebus, General Purpose	599819	371	116	75	133	25	267	24	47
6 tonnes															
6**	10 - 13	127	BB	5.9	L-160	Lebus, Heavy Duty	599506	370	130	94	133	25	257	24	47
6**	10 - 13	127	RB	5.9	L-160	Lebus, Heavy Duty	599515	370	130	94	133	25	257	24	47
7 Tons															
7T**	19 - 22	6	BB	12.7	C-720	Heavy Duty Utility	280010	410	152	97	159	37	288	32	41
8 tonnes															
8	16 - 19	152	BB	12.2	418	Light Champion	108127	481	152	106	173	40	344	33	61
8	16 - 19	152	RB	12.2	418	Light Champion	108154	481	152	106	173	40	344	33	61
8	16 - 19	203	BB	15.0	418	Light Champion	108225	534	206	106	173	40	369	33	61
8	16 - 19	203	RB	15.0	418	Light Champion	108252	534	206	106	173	40	369	33	61
8	16 - 19	254	BB	18.6	418	Light Champion	108323	586	257	106	173	40	396	33	61
8	16 - 19	254	RB	18.6	418	Light Champion	108350	586	257	106	173	40	396	33	61
8	16 - 19	305	BB	21.8	418	Light Champion	108421	658	308	106	173	40	442	33	61
8	16 - 19	305	RB	21.8	418	Light Champion	108458	658	308	106	173	40	442	33	61
8	16 - 19	356	BB	24.9	418	Light Champion	108528	696	359	106	173	40	455	33	61
8	16 - 19	356	RB	24.9	418	Light Champion	108546	696	359	106	173	40	455	33	61
12 tonnes															
12**	16 - 19	146	BB	13.2	L-160	Lebus, Heavy Duty	599560	508	152	106	200	40	365	37	67
12**	16 - 19	146	RB	13.2	L-160	Lebus, Heavy Duty	599579	508	152	106	200	40	365	37	67
12	19 - 22	152	BB	11.8	416	All Alloy	193427	505	152	106	200	40	362	37	67
12	19 - 22	152	RB	11.8	416	All Alloy	193472	505	152	106	200	40	362	37	67
12	19 - 22	203	BB	15.0	416	All Alloy	193490	558	206	106	200	40	388	37	67
12	19 - 22	203	RB	15.0	416	All Alloy	193542	558	206	106	200	40	388	37	67
12	19 - 22	254	BB	18.6	416	All Alloy	193613	610	257	106	200	40	415	37	67
12	19 - 22	254	RB	18.6	416	All Alloy	193677	610	257	106	200	40	415	37	67

* Ultimate Load is 4 times the Working Load Limit. ** Ultimate Load is 3.5 times the Working Load Limit. ‡ Special Dual Groove Sheave also accepts 1-1/4" Manila Rope