



Break-Away Swivels

SWIVELS & ACCESSORIES



U. S. Patent No. 4,687,365.

Break-Away Swivel

Essential for fiber optic and coaxial cable pulling, these swivels have a break load ranging from 150–1,800 pounds (667–8,006 N) and are designed to separate at $\pm 10\%$ of their rated break load. If the load rating is exceeded, the interior break pin fractures, the swivel separates, and the cable remains undamaged. Break pin is easily replaceable (see ordering information, next page).

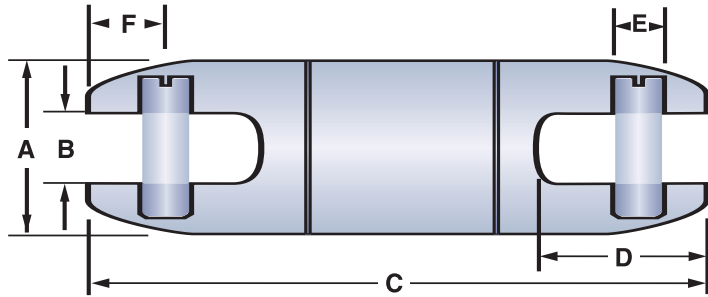

Break-Away Swivel Dimensions

	A		B		C		D		E		F	
	(in)	(mm)	(in)	(mm)	(in)	(mm)	(in)	(mm)	(in)	(mm)	(in)	(mm)
5/8"	16	.28	7	3.56	90	.79	20	.25	6	.37	9	
7/8"	22	.38	10	4.51	115	1.06	27	.31	8	.53	13	

5/8" Swivel (16 mm)

Part Number	Break Load	
	(lbs)	(N)
08017300	200	890
08017400	250	1,112
08017800	300	1,334
08016900	450	2,002
08017200	600	2,669
08017500	650	2,891
08017900	750	3,336

7/8" Swivel (22 mm)

Part Number	Break Load	
	(lbs)	(N)
08018100	150	667
08018300	200	890
08018000	250	1,112
08017600	300	1,334
08018400	350	1,557
08075300	400	1,779
08015800	450	2,002
08076500	500	2,224
08018500	550	2,446
08015000	600	2,669
08018600	650	2,891
08076000	700	3,114
08075500	750	3,336
08018700	800	3,558
08018800	850	3,781
08076600	900	4,003
08015700	1,000	4,448
08018900	1,100	4,893
08015200	1,200	5,338
08019100	1,300	5,782
08074600	1,400	6,227
08076900	1,500	6,672
08019200	1,600	7,117
08019300	1,700	7,562
08017700	1,800	8,006

NOTE: Swivels are not designed to run around bullwheels.