

BURNDY

Overhead



TYPE KC22J12T13, EQC632C

TRANSFORMER GROUND
CONNECTORS

FOR COPPER

Fits all standard EEI-NEMA distribution trans-
formers as a tank grounding terminal.



Type EQC632C

CATALOG NUMBER	RANGES
KC22J12T13	8 Sol.-2 Sol.
KC26	2 Sol. - 2/0 Str.
KC34J12T13	3/0 - 500 Str.
EQC632C	8 Sol.-2 Str.

Both, one wrench installation.

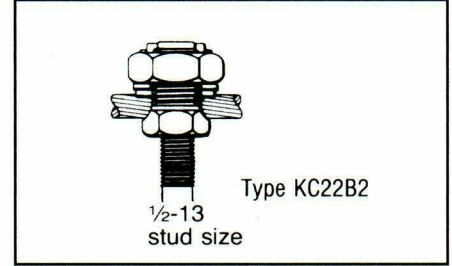

Type KC22B2
1/2-13
stud size

TYPE YA-2LH

HYSEALUG

TERMINAL FOR COPPER

Tin-plated, pure copper 2-hole NEMA com-
pression terminal with shrouded barrel for
terminating insulated copper conductor to
transformers and other equipment. Shroud
prevents seepage of water or moisture into
conductor strands and minimizes taping.

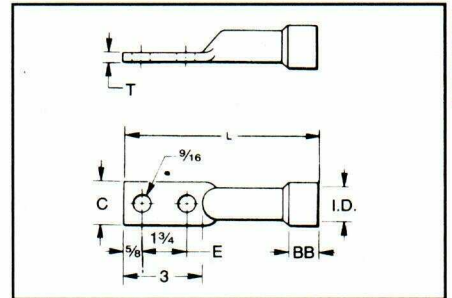
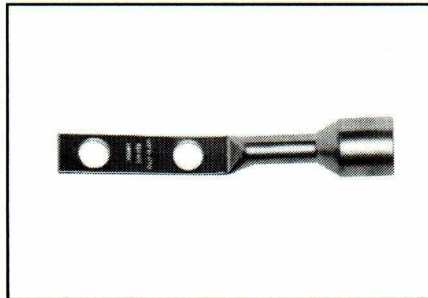

CATALOG NUMBER	CONDUCTOR	BB	SHROUD INSIDE DIA.	C	L	T	TOOLS, DIE SET CATALOG NO., & NUMBER OF CRIMPS	
							MD6	Y35, Y750, Y45†, Y46‡
YAB4C-2LH72	4 STR.	5/8	.57	3/4	6-1/4	1/8	W161 2	U4CRT 2
YAB4C-2LH73			.84					
YAB2C-2LH74	2 STR.	3/4	.58	7/8	6-1/2	3/8	W162 4	U2CRT 2
YAB25-2LH75			.91					
YAB25-2LH70	1/0 STR.	1	.69	1	6-3/4	1/8	W163 4	U25RT 2
YAB25-2LH71			.98					
YA26-2LH88	2/0 STR.	1	.73	1	6-1/4	1/8	W241 2	U26RT 2
YA26-2LH89			1.04					
YA27-2LH97	3/0 STR.	1	.84	1	6-1/4	1/8	W243 2	U27RT 2
YA27-2LH98			1.06					
YA28-2LH114	4/0 STR.	1	.86	1	6-5/8	1/8	W-BG or 2 W243	U28RT 2
YA28-2LH115			1.24					
YA29-2LH90	250	1-1/4	.88	1-1/8	7	1/8	W166 4	U29RT 2
YA29-2LH91			1.25					
YA30-2LH85	300	1-1/4	.92	1-1/4	7	1/8	-	U30RT 2
YA30-2LH86			1.32					
YA31-2LH89	350	1-1/4	1.03	1-3/8	7-5/8	1/8	W-O 5	U31RT 2
YA31-2LH90			1.40					
YA34-2LH110	500	1-1/2	1.14	1-1/2	7-3/4	1/4	-	U34RT 2
YA34-2LH111			1.88					

† U Die with adapter PT-6515
‡ U Die with adapter P-UADP.