

Combination Threaded Rigid and Set-Screw EMT to Box

90° pulling elbows with cover and gasket. Zinc die-cast.



CATALOG NUMBER	UPC/DCI/NAED MFG #018997	TRADE SIZE	UNIT PKG	STD PKG	DIM A	DIM B
9100	91005	1/2	5	50	2.030	1.945
9110	91100	3/4	5	50	2.260	2.140
9120	50165	1	5	25	2.610	2.610
9130	50167	1-1/4	2	10	3.037	3.037

See hub illustration on page B-8.

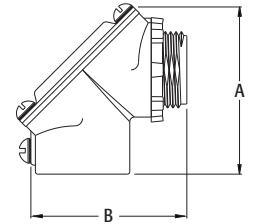

Combination Threaded Rigid and Set-Screw EMT 90° Pulling Elbow

90° pulling elbows with cover and gasket. Zinc die-cast.



CATALOG NUMBER	UPC/DCI/NAED MFG #018997	TRADE SIZE	UNIT PKG	STD PKG	DIM A	DIM B
HL5000	83105	1/2	10	100	2.120	2.120
HL7500	83175	3/4	5	50	2.380	2.380
HL100	50171	1	5	25	3.040	3.040
HL125	50173	1-1/4	2	10	3.900	3.900

See hub illustration on page B-8.

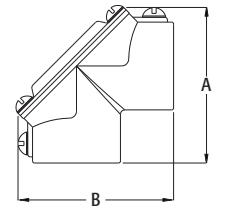

Watertight Conduit Hubs

For rigid • IMC conduit. With insulated throat. Zinc die-cast.



CATALOG NUMBER	UPC/DCI/NAED MFG #018997	TRADE SIZE	STD PKG	DIM A	DIM B
WH1	58100	1/2	10	1.325	1.325
WH2	58200	3/4	10	1.450	1.512
WH3	58300	1	10	1.450	1.790
WH4	58400	1-1/4	5	1.575	2.295
WH5	58500	1-1/2	2	1.700	2.450
WH6	58600	2	2	1.700	2.875
WH7	58700	2-1/2	1	2.045	3.325
WH8	58800	3	1	2.150	4.040
WH9	58900	3-1/2	1	2.420	4.550
WH10	58101	4	1	2.420	5.030
WH11†	58103	5	1	3.000	6.750
WH12†	58105	6	1	3.085	7.600

† Malleable.

