

## Combination Threaded Rigid and Set-Screw EMT

90° pulling elbows with cover and gasket. Zinc die-cast.



CATALOG NUMBER	UPC/DCI/NAED MFG #018997	TRADE SIZE	UNIT PKG	STD PKG	DIM A	DIM B
HL5000	83105	1/2	10	100	2.150	2.150
HL7500	83175	3/4	5	50	2.300	2.300
HL100	50171	1	5	25	3.040	3.040
HL125	50173	1-1/4	2	10	3.900	3.900

See hub illustration below.

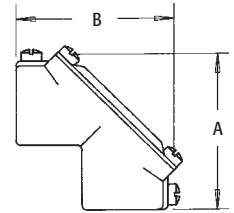

## Combination Threaded Rigid and Set-Screw EMT To Box

90° pulling elbows with cover and gasket. Zinc die-cast.



CATALOG NUMBER	UPC/DCI/NAED MFG #018997	TRADE SIZE	UNIT PKG	STD PKG	DIM A	DIM B
9100	91005	1/2	5	50	2.030	1.945
9110	91100	3/4	5	50	2.260	2.140
9120	50165	1	5	25	2.610	2.610
9130	50167	1-1/4	2	10	3.037	3.037

See hub illustration below.

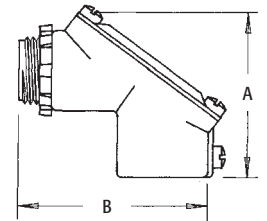

### Hub Illustration

#### For Combination Threaded and Set-Screw Pull Elbows

Arlington's combination hubs are threaded for rigid and include set-screws for EMT. The set-screws may be used for rigid, but are not necessary. They are listed rain tight with rigid and concrete tight when taped for EMT. These products can also be used for EMT to rigid.



## Combination Threaded Rigid and Set-Screw EMT to Box

90° pulling elbows with cover and gasket. Zinc die-cast.



CATALOG NUMBER	UPC/DCI/NAED MFG #018997	TRADE SIZE	UNIT PKG	STD PKG	DIM A	DIM B
9100	91005	1/2	5	50	2.030	1.945
9110	91100	3/4	5	50	2.260	2.140
9120	50165	1	5	25	2.610	2.610
9130	50167	1-1/4	2	10	3.037	3.037

See hub illustration on page B-8.

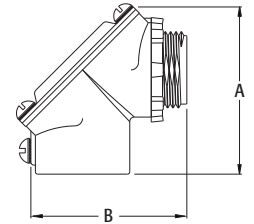

## Combination Threaded Rigid and Set-Screw EMT 90° Pulling Elbow

90° pulling elbows with cover and gasket. Zinc die-cast.



CATALOG NUMBER	UPC/DCI/NAED MFG #018997	TRADE SIZE	UNIT PKG	STD PKG	DIM A	DIM B
HL5000	83105	1/2	10	100	2.120	2.120
HL7500	83175	3/4	5	50	2.380	2.380
HL100	50171	1	5	25	3.040	3.040
HL125	50173	1-1/4	2	10	3.900	3.900

See hub illustration on page B-8.

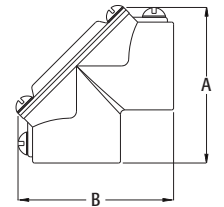

## Watertight Conduit Hubs

For rigid • IMC conduit. With insulated throat. Zinc die-cast.



CATALOG NUMBER	UPC/DCI/NAED MFG #018997	TRADE SIZE	STD PKG	DIM A	DIM B
WH1	58100	1/2	10	1.325	1.325
WH2	58200	3/4	10	1.450	1.512
WH3	58300	1	10	1.450	1.790
WH4	58400	1-1/4	5	1.575	2.295
WH5	58500	1-1/2	2	1.700	2.450
WH6	58600	2	2	1.700	2.875
WH7	58700	2-1/2	1	2.045	3.325
WH8	58800	3	1	2.150	4.040
WH9	58900	3-1/2	1	2.420	4.550
WH10	58101	4	1	2.420	5.030
WH11†	58103	5	1	3.000	6.750
WH12†	58105	6	1	3.085	7.600

† Malleable.

