

3-Piece Coupling Rigid • IMC

Zinc die-cast.



| CATALOG NUMBER | UPC/DCI/NAED MFG #018997 | TRADE SIZE | STD PKG | DIM A | DIM B | DIM C |
|----------------|--------------------------|------------|---------|-------|-------|-------|
| 200 | 00200 | 1/2 | 50 | 1.430 | 1.310 | 1.250 |
| 201 | 00201 | 3/4 | 50 | 1.520 | 1.610 | 1.560 |
| 202 | 00202 | 1 | 25 | 1.700 | 2.125 | 2.100 |
| 203 | 00203 | 1-1/4 | 25 | 2.125 | 2.400 | 2.415 |
| 204 | 00204 | 1-1/2 | 25 | 2.125 | 2.890 | 2.940 |
| 205 | 00205 | 2 | 20 | 2.360 | 3.400 | 3.500 |
| 206 | 00206 | 2-1/2 | 10 | 2.520 | 4.030 | 4.390 |
| 207 | 00207 | 3 | 5 | 2.580 | 4.620 | 4.930 |
| 208 | 00208 | 3-1/2 | 5 | 2.645 | 5.350 | 5.425 |
| 209 | 00209 | 4 | 2 | 3.420 | 5.870 | 5.780 |
| 210† | 00210 | 5 | 1 | 4.375 | 7.000 | 7.000 |
| 211† | 00211 | 6 | 1 | 4.375 | 8.250 | 8.250 |

† Malleable.

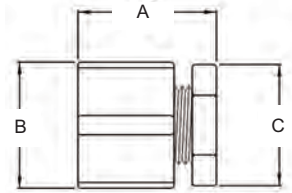

3/4" Offset Nipples

Zinc die-cast.



| CATALOG NUMBER | UPC/DCI/NAED MFG #018997 | TRADE SIZE | KO SIZE | UNIT PKG | STD PKG | DIM A | DIM B |
|----------------|--------------------------|------------|---------|----------|---------|-------|-------|
| 6A2 | 61200 | 1/2 | 1/2 | 20 | 200 | 2.460 | 1.000 |
| 6A3 | 61300 | 3/4 | 3/4 | 10 | 100 | 2.560 | 1.220 |
| 6A4 | 61400 | 1 | 1 | 10 | 100 | 2.535 | 1.525 |
| 6A5 | 61500 | 1-1/4 | 1-1/4 | 10 | 40 | 2.937 | 1.910 |
| 6A6 | 61600 | 1-1/2 | 1-1/2 | 10 | 40 | 3.080 | 2.125 |
| 6A7 | 61700 | 2 | 2 | 10 | 10 | 3.145 | 2.665 |
| 6A8† | 61800 | 2-1/2 | 2-1/2 | 2 | 2 | 3.970 | 3.280 |
| 6A9† | 61900 | 3 | 3 | 1 | 1 | 4.420 | 3.795 |
| 6A10† | 64000 | 3-1/2 | 3-1/2 | 1 | 1 | 5.000 | 4.477 |
| 6A11† | 64002 | 4 | 4 | 1 | 1 | 5.000 | 4.960 |

† Malleable.

