

# NEER Service Entrance Connectors

## UF: For Underground Cable

### Applications

- Gland type connector for sealing and terminating Type UF cable.

### Standard Material/Finish

- Steel/zinc plated
- Grommet: neoprene

### Certifications and Compliances

- UL Standard: 514B
- UL Listed: E25015
- NEMA: FB-1



UF

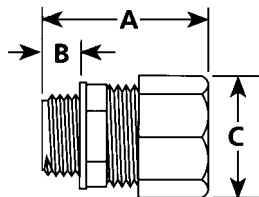

## WC: For Oval SE/U Cable

### Applications

- For terminating and sealing service entrance cable entering an enclosure or conduit hub.

### Standard Material/Finish

- Body: zinc diecast
- Compression washer: steel/zinc plated
- Grommet: neoprene

### Certifications and Compliances

- WC-1004 thru WC-2004N, except WC-1501 and WC-2001
- UL Listed: E37336
- WC-1004 thru WC-2004N
- CSA Certified: LR14489

\* Note: Connector Selection: SE dimensions are based upon average dimensions given by various manufacturers of cable. Individual manufacturers vary. Actual dimensions must be checked and proper fittings selected based upon "grommet range minimum" column.



WC

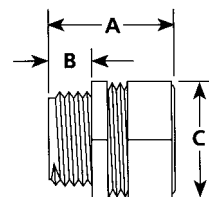

Trade Size (Inches)	Catalog Number	Dimensions in Inches/Millimeters			Cable Range
		A	B	C	
1/2	UF-50	1.31/33.3	0.50/12.7	1.08/27.4	14-2 and 12-2 AWG
3/4	UF-75 *	1.51/38.4	0.52/13.2	1.33/33.8	14-3, 12-3, 10-3 and 8-2 AWG

Trade Size (In.)	Catalog Number	Grommet * Minimum	Opening Maximum	Dimensions in Inches/Millimeters		
				A	B	C
1	WC-1004	0.32 x 0.50	0.50 x 0.80	1.56/39.6	0.55/14.0	1.50/38.1
1	WC-1006	0.40 x 0.71	0.44 x 0.70	1.56/39.6	0.55/14.0	1.50/38.1
1	WC-1008	0.44 x 0.81	0.40 x 0.63	1.56/39.6	0.55/14.0	1.50/38.1
1-1/4	WC-1252	0.51 x 0.93	0.57 x 0.85	1.99/50.5	0.61/15.5	1.84/46.7
1-1/4	WC-1253	0.48 x 0.87	0.51 x 0.85	1.99/50.5	0.61/15.5	1.84/46.7
1-1/4	WC-1252N	0.57 x 1.05	0.66 x 0.94	1.99/50.5	0.61/15.5	1.84/46.7
1-1/2	WC-1501	0.65 x 1.10	0.70 x 1.19	2.18/55.4	0.62/15.7	2.15/54.6
1-1/2	WC-1502	0.70 x 1.20	0.74 x 1.23	2.18/55.4	0.62/15.7	2.15/54.6
2	WC-2001	0.65 x 1.10	0.70 x 1.19	2.41/61.2	0.76/19.3	2.57/65.3
2	WC-2002	0.70 x 1.20	0.74 x 1.23	2.41/61.2	0.76/19.3	2.57/65.3
2	WC-2003	0.75 x 1.30	0.83 x 1.41	2.41/61.2	0.76/19.3	2.57/65.3
2	WC-2004	0.84 x 1.43	0.89 x 1.53	2.41/61.2	0.76/19.3	2.57/65.3
2	WC-2004N	0.94 x 1.58	1.00 x 1.58	2.41/61.2	0.76/19.3	2.57/65.3

\* Not UL Listed or CSA Certified.