

Cable Connectors

For Armored Cable & Flexible Metal Conduit

Type AC & Type ACV

90° 2-Screw Clamp Connectors

90° Angle Squeeze Connectors

Use:

To ground and secure Armored Cable and Flexible Metal Conduit to boxes and enclosures.

Features:

- Male hub threads - NPS.
- All center stopped.
- Furnished with locknuts.
- Available with insulated throat
- Also suitable for NM and SE cable

Material/Finish:

Malleable Iron/Zinc Electroplated

Third Party Certification:



UL Listed: E-11852
 ACV-938 through ACV-75: UL Listed for armored cable and flexible metal conduit.
 UL Listed: E-11853
 AC-100 through AC-400: UL Listed for flexible metal conduit.
 UL Listed flexible metal conduit fittings are suitable for use in Hazardous Locations under NEC 501-4(b) Class I Div. II, and suitable as a grounding means under NEC 350-5.



CSA Certified: 9795 and 11584.
 Armored cable and Flexible Metal Conduit

Applicable Third Party Standards:

UL Standard: 514B
 CSA Standard C22.2 No. 18
 Fed. Spec: W-F-406E
 NEMA: FB-1

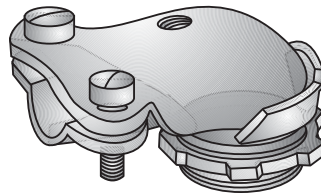

Type ACV-938

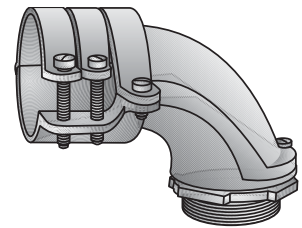

Type AC-150 — Type AC-200

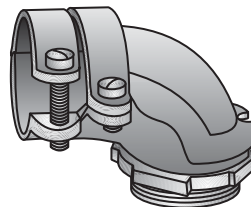

Type ACV-50 — Type AC-125

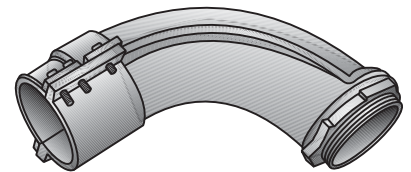

Type AC-250 — Type AC-400

| Trade Size (inches) | Catalog Number | Insulated Throat Catalog Number | Dimensions in Inches | | | |
|-------------------------------|----------------|---------------------------------|---------------------------------|---------------------------------|--------------------------------|--|
| | | | A | B | C | Flex Opening |
| 3/8 (1/2 KO) | ACV-938 | ACV-938T | 1 ⁵ / ₁₆ | 1 ³ / ₁₆ | 7/16 | 2 ³ / ₆₄ - 2 ¹ / ₃₂ |
| 1/2 | ACV-50 | ACV-50T | 1 ³ / ₄ | 1 ¹ / ₁₆ | 7/16 | 2 ⁵ / ₃₂ - 6 ¹ / ₆₄ |
| 3/4 | ACV-75 | ACV-75T | 1 ¹³ / ₁₆ | 1 ¹ / ₈ | 7/16 | 2 ⁹ / ₃₂ - 1 ¹ / ₆₄ |
| 1 | AC-100 | AC-100T | 2 ¹ / ₁₆ | 1 ⁹ / ₁₆ | 9/16 | 1 ¹ / ₄ - 1 ³ / ₈ |
| 1 ¹ / ₄ | AC-125 | AC-125T | 2 ¹³ / ₁₆ | 2 | 9/16 | 1 ¹³ / ₃₂ - 1 ⁵ / ₈ |
| 1 ¹ / ₂ | AC-150 | AC-150T | 3 ¹³ / ₁₆ | 2 ¹³ / ₁₆ | 9/16 | 1 ³ / ₄ - 2 |
| 2 | AC-200 | AC-200T | 4 ³ / ₄ | 3 ¹ / ₄ | 1 ¹ / ₁₆ | 2 ³ / ₁₆ - 2 ⁷ / ₁₆ |
| 2 ¹ / ₂ | AC-250 | AC-250T | 6 ¹ / ₄ | 4 ⁵ / ₁₆ | 7/8 | 2 ³ / ₄ - 3 |
| 3 | AC-300 | AC-300T | 7 ¹ / ₄ | 5 ⁵ / ₈ | 1 | 3 ¹ / ₄ - 3 ¹ / ₂ |
| 3 ¹ / ₂ | AC-350 | AC-350T | 10 ¹ / ₄ | 7 ³ / ₄ | 1 ¹ / ₄ | 3 ⁴⁵ / ₆₄ - 4 ⁵ / ₃₂ |
| 4 | AC-400 | AC-400T | 13 | 9 ³ / ₄ | 1 ¹ / ₄ | 4 ⁷ / ₆₄ - 4 ⁹ / ₁₆ |

