

GEARWRENCH® 1/4" Drive SAE/Metric Hex Bit Sockets

- Heat Treated Socket Bases for Durability and Serviceability
- Professional, Full Polish Chrome
- Meets or Exceeds ASME B107.1, B107.5M

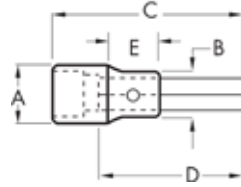

Cat. No.	UPC No.	Packaging	Fastener Size	Dim. A: Drive End	Dim. B: Nose Diameter	Dim. C: Overall Length	Dim. D: Bit Length	Exposed Bit Length	Product Weight
80151D	099575801518	Carded	1/16 in	0.508 in	0.508 in	1.530 in	0.984 in	0.655	0.05 lb
80152	099575801525	Carded	5/64 in	0.508 in	0.508 in	1.530 in	0.984 in	0.656	0.05 lb
80153	099575801532	Carded	3/32 in	0.508 in	0.508 in	1.530 in	0.984 in	0.657	0.05 lb
80154	099575801549	Carded	7/64 in	0.508 in	0.508 in	1.530 in	0.984 in	0.658	0.05 lb
80155	099575801556	Carded	1/8 in	0.508 in	0.508 in	1.530 in	0.984 in	0.659	0.05 lb
80156	099575801563	Carded	9/64 in	0.508 in	0.508 in	1.530 in	0.984 in	0.660	0.05 lb
80157	099575801570	Carded	5/32 in	0.508 in	0.508 in	1.530 in	0.984 in	0.661	0.05 lb
80158	099575801587	Carded	3/16 in	0.508 in	0.508 in	1.530 in	0.984 in	0.662	0.05 lb
80159	099575801594	Carded	7/32 in	0.508 in	0.508 in	1.530 in	0.984 in	0.663	0.05 lb
80160	099575801600	Carded	1/4 in	0.508 in	0.508 in	1.530 in	0.984 in	0.664	0.05 lb
80161	099575801617	Carded	2 mm	0.508 in	0.508 in	1.530 in	0.984 in	0.665	0.05 lb
80162	099575801624	Carded	2.5 mm	0.508 in	0.508 in	1.530 in	0.984 in	0.666	0.05 lb
80163	099575801631	Carded	3 mm	0.508 in	0.508 in	1.530 in	0.984 in	0.667	0.05 lb
80164	099575801648	Carded	4 mm	0.508 in	0.508 in	1.530 in	0.984 in	0.668	0.05 lb
80165	099575801655	Carded	5 mm	0.508 in	0.508 in	1.530 in	0.984 in	0.669	0.05 lb
80166	099575801662	Carded	6 mm	0.508 in	0.508 in	1.530 in	0.984 in	0.670	0.05 lb

GEARWRENCH® 1/4" Drive Metric Triple Square Bit Sockets

- Heat Treated Socket Bases for Durability and Serviceability
- Professional, Full Polish Chrome
- Meets or Exceeds ASME B107.5M

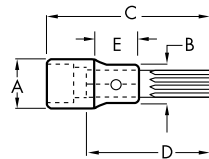

Cat. No.	UPC No.	Packaging	Fastener Size	Dim. A: Drive End	Dim. B: Nose Diameter	Dim. C: Overall Length	Dim. D: Bit Length	Exposed Bit Length	Product Weight
80167	099575801679	Carded	4 mm	0.508 in	0.508 in	1.290 in	0.748 in	0.415	0.06 lb
80168	099575801686	Carded	5 mm	0.508 in	0.508 in	1.290 in	0.748 in	0.415	0.06 lb
80169	099575801693	Carded	6 mm	0.508 in	0.508 in	1.290 in	0.748 in	0.415	0.06 lb
80170D	099575801709	Carded	8 mm	0.508 in	0.508 in	1.290 in	0.748 in	0.415	0.06 lb