

Catalog No.	Description	Catalog No.	Description
80769	1/2" Drive 12 Point Standard SAE Socket 1"	-	#2 Phillips Bit
80770	1/2" Drive 12 Point Standard SAE Socket 1-1/16"	-	#3 Phillips Bit
80771	1/2" Drive 12 Point Standard SAE Socket 1-1/8"	-	4mm Slotted Bit
80793	1/2" Drive 12 Point Standard SAE Socket 1-3/16"	-	5mm Slotted Bit
80794	1/2" Drive 12 Point Standard SAE Socket 1-1/4"	-	6mm Slotted Bit
80680	1/2" Drive 12 Point Standard SAE Socket 1-1/2"	-	T-40 Torx® Bit
80750	1/2" Drive 12 Point Standard Metric Socket 15mm	-	T-45 Torx® Bit
80751	1/2" Drive 12 Point Standard Metric Socket 16mm	-	T-50 Torx® Bit
80752	1/2" Drive 12 Point Standard Metric Socket 17mm	-	3/16" Nutdriver Bit
80753	1/2" Drive 12 Point Standard Metric Socket 18mm	-	1/4" Nutdriver Bit
80754	1/2" Drive 12 Point Standard Metric Socket 19mm	-	5/16" Nutdriver Bit
80756	1/2" Drive 12 Point Standard Metric Socket 21mm	-	11/32" Nutdriver Bit
80757	1/2" Drive 12 Point Standard Metric Socket 22mm	-	3/8" Nutdriver Bit
80759	1/2" Drive 12 Point Standard Metric Socket 24mm	-	7/16" Nutdriver Bit
80811	1/2" Drive 12 Point Standard Metric Socket 25mm	-	1/2" Nutdriver Bit
80812	1/2" Drive 12 Point Standard Metric Socket 27mm	-	5mm Nutdriver Bit
80682	1/2" Drive 12 Point Standard Metric Socket 28mm	-	6mm Nutdriver Bit
80813	1/2" Drive 12 Point Standard Metric Socket 30mm	-	7mm Nutdriver Bit
80814D	1/2" Drive 12 Point Standard Metric Socket 32mm	-	8mm Nutdriver Bit
80402	3/8" Drive Spark Plug Socket 5/8"	-	11mm Nutdriver Bit
80403	3/8" Drive Spark Plug Socket 13/16"	-	9mm Nutdriver Bit
-	#1 Phillips Bit	-	10mm Nutdriver Bit

GEARWRENCH® 1/2" Drive 6 and 12 Point Metric Standard Length Sockets

- Surface Drive® Technology Reduces Fastener Rounding
- Chamfered Opening to Guide Fastener Into Socket
- Large Hard-Stamped Size Identification
- Double Line (SAE) and Knurled (Metric) Ring to Easily Identify Standard vs. Metric Sockets
- Full Polish Chrome Finish Cleans Easily and Resists Corrosion
- Meets or Exceeds ASME B107.5M

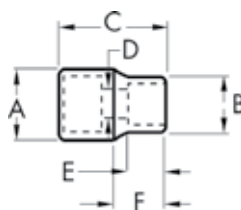

Cat. No.	UPC No.	Packaging	Drive Type	Fastener Size	Dim. A: Drive End	Dim. B: Wrench End	Dim. C: Overall Length	Dim. D: Bolt Clearance	Dim. E: Wrench Depth	Dim. F: Length to Shoulder	Product Weight
80622	099575806223	Carded	6 Point	10 mm	0.866 in	0.602 in	1.488 in	0.283 in	0.551 in	0.748 in	0.11 lb
80623	099575806230	Carded	6 Point	11 mm	0.866 in	0.650 in	1.488 in	0.354 in	0.551 in	0.748 in	0.11 lb
80624	099575806247	Carded	6 Point	12 mm	0.866 in	0.701 in	1.488 in	0.354 in	0.551 in	0.748 in	0.11 lb
80625	099575806254	Carded	6 Point	13 mm	0.866 in	0.748 in	1.488 in	0.421 in	0.551 in	0.748 in	0.12 lb
80626D	099575806261	Carded	6 Point	14 mm	0.866 in	0.799 in	1.488 in	0.421 in	0.571 in	0.748 in	0.12 lb
80627	099575806278	Carded	6 Point	15 mm	0.866 in	0.843 in	1.488 in	0.421 in	0.571 in	0.748 in	0.12 lb
80628	099575806285	Carded	6 Point	16 mm	0.866 in	0.850 in	1.488 in	0.472 in	0.571 in	0.748 in	0.13 lb
80629	099575806292	Carded	6 Point	17 mm	0.941 in	0.941 in	1.488 in	0.472 in	0.591 in	0.748 in	0.15 lb
80630	099575806308	Carded	6 Point	18 mm	0.980 in	0.980 in	1.488 in	0.472 in	0.591 in	0.748 in	0.17 lb
80631	099575806315	Carded	6 Point	19 mm	1.020 in	1.020 in	1.488 in	0.472 in	0.768 in	0.748 in	0.18 lb
80632	099575806322	Carded	6 Point	20 mm	1.094 in	1.094 in	1.488 in	0.472 in	0.768 in	0.748 in	0.18 lb
80633	099575806339	Carded	6 Point	21 mm	1.098 in	1.098 in	1.488 in	0.472 in	0.768 in	0.748 in	0.18 lb
80634	099575806346	Carded	6 Point	22 mm	1.177 in	1.177 in	1.488 in	0.472 in	0.768 in	0.748 in	0.22 lb
80635	099575806353	Carded	6 Point	23 mm	1.256 in	1.256 in	1.488 in	0.472 in	0.807 in	0.748 in	0.26 lb
80636D	099575806360	Carded	6 Point	24 mm	1.256 in	1.256 in	1.488 in	0.472 in	0.807 in	0.748 in	0.28 lb
80805	099575808050	Carded	12 Point	8 mm	0.866 in	0.524 in	1.488 in	0.283 in	0.551 in	0.748 in	0.11 lb
80806	099575808067	Carded	12 Point	9 mm	0.866 in	0.563 in	1.488 in	0.283 in	0.551 in	0.748 in	0.11 lb
80745	099575807459	Carded	12 Point	10 mm	0.866 in	0.602 in	1.488 in	0.283 in	0.551 in	0.748 in	0.11 lb
80746	099575807466	Carded	12 Point	11 mm	0.866 in	0.650 in	1.488 in	0.354 in	0.551 in	0.748 in	0.11 lb
80747	099575807473	Carded	12 Point	12 mm	0.866 in	0.701 in	1.488 in	0.354 in	0.551 in	0.748 in	0.12 lb
80748D	099575807480	Carded	12 Point	13 mm	0.866 in	0.748 in	1.488 in	0.421 in	0.551 in	0.748 in	0.13 lb
80749	099575807497	Carded	12 Point	14 mm	0.866 in	0.799 in	1.488 in	0.421 in	0.571 in	0.748 in	0.13 lb
80750	099575807503	Carded	12 Point	15 mm	0.866 in	0.843 in	1.488 in	0.421 in	0.571 in	0.748 in	0.13 lb
80751	099575807510	Carded	12 Point	16 mm	0.866 in	0.850 in	1.488 in	0.472 in	0.571 in	0.748 in	0.16 lb
80752	099575807527	Carded	12 Point	17 mm	0.941 in	0.941 in	1.488 in	0.472 in	0.591 in	0.748 in	0.17 lb
80753	099575807534	Carded	12 Point	18 mm	0.980 in	0.980 in	1.488 in	0.472 in	0.591 in	0.748 in	0.18 lb
80754	099575807541	Carded	12 Point	19 mm	1.020 in	1.020 in	1.488 in	0.472 in	0.768 in	0.748 in	0.20 lb
80755D	099575807558	Carded	12 Point	20 mm	1.094 in	1.094 in	1.488 in	0.472 in	0.768 in	0.748 in	0.20 lb
80756	099575807565	Carded	12 Point	21 mm	1.098 in	1.098 in	1.488 in	0.472 in	0.768 in	0.748 in	0.22 lb
80757	099575807572	Carded	12 Point	22 mm	1.177 in	1.177 in	1.488 in	0.472 in	0.768 in	0.748 in	0.26 lb
80758	099575807589	Carded	12 Point	23 mm	1.256 in	1.256 in	1.488 in	0.472 in	0.807 in	0.748 in	0.28 lb
80759	099575807596	Carded	12 Point	24 mm	1.256 in	1.256 in	1.488 in	0.472 in	0.807 in	0.748 in	0.28 lb
80811	099575808111	Carded	12 Point	25 mm	1.262 in	1.309 in	1.488 in	0.453 in	0.807 in	0.748 in	0.30 lb
80681	099575806810	Carded	12 Point	26 mm	1.287 in	1.335 in	1.575 in	0.453 in	0.886 in	1.496 in	0.33 lb
80812	099575808128	Carded	12 Point	27 mm	1.366 in	1.413 in	1.575 in	0.453 in	0.886 in	0.748 in	0.33 lb
80682	099575806827	Carded	12 Point	28 mm	1.433 in	1.480 in	1.575 in	0.453 in	0.886 in	1.496 in	0.35 lb

Cat. No.	UPC No.	Packaging	Drive Type	Fastener Size	Dim. A: Drive End	Dim. B: Wrench End	Dim. C: Overall Length	Dim. D: Bolt Clearance	Dim. E: Wrench Depth	Dim. F: Length to Shoulder	Product Weight
80683	099575806834	Carded	12 Point	29 mm	1.445 in	1.492 in	1.575 in	0.453 in	0.886 in	1.496 in	0.35 lb
80813	099575808135	Carded	12 Point	30 mm	1.524 in	1.571 in	1.654 in	0.453 in	0.965 in	0.748 in	0.35 lb
80814D	099575808142	Carded	12 Point	32 mm	1.602 in	1.650 in	1.654 in	0.453 in	0.965 in	0.748 in	0.37 lb
80815D	099575808159	Carded	12 Point	36 mm	1.921 in	1.969 in	1.969 in	0.453 in	1.102 in	0.748 in	0.39 lb

GEARWRENCH® 1/2" Drive 6 and 12 Point SAE Deep Length Sockets

- Surface Drive® Technology Reduces Fastener Rounding
- Chamfered Opening to Guide Fastener Into Socket
- Large Hard-Stamped Size Identification
- Double Line (SAE) and Knurled (Metric) Ring to Easily Identify Standard vs. Metric Sockets
- Full Polish Chrome Finish Cleans Easily and Resists Corrosion
- Meets or Exceeds ASME B107.1

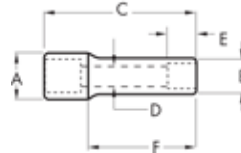

Cat. No.	UPC No.	Packaging	Drive Type	Fastener Size	Dim. A: Drive End	Dim. B: Wrench End	Dim. C: Overall Length	Dim. D: Bolt Clearance	Dim. E: Wrench Depth	Dim. F: Length to Shoulder	Product Weight
80684	099575806841	Carded	6 Point	7/16 in	0.866 in	0.669 in	3.031 in	0.394 in	0.000 in	1.496 in	0.22 lb
80614	099575806148	Carded	6 Point	1/2 in	0.866 in	0.732 in	3.031 in	0.453 in	0.287 in	1.496 in	0.24 lb
80615	099575806155	Carded	6 Point	9/16 in	0.866 in	0.811 in	3.031 in	0.453 in	0.350 in	1.496 in	0.27 lb
80616	099575806162	Carded	6 Point	5/8 in	0.866 in	0.850 in	3.031 in	0.453 in	0.398 in	1.496 in	0.27 lb
80617	099575806179	Carded	6 Point	11/16 in	0.937 in	0.937 in	3.031 in	0.453 in	0.398 in	1.496 in	0.31 lb
80618	099575806186	Carded	6 Point	3/4 in	1.016 in	1.016 in	3.031 in	0.453 in	0.457 in	1.496 in	0.38 lb
80619	099575806193	Carded	6 Point	13/16 in	1.094 in	1.094 in	3.031 in	0.453 in	0.480 in	1.496 in	0.42 lb
80620	099575806209	Carded	6 Point	7/8 in	1.173 in	1.173 in	3.031 in	0.453 in	0.520 in	1.496 in	0.51 lb
80621	099575806216	Carded	6 Point	15/16 in	1.252 in	1.252 in	3.031 in	0.453 in	0.567 in	1.496 in	0.57 lb
80674	099575806742	Carded	6 Point	1 in	1.283 in	1.331 in	3.031 in	0.453 in	0.457 in	1.496 in	0.80 lb
80675	099575806759	Carded	6 Point	1-1/16 in	1.362 in	1.409 in	3.031 in	0.453 in	0.457 in	1.496 in	0.90 lb
80676	099575806766	Carded	6 Point	1-1/8 in	1.441 in	1.488 in	3.031 in	0.453 in	0.457 in	1.496 in	0.99 lb
80685	099575806858	Carded	6 Point	1-1/4 in	1.598 in	1.646 in	3.031 in	0.453 in	0.000 in	0.000 in	1.15 lb
80686	099575806865	Carded	6 Point	1-1/2 in	1.913 in	1.961 in	1.969 in	0.000 in	1.220 in	0.000 in	1.37 lb
80772	099575807725	Carded	12 Point	7/16 in	0.870 in	0.670 in	3.030 in	0.390 in	0.240 in	1.500 in	0.22 lb
80773	099575807732	Carded	12 Point	1/2 in	0.866 in	0.732 in	3.031 in	0.453 in	0.287 in	1.496 in	0.24 lb
80774	099575807749	Carded	12 Point	9/16 in	0.866 in	0.811 in	3.031 in	0.453 in	0.350 in	1.496 in	0.27 lb
80775	099575807756	Carded	12 Point	5/8 in	0.866 in	0.850 in	3.031 in	0.453 in	0.398 in	1.496 in	0.27 lb
80776	099575807763	Carded	12 Point	11/16 in	0.937 in	0.937 in	3.031 in	0.453 in	0.398 in	1.496 in	0.31 lb
80777D	099575807770	Carded	12 Point	3/4 in	1.016 in	1.016 in	3.031 in	0.453 in	0.457 in	1.496 in	0.38 lb
80778	099575807787	Carded	12 Point	13/16 in	1.094 in	1.094 in	3.031 in	0.453 in	0.480 in	1.496 in	0.42 lb
80779	099575807794	Carded	12 Point	7/8 in	1.173 in	1.173 in	3.031 in	0.453 in	0.520 in	1.496 in	0.51 lb
80780	099575807800	Carded	12 Point	15/16 in	1.252 in	1.252 in	3.031 in	0.453 in	0.567 in	1.496 in	0.57 lb
80795	099575807954	Carded	12 Point	1 in	1.283 in	1.331 in	3.031 in	0.453 in	0.642 in	1.496 in	0.80 lb
80796	099575807961	Carded	12 Point	1-1/16 in	1.362 in	1.409 in	3.031 in	0.453 in	0.677 in	1.496 in	0.90 lb
80797	099575807978	Carded	12 Point	1-1/8 in	1.441 in	1.488 in	3.031 in	0.453 in	0.772 in	1.496 in	0.99 lb
80798	099575807985	Carded	12 Point	1-1/4 in	1.598 in	1.646 in	3.031 in	0.453 in	0.870 in	1.496 in	1.15 lb
80687	099575806872	Carded	12 Point	1-1/2 in	1.598 in	1.646 in	3.031 in	0.453 in	0.870 in	1.496 in	1.37 lb