

GEARWRENCH® 3/4" Drive Impact Drive Adapters

- Chrome Molybdenum Alloy Steel (Cr-Mo) for Exceptional Strength and Long Lasting Durability
- High Visibility Laser Etched Markings
- Meets or Exceeds ASME B107.1



Cat. No.	UPC No.	Packaging	Female Drive Size	Male Drive Size	Dim. A: Drive End	Length	Product Weight
84888D	099575848889	Carded	3/4"	1/2"	1.5 in	2.126 in	0.83 lb
84887	099575848872	Carded	3/4"	1"	1.5 in	2.626 in	1.30 lb

GEARWRENCH® 3/4" Drive 6 Point SAE Impact Sockets

- Chrome Molybdenum Alloy Steel (Cr-Mo) for Exceptional Strength and Durability
- Surface Drive™ Technology Reduces Fastener Rounding
- Manganese Phosphate Coating to Resist Corrosion
- High Visibility Laser Etched Markings
- Secondary Hard Stamping
- Meets or Exceeds ASME B107.2

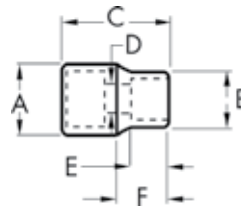

Cat. No.	UPC No.	Packaging	Fastener Size	Dim. A: Drive End	Dim. B: Wrench End	Dim. C: Overall Length	Dim. D: Bolt Clearance	Dim. E: Wrench Depth	Dim. F: Length to Shoulder	Product Weight
84800	099575848001	Carded	3/4 in	1.654 in	1.260 in	2.008 in	0.531 in	0.356 in	0.905 in	0.69 lb
84801	099575848018	Carded	13/16 in	1.654 in	1.378 in	2.008 in	0.594 in	0.418 in	0.905 in	0.71 lb
84802	099575848025	Carded	7/8 in	1.654 in	1.417 in	2.008 in	0.594 in	0.479 in	0.905 in	0.73 lb
84803	099575848032	Carded	15/16 in	1.654 in	1.496 in	2.008 in	0.656 in	0.490 in	0.905 in	0.75 lb
84804	099575848049	Carded	1 in	1.654 in	1.575 in	2.087 in	0.656 in	0.490 in	0.905 in	0.80 lb
84805	099575848056	Carded	1-1/16 in	1.732 in	1.654 in	2.087 in	0.687 in	0.490 in	0.905 in	0.89 lb
84806	099575848063	Carded	1-1/8 in	1.732 in	1.732 in	2.087 in	0.781 in	0.632 in	2.086 in	0.84 lb
84808	099575848087	Carded	1-1/4 in	1.732 in	1.890 in	2.244 in	0.812 in	0.632 in	2.244 in	1.03 lb
84809	099575848094	Carded	1-5/16 in	1.732 in	1.968 in	2.244 in	0.937 in	0.740 in	2.244 in	1.04 lb
84810	099575848100	Carded	1-3/8 in	1.732 in	2.047 in	2.244 in	0.937 in	0.740 in	2.244 in	1.13 lb
84811	099575848117	Carded	1-7/16 in	1.732 in	2.087 in	2.244 in	1.000 in	0.740 in	2.244 in	1.16 lb
84812	099575848124	Carded	1-1/2 in	1.732 in	2.205 in	2.244 in	1.062 in	0.847 in	2.244 in	1.21 lb
84813	099575848131	Carded	1-9/16 in	1.732 in	2.283 in	2.283 in	1.062 in	0.847 in	2.283 in	1.25 lb
84814	099575848148	Carded	1-5/8 in	1.732 in	2.362 in	2.283 in	1.125 in	0.847 in	2.283 in	1.31 lb
84815	099575848155	Carded	1-11/16 in	1.732 in	2.441 in	2.441 in	1.187 in	0.970 in	2.440 in	1.50 lb
84816	099575848162	Carded	1-3/4 in	1.732 in	2.520 in	2.441 in	1.187 in	0.980 in	2.440 in	1.59 lb
84807	099575848070	Carded	1-13/16 in	1.732 in	1.811 in	2.087 in	1.250 in	0.990 in	2.440 in	1.73 lb
84818	099575848186	Carded	1-7/8 in	1.732 in	2.598 in	2.677 in	1.312 in	1.062 in	2.677 in	1.80 lb
84819	099575848193	Carded	1-15/16 in	1.732 in	2.756 in	2.677 in	1.312 in	1.062 in	2.677 in	1.85 lb
84820	099575848209	Carded	2 in	1.732 in	2.795 in	2.677 in	1.375 in	1.062 in	2.677 in	1.90 lb
84821	099575848216	Carded	2-1/16 in	2.126 in	2.874 in	2.795 in	1.437 in	1.150 in	2.795 in	2.30 lb
84822	099575848223	Carded	2-1/8 in	2.126 in	2.953 in	2.795 in	1.437 in	1.150 in	2.795 in	2.55 lb
84823	099575848230	Carded	2-3/16 in	2.126 in	3.031 in	2.795 in	1.50 in	1.193 in	2.795 in	2.55 lb
84824	099575848247	Carded	2-1/4 in	2.126 in	3.150 in	2.874 in	1.562 in	1.276 in	2.874 in	2.75 lb
84825	099575848254	Carded	2-5/16 in	2.126 in	3.150 in	2.874 in	1.562 in	1.276 in	2.874 in	2.79 lb
84826	099575848261	Carded	2-3/8 in	2.126 in	3.268 in	2.874 in	1.562 in	1.303 in	2.952 in	2.83 lb
84827	099575848278	Carded	2-7/16 in	2.126 in	3.268 in	2.874 in	1.562 in	1.303 in	2.952 in	2.93 lb
84828	099575848285	Carded	2-1/2 in	2.126 in	3.268 in	2.874 in	1.562 in	1.303 in	2.952 in	3.13 lb

3 / 4 "

4

IMPACT SOCKETS